

2005 | SCEPTER®

*This is Living*®

 HOLIDAY RAMBLER®

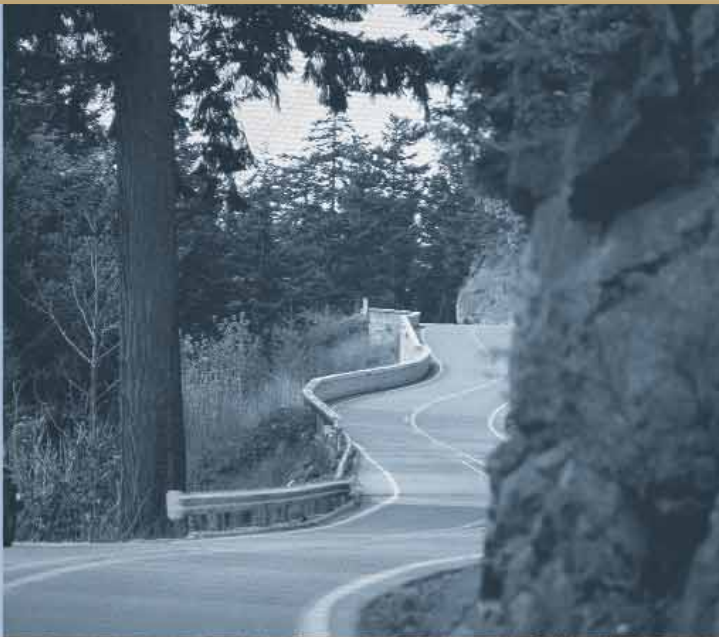





{ *This is Living*® }

Fifty-one years. It's a proud reminder of our many accomplishments. After all, we were there from the start of an industry, and innovation by innovation we've led the way toward creating a rich and wonderful RV lifestyle.

Maybe it's not until you own a Holiday Rambler that you can truly feel the strength of our heritage. You'll feel it in the peace of mind you'll have knowing your family's in the safest RV on the road. You'll feel it in the quality of your experiences, thanks to the hundreds of conveniences we've developed. And you'll feel it when you realize you're free to roam throughout North America with confidence, knowing our network of support is with you every mile of the way.



So join us as we look forward to a new model year. For 2005, we're celebrating an exciting new lineup, full of more groundbreaking products and high-tech advances than ever.



## 2005 SCEPTER

---

MORE POWER TO YOU.

There are times in your life that beg you to take a big, bold step. Just like the 2005 Scepter has. This year, our popular luxury diesel coach hits the road with new sophisticated, sports car-inspired styling — to match its powerful new Cummins® ISL 400 engine. All designed to reflect your love of freedom, adventure and the challenge of the open road.



Holiday Rambler®

1954 - 2005





{ IT'S ALL ABOUT CREATING A HOME. }

Set foot inside the 2005 Scepter, and you'll see that it's nothing short of a home. And as you take a closer look, you'll appreciate the many details that bring it all together. Like beautiful solid wood cabinet doors with stylish satin nickel hardware. Decorative hardwood slide-out fascia and crown molding. And plush designer carpeting paired with sleek ceramic tile or optional laminated plank flooring.

In the dining area, you'll find an adjustable legless solid surface table with two dinette chairs and two folding chairs. Plus, we've added a computer hook-up with phone jack to make the space more useful.

The Scepter also features impeccable furnishings, with a long list of standard and optional selections, depending on the floorplan. One highlight is the exquisite Ultraleather™ Euro-recliner with ottoman, shown here. And below, the optional hide-a-bed sofa with air mattress (available on select models) makes your living area more versatile, allowing you to conveniently accommodate family and guests.

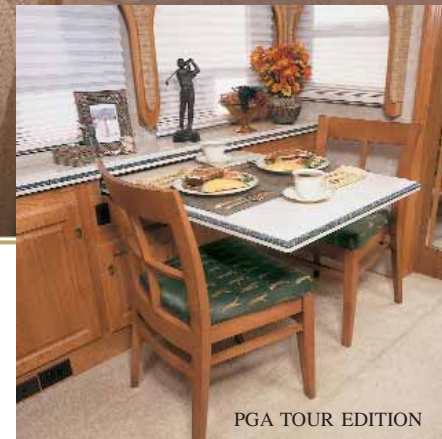

PGA TOUR EDITION





REGATTA DECOR WITH NATURAL CHERRY WOOD

38PDQ





PGA TOUR EDITION DECOR WITH NATURAL CHERRY WOOD

40PAQ





{ THE MARRIAGE OF  
LUXURY AND ADVENTURE. }

Welcome to a motorcoach that's as sporty and fun loving as you are. Above the cockpit, you'll find the Scepter's impressive entertainment center, featuring a 24" CRT flatscreen TV (or an optional 32" flatscreen LCD TV) that's wired through the ceiling speakers for superior sound quality. You can customize the package with some exciting options, including a home theater system with VCR/DVD player and a fully automatic digital satellite system.

In the kitchen, you're greeted by the contemporary styling of the new polished radius solid surface countertop and backsplash with beveled mirrors. The appliances are also state-of-the-art and include a recessed high-output cooktop, a stainless steel convection microwave and a double-door refrigerator with raised panel doors. The pullout countertop extension, shown here, gives you added workspace (not available on 40PBT), while a roll-out pantry gives you impressive storage space. The overhead cabinets feature an adjustable shelf, and we've added built-in storage for the sink and stove covers and a wastebasket.







{ RETREAT. RELAX. RECHARGE. }

The Scepter's warm and cozy bedroom is the perfect place to unwind from the day and rest up for tomorrow. Its highlight is a queen bed with an impressive hardwood headboard and beautiful fabric inserts. And for your comfort, side windows in the slide-out (on most models) offer excellent cross ventilation. Two nightstands with solid surface tops come standard, or you may choose the optional king bed with one nightstand. Storage space is plentiful, with top-hinged overhead cabinet doors that open easily and stay open with struts. And you'll enjoy the roomy oversized rear wardrobe closet with mirrored doors and satin nickel frame.

In the bathroom, you'll love the attractive polished solid surface countertop with integrated sink and single-handle faucet, shown above right. Here, you can also see the stylish hardwood valances with fabric accents, located throughout the coach. Below, you see the residential-style solid wood raised panel bathroom door, as well as the decorative glass shower door with convenient towel bars.



REGATTA DECOR WITH NATURAL CHERRY WOOD

38PDQ





BLACK WATCH DECOR WITH STAINED OAK WOOD

38PDQ









{ HIGHLIGHTS OF COMFORT  
AND CONVENIENCE. }

The 2005 Scepter is a remarkable combination of innovative designs, state-of-the-art engineering, and forward-thinking features. In the cockpit, you'll find the Aladdin™ video coach monitoring system to help you track many of the coach's vital functions as well as your trip information. The attractive dash is well organized, with many of the controls located on the lighted VIP Smartwheel®. You'll also love the plush, durable Ultraleather™ cockpit seats — with six-way power controls on the pilot seat and optional six-way power controls and a power footrest on the co-pilot seat.

Other features shown here include the centralized tank monitoring panel and the insulated systems compartment along with the battery slide-out tray. The newly styled front cap features a one-piece windshield for an unobstructed view, as well as new headlamps and fog lights and a one-piece generator access door with a power slide-out for easier servicing. Another Holiday Rambler advantage is the quality of our slide-out construction — featuring the same multi-layer insulation as the sidewalls to prevent warping and shifting.





**WETBAY WITH OPTIONAL RV SANI-CON:**  
 The new RV Sani-Con system makes it easier and cleaner than ever before to flush the coach's holding tank.



**TRUSS SYSTEM WITH RUST INHIBITOR:**  
 This steel truss system is engineered as part of the chassis and provides outstanding strength and rigidity plus pass-through storage. In addition, the structure is pre-primed and coated with a rust inhibiting paint.



**CUMMINS® ISL 400 DIESEL ENGINE:**  
 You'll enjoy the peerless performance of the Cummins® ISL 400 electronic engine and the Allison® 3000 MH 6-speed World Transmission with electronic shifter. This powertrain offers 1,200 lbs./ft. torque for maximum uphill performance. In addition, our exclusive use of synthetic transmission fluid allows for up to three-year maintenance intervals for the transmission.



ROADMASTER RR8S-SERIES CHASSIS

**ROOF CONSTRUCTION: (top to bottom)**

- 1/4" seamless one-piece crowned fiberglass roof
- Vapor barrier
- Luaun backing
- Structure foam: thermal insulative barrier
- 2 1/2" thick, tapered bead foam insulation
- 1/2" bead foam insulation
- 1 1/2" x 3" aluminum I-beam superstructure on 16" centers is filled with 3" fiberglass insulation
- Foam padding for extra insulation
- Padded vinyl ceiling

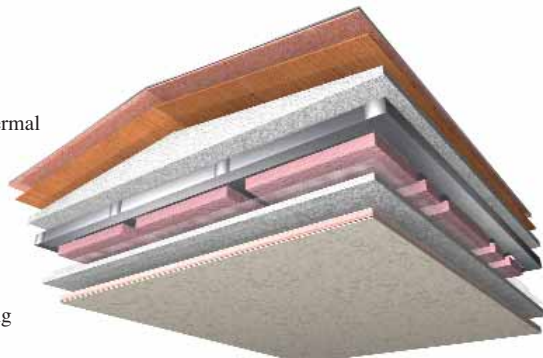

**SIDEWALL CONSTRUCTION: (left to right)**

- High-gloss gel coat fiberglass
- 1 1/2" thick Dow Structure Foam® insulation
- 1 1/2" x 1 1/2" square tubular aluminum frame
- 1/8" luaun
- Wallpaper



**ENGINE MOUNTING:**

The three-point engine mounting system lowers the coach's center of gravity and reduces the amount of vibration that reaches the coach. The mounting also makes the engine easier to service by allowing the engine to be easily lowered through the bottom of the coach.

**AIR BAGS AND SHOCKS:**

The cushion air glide suspension system with eight outboard mounted air bags and eight gas shock absorbers combine with ride height sensors (two in rear, one in front) to deliver better ride and handling.



**Roadmaster**  
Chassis

The Roadmaster RR8S-Series chassis was designed specifically for Holiday Rambler's luxury coaches like the Scepter, and it leads its class in sophisticated features that combine to provide a smooth ride and superior front-to-rear balance.

- Eight outboard mounted air bags work in conjunction with gas powered shock absorbers to prevent road trauma from ever reaching the coach.
- Three monitored leveling sensors (two in the rear, one in the front) continually adjust the air pressure within each air bag to maintain a level ride and eliminate nosediving, weight transfer and floating on curved roads. This system also stabilizes the coach side to side on uneven roads and while maneuvering through curves.
- A 10,000 lb. tow hitch rating is the highest in its class.
- Our exclusive raised rail design provides for larger full pass-through storage bays with flush floors.
- Frame rails are constructed of 3" by 8" by 3/8" 60,000 PSI steel for greater strength; a side-mounted aluminum radiator and intercooler reduce weight, won't rust, and deliver better heat transfer than steel cooling components.
- The power steering box allows for a 50-degree front wheel turn angle in both directions for better maneuverability and returns the steering wheel back to its center position to eliminate driver fatigue.
- Equipped with a steel firewall for added safety.

**FLOOR CONSTRUCTION:**  
(top to bottom)

- Carpet pad and carpeting or tile
- 5/8" Structurwood™
- 1 1/2" Dow Structure Foam® insulation
- 1 1/2" x 1 1/2" square tubular steel frame
- 1/8" luaun
- Waterproof Darco underbelly

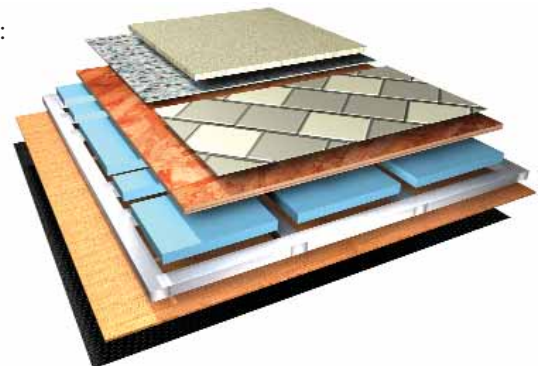





CELEBRATING THE FREEDOM OF CHOICE.

At Holiday Rambler, we're dedicated to giving you more ways to create the coach of your dreams. That's why the Scepter features a wide selection of exciting triple and quad slide-out floorplans, with numerous furniture options to fit your lifestyle. In addition, our designers have created exquisite color and fabric combinations to give you the most beautiful interiors you'll find anywhere. Add to that the woodwork of your choice, and you'll have a luxury motorcoach you can truly call home.

A	B
	C
	D

- A Sofa
- B Accent
- C Bedspread
- D Carpet



BELLAGIO



BLACK WATCH





BREAKERS

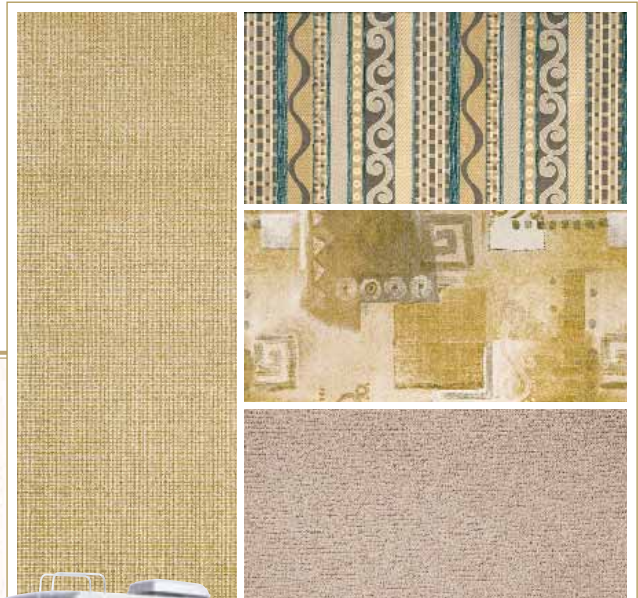

REGATTA

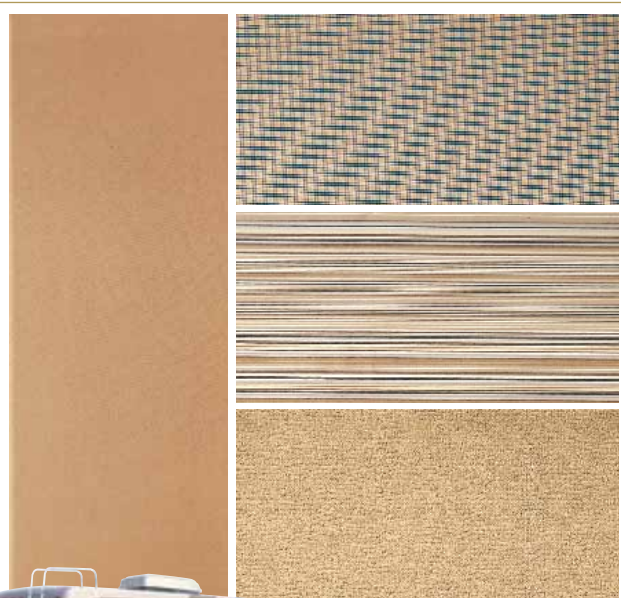

BLACKWOOD MANOR  
featuring fabrics from Liz Claiborne



**BETTER STAIN PROTECTION** Manufactured in, not added on. For added protection against stains, Dupont Teflon® soil repellent is applied to virtually all upholstery fabric during the finishing process for superior coverage.\*

\*Brand and application of upholstery fabric protection may vary depending on date recreational vehicle was manufactured.



Natural Oak



Stained Oak



Natural Cherry



Stained Cherry



Natural Maple



Walnut





PGA TOUR  
EDITION

SCEPTER

# HOLIDAY RAMBLER: THE MOTORHOME OF CHOICE FOR PGA TOUR PROFESSIONALS.

Introducing the 2005 PGA TOUR Edition. This new special edition Scepter model features a unique paint color and PGA TOUR edition logos on the exterior. Inside the coach, you'll find many distinctive touches — including one-of-a-kind fabrics and logo overlay on the glass shower door. So this year, see for yourself why PGA TOUR professionals who own motorhomes choose Holiday Rambler.

A	B
	C
	D

- A Sofa
- B Accent
- C Bedspread
- D Carpet



PGA TOUR EDITION





**BODY CONSTRUCTION****STANDARD FEATURES**

- Aluminum Superstructure
- Seamless One-Piece Molded Crowned Fiberglass Roof
- All-Season Foam Insulated Roof
- Laminated Smooth Gel Coat Fiberglass Exterior Walls
- Front Molded Fiberglass Cap
- Rear Molded Fiberglass Cap with Integrated Air Intake
- One-Piece Windshield
- One-Piece Generator Access Door
- Power Slide-Out Generator Tray
- Rear Engine Doors Struts
- Angled Fiberglass Engine Cover
- Electric Flush Mount Stepwell Cover
- Laminated Steel Framed Flooring with 1-1/2" Foam Insulation and 5/8" Structurwood™
- Dual Head Power Controlled Heated Exterior Mirrors with Turn Indicator Lights
- Headlamp with Turn Signals
- Fog Lights
- Docking Lights
- Pilot and Co-Pilot Cup Holders
- Flush Mount Metal Fuel Doors
- Ozite Lined Pass-Through Storage Compartments
- Wheel Mud Flaps
- Deluxe Full-Body Paint
- Interior Entry Step Storage
- Roof Ladder
- Undercoating

**OPTIONS**

- 3M® Film Front Mask
- Full-Length Holiday Rambler Mud Flap
- Storage Bay Slide-Out Tray – One Side
- Storage Bay Slide-Out Tray – Pass-Through
- Exterior Sunscreens
- Taller Dual Head Power Controlled Heated Mirrors with Turn Indicator Lights

**CHASSIS/ENGINE/SUSPENSION****STANDARD FEATURES**

- Roadmaster RR8S-Series Chassis
- Cummins® ISL 400 Electronic Engine with Allison® 3000 MH 6-Speed World Transmission and Electronic Shifter
- Aluminum Side Mount Radiator with CAC Cooler
- Engine Displacement: 8.9L/540.5 Cu. In.
- Torque: 1,200 lbs./ft. Max. Net at 1,300 RPM
- Dual Fuel Fill
- 160 Amp Alternator
- Rear Axle Ratio: 4.30:1
- Goodyear Radial Tires 295/80R/22.5G670RV
- Stainless Steel Wheel Simulators
- Cushion Air Glide Suspension with Eight Outboard Mounted Air Bags and Eight Monroe® Shock Absorbers
- Anti-Lock Braking System with Front Disc Brakes and Rear Drum Brakes

- Automatic Traction Control
- PAC Exhaust Brake
- Auto Slack Adjusters on Brakes
- Transmission Temperature Gauge
- Air Cleaner Restriction Indicator
- Fuel and Water Separator
- Remote Transmission Fill
- Engine Block Heater
- Manual Hydraulic Leveling System
- 10,000 Lb. Hitch Receiver with Seven Point Connector

**OPTIONS**

- Polished Aluminum Wheels
- Air Leveling System

**COCKPIT****STANDARD FEATURES**

- Automotive Dash with Charcoal Metallic and Silver Graphite Metallic Instrumentation Panel
- Black Gauges with White Lettering and Chrome Bezels
- Color Rear Vision System with Audio
- Aladdin™ Video Coach System
- Dash 12V Chassis Battery Gauge
- In-Dash AM/FM CD Player with Six Speakers
- CB Prep with Antenna
- Power Sunvisors
- Adjustable Brake and Accelerator Pedals
- 110V, 12V and Phone Outlet
- Lighted VIP Smartwheel® with Controls for Windshield Wipers, ICC and Cruise Control
- Intermittent Windshield Wipers
- Audible Turn Signals
- Low Coolant Warning Light and Buzzer
- Power Steering
- Cruise Control Light on Dash
- Roof-Mounted Dual Trumpet Air Horns
- Pilot Seat with 6-Way Power
- Ultraleather™ Pilot and Co-Pilot Seats
- Carpet Driver and Passenger Floor Mats
- Privacy Curtain

**OPTIONS**

- Ultraleather™ Six-Way Power Co-Pilot Seat
- Ultraleather™ Six-Way Power Co-Pilot Seat with Power Footrest
- Ultraleather™ Extra Wide Six-Way Power Co-Pilot Seat with Power Footrest
- CB Radio
- 10 Disc CD Changer
- OnStar® Mobile Assistance
- Dash Fans
- Pilot and Co-Pilot Pull-Down Sunscreens

**APPLIANCES AND ACCESSORIES****STANDARD FEATURES**

- Double-Door Refrigerator with Raised Panel Doors

continued





- Recessed High-Output Cooktop with Two Burners and Flush Mount Covers
- Stainless Steel Spacesaver Convection Microwave with Touch Control
- 24" CRT Flatscreen Color Stereo TV with Remote Control in Living Area
- Living Area Stereo TV Wired Through Ceiling Speakers
- 20" CRT Flatscreen Color Stereo TV with Remote in Bedroom Area
- TV Antenna with Video Switching Box and Booster
- Exterior Hook-Ups for DSS Dish and Cable
- Digital Satellite System Prep
- Cable TV Hook-Up and Telephone Jacks
- Washer/Dryer Prep

**OPTIONS**

- Norcold® Wraparound Stainless Steel 12 Cu. Ft., 2-Way, 4-Door Refrigerator with Ice Maker
- High-Output Three-Burner Range with Oven
- Combination Washer/Dryer
- 32" Flatscreen LCD TV in Living Area
- 26" Flatscreen LCD TV in Living Area
- Home Theater System with DVD/VCR Player
- DVD Player in Living Area
- Stereo VCR in Living Area (N/A with Home Theater Option)
- Fully Automatic Digital Satellite System

**INTERIOR****STANDARD FEATURES**

- Stained or Natural Oak Cabinetry
- Solid Wood Raised Panel Cabinet Doors
- Refrigerator Raised Panel Hardwood Inserts
- Hardwood Veneer Paneling
- Crown Molding in Bedroom and Living Area
- Lined Cabinet Shelves
- Heavy-Duty Roller Ball Bearing Drawer Guides
- Top-Hinged Overhead Storage Doors with Strut and Positive Catches on All Other Doors
- Satin Nickel Cabinetry Hardware and Bath Accessories
- Decorative Wallboard Throughout
- Radius Polished Solid Surface Kitchen Countertop with Stainless Steel Sink with Two Sink Covers
- Pullout Solid Surface Kitchen Countertop Extension (N/A: 40PBT)
- Tip-Out Tray under Kitchen Sink
- Solid Surface Backsplash with Beveled Mirrors in Kitchen
- Wastebasket Storage (N/A: 40PST)
- Roll-Out Pantry in Kitchen Base Cabinet
- Polished Solid Surface Bathroom Countertop with Integrated Sink
- Kitchen Overhead Cabinets with Adjustable Shelf
- Roll-Out Pantry next to Two-Door Refrigerator (N/A with Four-Door Option)
- Sink and Stove Top Cover Storage Area inside Kitchen Base Cabinet
- Ceramic Tile Flooring in Kitchen and Bathroom
- Designer Carpeting in Living Area and Bedroom
- Engine Rug Cover
- Tile Flooring in Front of Washer/Dryer Area
- Soft Touch Padded Vinyl Ceiling
- Hardwood Slide-Out Fascia with Fluted Accents
- Hardwood Valances with Fabric Accents Throughout
- Solid Wood Raised Panel Bathroom Door
- Wallpaper Border in Private Lavatory

- Medicine Cabinet with One Fixed Shelf
- Bathroom Lavatory Mirror
- Towel Bar in Bathroom
- Two Towel Rings in Bathroom
- Oversized Rear Wardrobe Closet with Satin Nickel Mirrored Door Frames
- Hardwood Headboard with Fabric Panel Inserts
- Bedroom Dresser with Solid Surface Countertop and Integrated Hamper
- Bedspread, Pillow Shams and Decorative Pillows
- Day/Night Pleated Blackout Shades in Living Area and Bedroom
- Mini Blinds in Bathroom
- Soil Repellant on Fabric, Teflon® Fabric Protection

**OPTIONS**

- Decors: Black Watch, Regatta, Breakers, Bellagio, Blackwood Manor Featuring Fabrics by Liz Claiborne, PGA TOUR Edition
- Wood Choice: Walnut, Stained Cherry, Natural Cherry, Natural Maple
- Solid Surface Kitchen Sink
- Entry Floor to Match Kitchen
- Laminated Plank Flooring in Kitchen and Bath

**FURNITURE****STANDARD FEATURES**

- Legless Solid Surface Dinette Table with Two Dinette Chairs and Two Folding Chairs
- Roadside Furniture: DE Sleeper Sofa (N/A: 38PDQ, 40PRQ)
- Roadside Furniture: Ultraleather™ Euro-Recliner with Ottoman (38PDQ, 40PRQ)
- Curbside Furniture: DE Sleeper Sofa (N/A: 40PAQ, 40PBT)
- Curbside Furniture: Ultraleather™ Euro-Recliner with Ottoman (40PAQ, 40PBT)
- Queen Bed (60"x 80") with Polished Solid Surface Nightstands

**OPTIONS**

- King Bed (72" x 80") with One Nightstand
- Roadside Furniture: Fabric Hide-A-Bed Sofa with Air Mattress (N/A: 38PDQ, 40PRQ)
- Roadside Furniture: Ultraleather™ Hide-A-Bed Sofa with Air Mattress (N/A: 38PDQ, 40PRQ)
- Roadside Furniture: Ultraleather™ Magic Sofa with Drawer (N/A: 38PDQ, 40PRQ)
- Roadside Furniture: Fabric Electric Sofa (N/A: 38PDQ, 40PRO, 40PAQ)
- Roadside Furniture: Ultraleather™ DE Sofa (N/A: 38PDQ, 40PRO)
- Roadside Furniture: Ultraleather™ Sleeper Sofa (N/A: 38PDQ, 40PRQ)
- Roadside Furniture: Wraparound Computer Table with Ultraleather™ Euro-Recliner with Ottoman (40PST, 40PDQ)
- Curbside Furniture: Wraparound Computer Table with Ultraleather™ Euro-Recliner with Ottoman (40PAQ)
- Curbside Furniture: Fabric Hide-A-Bed Sofa with Air Mattress (40PBT, 40PAQ, 40PRQ)
- Curbside Furniture: Ultraleather™ Hide-A-Bed Sofa with Air Mattress (40PBT, 40PAQ)
- Curbside Furniture: Ultraleather™ Magic Bed with Drawer (N/A: 40PBT, 40PAQ)
- Curbside Furniture: Ultraleather™ DE Sofa (N/A: 40PBT, 40PAQ)
- Curbside Furniture: Fabric Electric Sofa (N/A: 40PBT, 40PAQ)
- Curbside Furniture: Ultraleather™ J-Lounge with Drawer





- Pillow Top Mattress
- Booth Dinette

## ELECTRICAL SYSTEMS AND LIGHTS

### STANDARD FEATURES

- 50 Amp 120V Distribution Panel and Power Cord with Quick Disconnect
- Onan® 8.0 kW Quiet Diesel Generator on Power Slide-Out with Auxiliary Start Switch
- Slide-Out Battery Tray
- Four 6V Deep Cycle House Batteries
- Two 12V Heavy-Duty Chassis Batteries
- Battery Disconnect Switch at Front Door
- Battery Boost Switch in Cockpit
- 2,000 Watt Inverter with Automatic Generator Start
- Porch Light
- Lighted Exterior Power Entry Step
- Lighted Interior Entry Steps
- Lights in Outside Storage Compartments
- 120V Receptacles in Outside Storage Compartment
- Exterior Tank Monitoring Gauges
- Underhood Utility Light
- Computer Hook-Up with Phone Jack in Dinette Area
- Pilot and Co-Pilot Map Lights
- Fluorescent Light under Kitchen Overhead
- Fluorescent Ceiling Lights Throughout
- Fluorescent Ceiling Lights inside Living Area Slide-Out House
- Decorative Framed Galley Fluorescent Light
- Satin Nickel Decorative Lighting in Living Room, Dinette and Bath
- Halogen Lights with Dimmer Control under Living Room, Dining Room and Bedroom Dresser Overhead Cabinets
- Satin Nickel Decorative Vanity Light
- Rope Lighting in Kitchen and Bath Toe Kicks
- Pre-Wire for Solar Panel

### OPTIONS

- Energy Management System
- Solar Panel
- 50 Amp Electric Power Cord Reel

## PLUMBING AND LP SYSTEMS

### STANDARD FEATURES

- Demand Water System and Water Pump
- 12 Gallon LP Gas/Electric Water Heater with Electronic Ignition, DSI (N/A: 38PBQ)
- 10 Gallon LP Gas/Electric Water Heater with Electronic Ignition, DSI (38PDQ)
- Single Lever Satin Nickel Kitchen Faucet with Pullout Sprayer
- Separate Satin Nickel Faucet for Filtered Water
- Single Handle Satin Nickel Bath Faucet
- Single Handle Satin Nickel Shower Faucet
- Water Heater Bypass Valve
- Water Pump Switch in Galley, Service Bay and Bath
- China Toilet
- Outside Shower with Hot and Cold Water
- No-Fuss Flush Holding Tank Rinsing System
- Gravity and Pressurized Water Fill

- Insulated Systems Compartment with Easy Access to Hook-Up
- Sewer Hose Storage
- One-Piece Shower
- Satin Nickel Shower Door Frame with Decorative Glass

### OPTIONS

- Power Water Hose Reel
- RV Sani-Con Tank Drainage System
- Electric Automatic Winterization
- Bathtub

## HEATING, VENTS AND AIR CONDITIONING

### STANDARD FEATURES

- Dual 13.5M BTU Roof Air Conditioners with Ducted Air, Heat Pumps and Digital Thermostat Control
- Air Conditioner Drain Tubes
- Dual Zone Electronic Ignition Furnaces, 50M BTU – (2) 25M BTU
- Electronic Air Conditioner/Heat Climate Control System
- In-Floor Ducted Heating System
- 12V Fantastic Attic Fan in Kitchen
- 12V Fantastic Attic Fan in Bath and Private Bath
- 12V Heater in Wet Bay

### OPTIONS

- Aqua-Hot® Water and Heating System
- Attic Fan with Rain Sensor Per Location – Lavatory, Private Lavatory

## WINDOWS, DOORS AND AWNINGS

### STANDARD FEATURES

- Radius Flush Mount Dual Pane Safety Glass Dark Tinted Slider Windows
- Front Entry Door with Removable Screen and Anti-Skid Steps
- Exterior Grab Handle
- Manual Patio Awning
- Front Door Awning
- Topper Slide-Out Awnings Living Area and Bedroom
- Tinted Skylight in Bathroom with Protecta Glaze

### OPTIONS

- Eclipse Automatic Patio Awning
- Mirage Automatic Patio Awning
- Two Bedroom Window Awnings (40PRQ)
- Window Awning
- Keyless Entry with Baggage Door Lock Release

## SAFETY

### STANDARD FEATURES

- Fire Extinguisher
- Deadbolt Lock on Entrance Door
- 120V GFI Protected Circuit
- LP Gas Detector
- Smoke Detector
- Carbon Monoxide Detector
- Driver and Passenger Three-Point Integrated Seat Belts
- Third Brake Safety Light
- Egress Windows



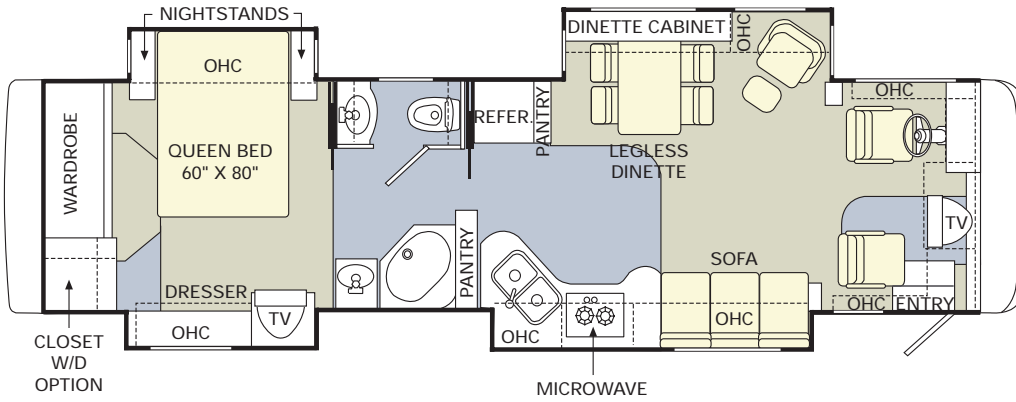

38PDQ

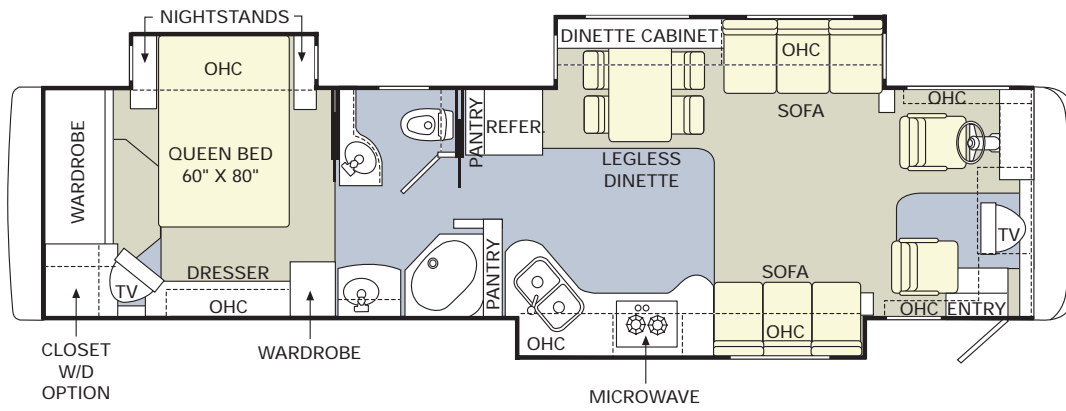

40PST

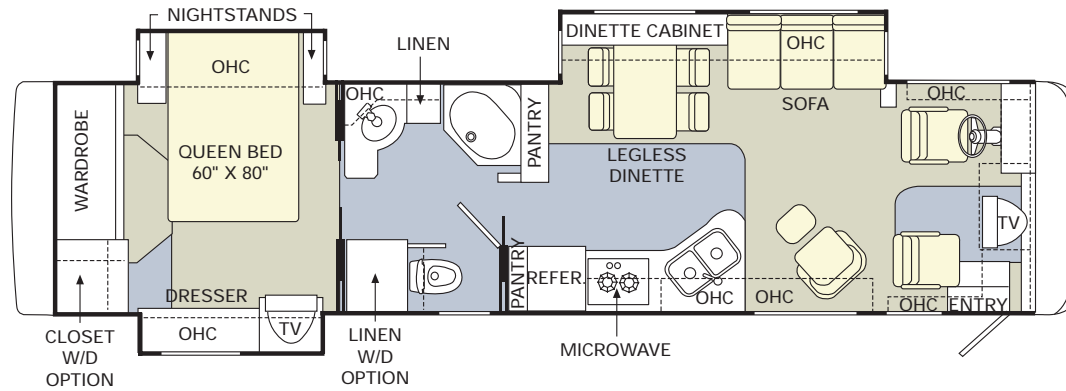

40PBT

● CARPET

● TILE



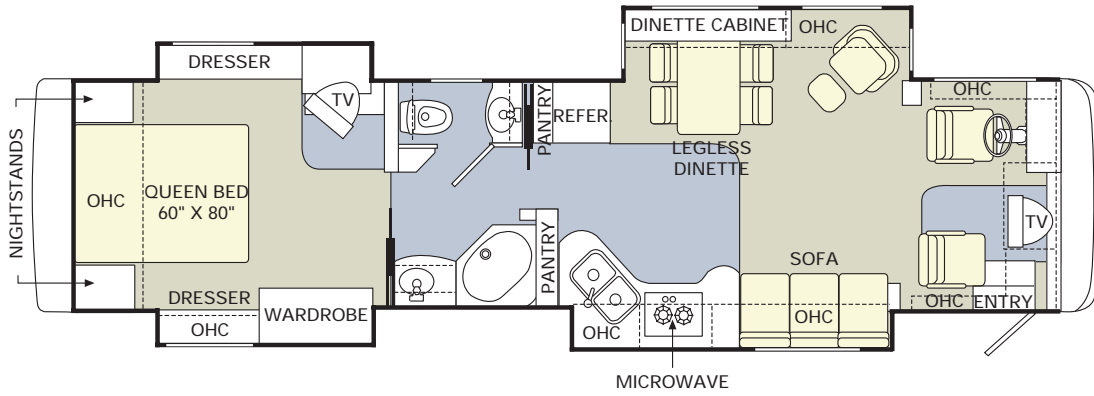

40PRQ

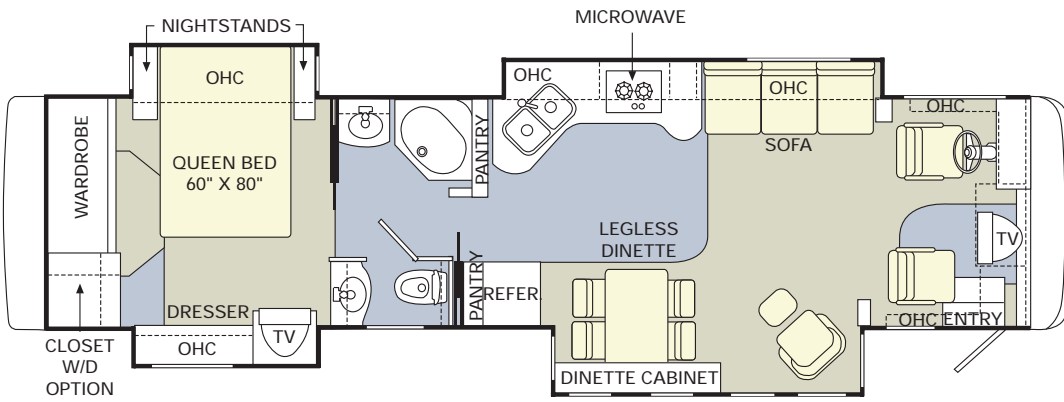

40PAQ

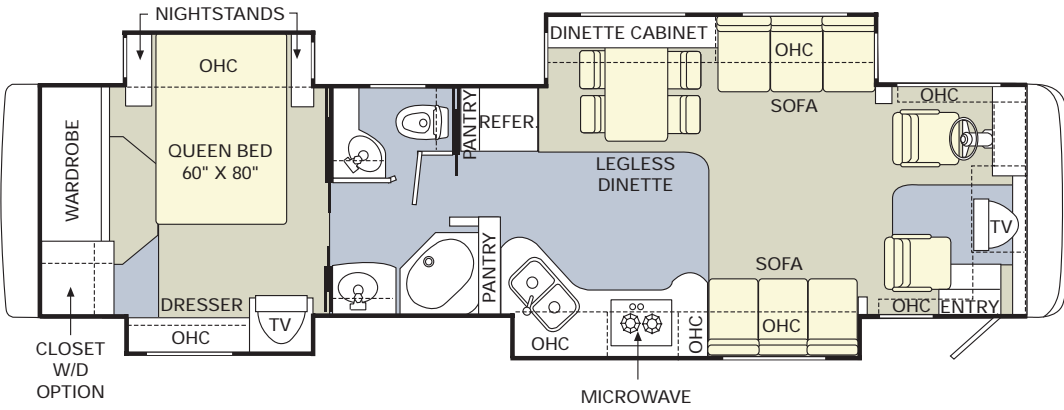

40PDQ





Weights	38PDQ	40PST	40PBT	40PRQ	40PAQ	40PDQ
Gross Vehicle Weight Rating	34,600	34,600	34,600	34,600	34,600	34,600
Gross Combined Weight Rating*	44,600	44,600	44,600	44,600	44,600	44,600
Front Gross Axle Weight Rating	14,600	14,600	14,600	14,600	14,600	14,600
Rear Gross Axle Weight Rating	20,000	20,000	20,000	20,000	20,000	20,000

### Measurements

Wheelbase	238"	262"	262"	262"	262"	262"
Overall Length	38' 7 <sup>3</sup> / <sub>4</sub> "	40' 7 <sup>3</sup> / <sub>4</sub> "	40' 7 <sup>3</sup> / <sub>4</sub> "	40' 7 <sup>3</sup> / <sub>4</sub> "	40' 7 <sup>3</sup> / <sub>4</sub> "	40' 7 <sup>3</sup> / <sub>4</sub> "
Overall Height with A/C	12' 7"	12' 7"	12' 7"	12' 7"	12' 7"	12' 7"
Interior Height	81"	81"	81"	81"	81"	81"
Interior Width	96"	96"	96"	96"	96"	96"
Exterior Width	100.5"	100.5"	100.5"	100.5"	100.5"	100.5"

### Tank Capacities\*\*

Water Heater	10	12	12	12	12	12
Gray Tank	60	60	60	60	60	60
Black Tank	40	40	40	40	40	40
Fresh Tank	100	100	100	100	100	100
LP Tank***	55	55	55	55	55	55
Fuel Tank	130	130	130	130	130	130

\* Towing capacity is limited by GCWR; your vehicle's towing capacity is the difference between the GCWR and the actual vehicle weight, including all water, fuel, passengers and cargo. Your towed vehicle should be equipped with auxiliary brakes if the weight of the towed vehicle exceeds 1,000 lbs. Consult your Owner's Manual for further towing information.

\*\* Variances in the fabrication and installation of the tanks may cause the actual "usable capacity" to be greater or less than the capacities designated above.

\*\*\* Actual filled LP capacity is 80% of listing due to safety shut-off required on tank.

Due to the large variety of options and floorplan arrangements available to our customers, actual weights for each unit can differ significantly. Holiday Rambler provides a weight sticker on each unit we produce which includes that unit's tank capacities and approximate weight. Consult your local Holiday Rambler dealer for unit availability and further information.

The information printed in this brochure reflects product design, fabrication, and component parts at the date of printing. The manufacturer reserves the right, at any time, to make changes in product design or material or component specifications as its sole option, without notice. This includes the substitution of components of a different brand or trade name, which will result in comparable performance. All information printed in this brochure is subject to change after the date of printing. Some features shown or mentioned in this brochure are optional and may only be available in selected floorplans. Photographs may show props or decorations that are not standard equipment on Holiday Rambler models. Holiday Rambler, the HR logo and its design, are registered trademarks. All other products and company names are trademarks and/or registered trademarks of their respective holders.

While the color of the motorhome's exterior and the interior fabrics depicted in this sales brochure are fair and reasonable depictions, the colors depicted may not be an exact match of the actual colors because of the variances in photo-processing and variances caused by inserting the photographs within the sales brochure. Due to product improvements, changes during the model year and/or transcription errors that may occur, information represented within this brochure may not be accurate at the time of your purchase. If certain information is significant to your purchasing decision, please confirm the information with your dealer prior to submitting your order.

The actual overall length of the recreational vehicle may differ from that indicated in the brochure due to variances in the manufacturing process and/or installed components. The actual length may be greater or less than that indicated.

Component part and appliance manufacturers issue limited warranties covering those portions of the recreational vehicle not covered by the Limited Warranties issued by the Monaco Coach Corporation companies. To learn more on what specific component parts and appliances are excluded from the Limited Warranties issued by the Monaco Coach Corporation companies please contact your selling dealership or Monaco Coach Corporation directly or review the warranty packet inside the recreational vehicle.



{ IT'S ALL ABOUT BUILDING A LASTING RELATIONSHIP. }

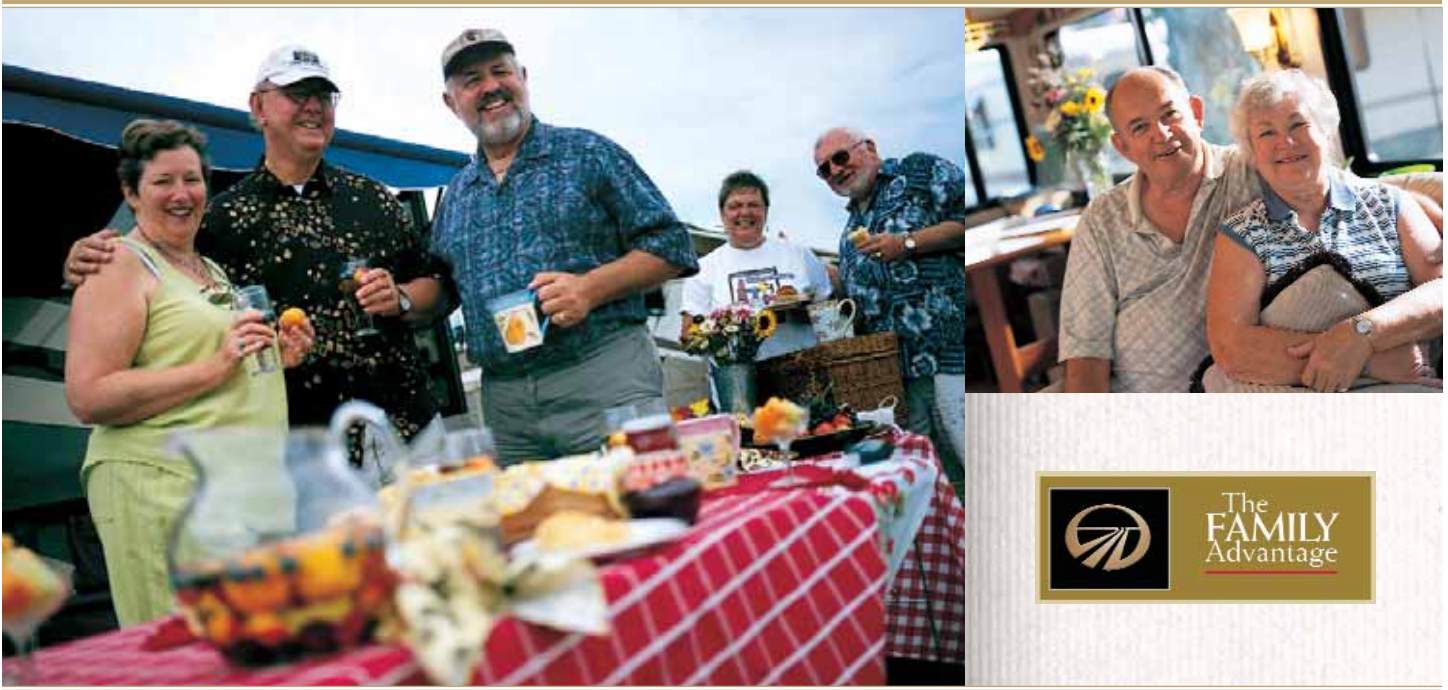

WELCOME TO THE FAMILY ADVANTAGE.

What is the Family Advantage? It's all the ways we put the strength of our family to work for yours. It's the unmatched level of teamwork, expertise and combined experience of all our companies. It's our industry-leading Roadmaster chassis and our remarkable White Glove factory inspection program.

It's our ability to respond rapidly to our owner's needs, with new features and technologies. And it's our commitment to value and to giving you more RV for your money.

The most important aspect of the Family Advantage is being there when you need us. Our staff is available 24/7/365 to help you with virtually any situation that may arise — with troubleshooting, operational instruction or facilitating repairs at the nearest of our 350 nationwide service centers. In addition, you will be enrolled in our Owner Advantage Roadside Assistance Program free of charge for your first year of ownership — providing additional emergency assistance, including towing, tire repairs and many more services around the clock. No matter where you are, someone is standing by to talk with you 24 hours a day — to help you get the most from your time on the road.

In short, when you purchase an RV from Monaco Coach Corporation, you get a wider array of benefits than any other manufacturer can offer. To see it all for yourself, call 1-800-634-0855 or 1-800-650-7337. We'd love to meet you Monday through Friday for a tour of one of our state-of-the-art production facilities in Oregon or Indiana.



350 | SERVICE FACILITIES  
NATIONWIDE AND GROWING.

OWNER ADVANTAGE ROADSIDE ASSISTANCE PROGRAM

At no charge to you in your first year of ownership, we offer an extensive support program that provides complete roadside assistance and special motor club benefits that follow you wherever your travels take you. This coverage also includes one additional family vehicle at no extra charge! Highlights include towing, tire repairs, fuel delivery, lock-out service, service appointment assistance, trip interruption coverage and much more.

WARRANTIES

12 MONTH/24,000 MILE  
basic limited warranty

5 YEAR/50,000 MILE  
limited warranty on aluminum or steel frame structure  
of sidewall, roof, front and rear cap

3 YEAR/36,000 MILE  
limited warranty on Roadmaster chassis

Applies to certain models. See owner's manual for complete details.





2005 | SCEPTER®



*This is Living®*



HOLIDAY RAMBLER®

*This is Living®*

[www.holidayrambler.com](http://www.holidayrambler.com)

(800) 245-4778

MONACO COACH CORPORATION

Monaco is traded on the New York Stock Exchange under the listing MNC  
© 2004, Monaco Coach Corporation 1104 NPN:BROHSCE Litho in USA.

