

EXTENDED STAY FIFTH WHEELS

# SOLITUDE

BY GRAND DESIGN RV

EXTENDED STAY FIFTH WHEELS



SOLITUDE  
BY GRAND DESIGN RV

GRAND DESIGN  
RECREATIONAL VEHICLES

If more room is what you desire,  
**SOLITUDE IS THE MOST SPACIOUS  
 EXTENDED STAY FIFTH WHEEL EVER BUILT!**

Solitude delivers a body width that measures a full 101 inches wide, with taller ceilings, deeper cabinets, larger scenic window areas, and a full 6' 8" tall slide-out.



Power reclining theatre seating from the Thomas Payne Collection features LED lighted cup holders with touch controls for the heat and massaging functions. There are even LED light strips underneath the sofa that provide a soothing glow.



**"SIGNATURE"  
 WALL MOUNTED  
 DINETTE**

No center pedestal under the table leaves plenty of room for 4 to dine in comfort.

Includes four fully padded dinette chairs (2 folding) with hidden storage under the seat.



Surround yourself in the luxury of solid surface countertops, flush range and sink covers, stainless steel appliances, residential fixtures, and hardwood cabinetry. (310GK shown)



The bath area has modern appeal with a vessel bowl sink, designer faucet, and generous sized shower with seat. (384GK shown)



Sleep well in the spacious master suite with your choice of a king or queen size bed (most models) and plenty of storage space. (300GK shown)

REFINED  
**RESIDENTIAL**  
FINISHES

Every Solitude incorporates high end residential finishes such as solid hardwood window treatments, solid hardwood panel island surrounds, real ceramic tile backsplashes, hardwood pantry doors, porcelain vessel bowl bathroom sinks, and high end decorative leaded glass. Typically found in motorhomes costing hundreds of thousands of dollars, Solitude is the only fifth wheel to offer all of these finishes in its price point! (360RL shown)



**PANTRY STORAGE**

Huge kitchen pantry storage is a hallmark feature on the Solitude.



**PET DISH STORAGE**

Keep your pets happy with a convenient pull out pet dish storage drawer.

MASTER BED

**PULL-OUT OTTOMAN**

A pull-out ottoman at the bed base provides additional storage and a place to sit and get ready. (NA 374TH)

**keyed alike**  
One key works all your locks



# BUILT TO A HIGHER STANDARD

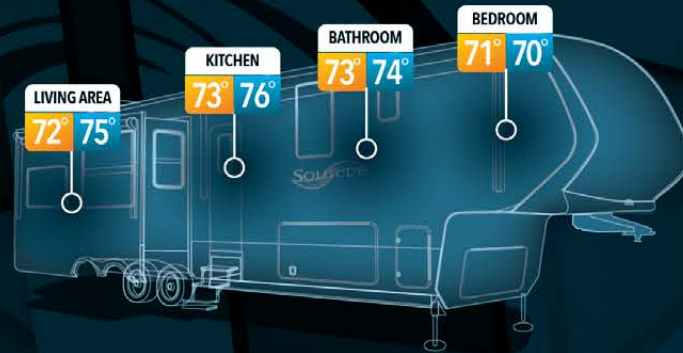

Solitude's design has been put to the test in extreme temperatures ranging from ZERO to 100+ degrees. Third party testing showed that the Solitude remained fully functional and retained comfortable temperatures throughout the coach.

Note: Testing was performed in a temperature controlled chamber and does not account for variables such as wind, humidity, and altitude. Due to the number of potential variables, temperatures reported during testing may differ from temperatures achieved during actual use of the unit in nature.



## BACKED TO A HIGHER STANDARD



Every Grand Design RV is backed with a class leading 3-year limited structural warranty. By selecting suppliers with similar philosophies, many components used on our coaches also carry an extended warranty through the component manufacturer.

- ▶ **FLOOR DECKING** (25 Years)
- ▶ **AXLES** (6 Years)
- ▶ **TIRE WARRANTY** (5 Years w/12 Month no questions asked replacement)
- ▶ **EXTERIOR GRAPHICS** (5 Years)
- ▶ **ROOF COVERING** (12 Years)

### EXCLUSIVE! SUPERCHASSIS

**101" Wide Body Chassis** - A full 5" wider than many coaches in its class, the widebody chassis allows for more livable floor space with deeper sliderooms, wider sofas in rear lounge models, and space saving sliding pocket doors into the bathrooms...all at a shorter towing length.

**Wide Rail Design** - Heavy duty I-beam main rails are placed further outward on the chassis. This wider rail placement provides a more stable jack stance, and allows for the slideroom gearpacks to be enclosed inside the frame rails (rather than outside).



## "ONE" FOUNDATION

**ONE supplier. ONE contact. ONE unified foundation.**

Solitude's rock solid foundation uses key components, designed by one supplier, that are engineered to work seamlessly together. This unified foundation is easier to use, easier to troubleshoot and easier to service.

- ▶ **101" WIDEBODY CHASSIS**
- ▶ **7,000 LB AXLES W/ SELF ADJUSTING BRAKES**
- ▶ **ROTA-FLEX™ PIN BOX**
- ▶ **EQUA-FLEX® SUSPENSION SYSTEM WITH BRONZE BUSHINGS**
- ▶ **6-POINT HYDRAULIC LEVELING SYSTEM**
- ▶ **QUAD ENTRY STEPS**
- ▶ **SLIDEROOM SYSTEMS**

10" - 12" Main Rail

10" Drop Rail  
(Not 8" like many competitors)



## MAXIMUM INSULATION

### 1 THERMAL ROOF DESIGN (R-40)\*

Fiberglass insulation and a layer of radiant foil insulation cover the roof. Grand Design goes further by extending both insulation layers the full length of the roof and around to the bottom of the front cap. To maximize the effectiveness of the insulation, a vented attic allows condensation to escape the roof structure.

**EXCLUSIVE COMBINATION!**

### 2 FULLY LAMINATED WALLS (R-11)\*

Sidewalls, rear wall, slideroom endwalls and slideroom roof are all welded aluminum framed and laminated with rigid foam insulation. Many others use wood framing and soft fiberglass insulation in the rear wall and sliderooms that can settle over time and leave uninsulated air gaps.

**EXCLUSIVE!**

### 3 TRIPLE INSULATED MAIN FLOOR (R-45)\*

The underbelly is lined with a radiant foil insulation barrier (Layer 1) and then covered with fiberglass insulation (Layer 2). The main floor enhances the R-Value with yet another layer of fiberglass insulation (Layer 3).

**EXCLUSIVE!**

### 4 RAIL-TITE UNDERBELLY SEAL

Rigid aluminum rails are fastened around the perimeter of the underbelly to keep the corrugated barrier up tight against the frame for a better seal from the elements.

*\*Equivalent R-Value*

### 5 INSULATED GOOSENECK

Fiberglass insulation under the gooseneck is a place often forgotten by others.

### 6 1.5" INSULATED BAGGAGE DOORS

Rigid foam insulation lines the inside of our heavy duty baggage doors.

## MAXIMUM FUNCTION

### 40,000 BTU OF HEATING POWER

A high performance furnace and fireplace combine to deliver the heat.

### EVENFLOW HEATING SYSTEM

Vertically mounted heat vents integrated into the cabinet bases, push hot air from front to back (rather than straight up). This also means that there are no heat vents in the middle of the main floor to collect dirt and debris, and that can be broken easily.



### HEATED UNDERBELLY & STORAGE BAY

Dedicated heat ducts run to both the underbelly and storage bay. 12-volt heat pads on each holding tank, and the enclosed utility center with low point drains, provides functional water systems even in extreme cold.

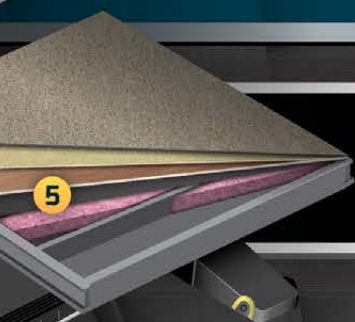

## STEALTH A/C SYSTEM



**30,000 BTU OF COOLING POWER**  
Dual 15,000 BTU ACs

### ULTRA QUIET

*Up to 2x quieter than the competition.*



### AIRGUIDE TECHNOLOGY

Cool air is guided through the ducts and forced out of the vents for maximum cooling efficiency.



### TYPICAL DUCTING

Typical ducting provides partial airflow with less cooling efficiency.



### RACETRACK DUCTING

True Racetrack Ducting extends past each AC unit to allow for uninterrupted airflow from the front to the back of the coach.

**23% MORE AIRFLOW**  
THAN AVERAGE OF LEADING COMPETITORS

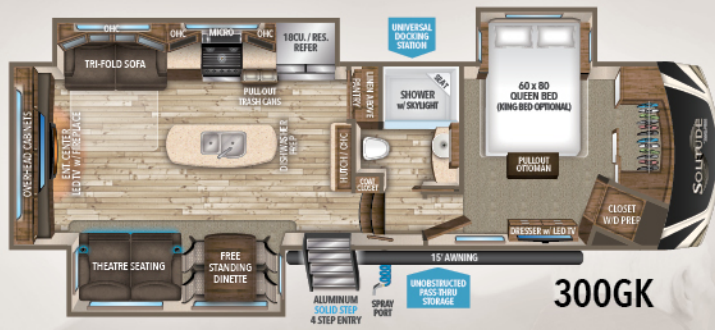

**300GK**

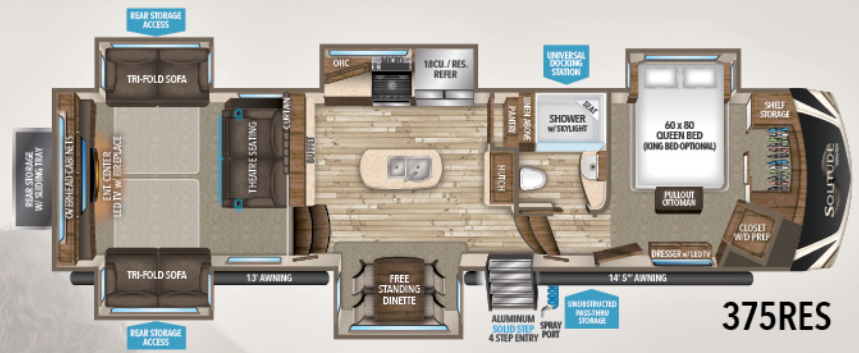

**375RES**



**310GK**



**377MBS**



**360RL**

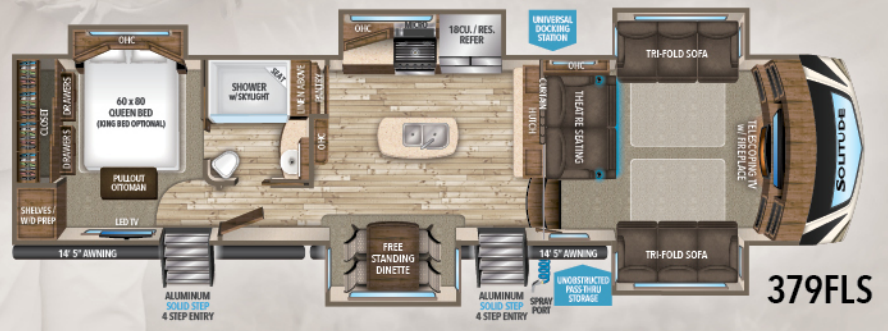

**379FLS**

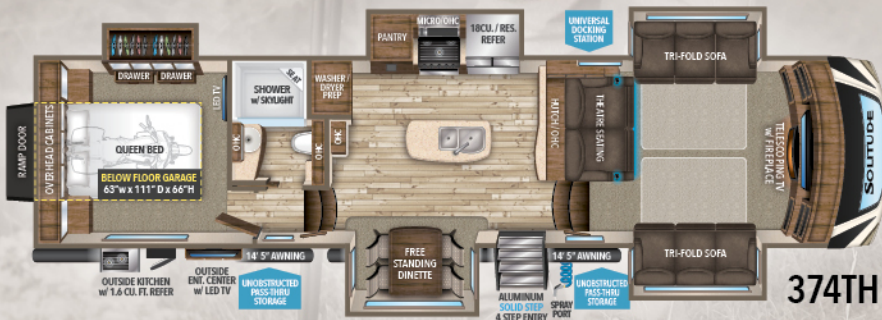

**374TH**



**384GK**

	300GK 300GK-R*	310GK 310GK-R*	360RL 360RL-R*	374TH 374TH-R*	375RES 375RES-R*	377MBS 377MBS-R*	379FLS 379FLS-R*	384GK 384GK-R*
UVW (lbs.)†	12,100	12,100	13,500	15,500	14,200	13,200	13,800	13,450
Hitch Weight (lbs.)†	2,635	2,350	2,700	3,200	2,900	2,750	2,990	2,740
GVWR (lbs.)	15,000	15,000	16,000	20,000	16,500	16,000	16,000	16,000
Length‡	34' 11"	34' 11"	39' 4"	41' 3"	41' 4"	40' 10"	42' 6"	40' 7"
Height	13' 5"	13' 5"	13' 5"	13' 5"	13' 5"	13' 5"	13' 5"	13' 5"
Water (gal.) - Fresh   Gray   Waste	54   50   50	54   50   50	54   100   50	100   100   50	54   100   50	54   100   50	54   100   50	54   100   50

†Based on average weight ‡Hitch to rear \* Model numbers ending in "R" indicate the unit is equipped with a residential refrigerator.

**EXTERIOR & CONSTRUCTION**

Drop Frame Chassis	S
101" Widebody Construction	S
Trailair® Rota-Flex™ Pin Box	S
Equa-flex® Suspension	S
Heavy Duty 7,000 lb. Axles	S
16" Aluminum Wheels	S
Self Adjusting Brakes	S
West Lake® E-Rated Tires w/NitroFill™	S
<b>Goodyear® G-Rated Tires (G614)</b>	O
16" Spare Tire (Undermount)	S
6-Point Hydraulic Leveling System	M
Slide-Out Selector Valves	S
High-Gloss Gel Coat Exterior Sidewalls	S
Color Matched Fender Skirt	S
5-Side Aluminum Cage Construction	S
Walk-On Roof	S
TPO Roof Covering w/12-Year Warranty	S
Slam-Latch Baggage Doors w/Magnetic Catches	S
76"x30" Entry Door	S
Keyed Alike (One Key For All Entry and Baggage Doors)	S
Frameless Tinted Windows	S
<b>Dual Pane Windows</b>	O
Painted Gel Coat Fiberglass Front Cap	S
Front Cap Windshield (374TH, 379FLS)	S
Quad Entry Step	S
Exterior Security Light	S
LED Tail Lights	S
Power Patio Awning w/Integrated LED Lighting	S
Back-Up Camera Prep	S
Roof Ladder	S
<b>Slide-Out Awning Toppers</b>	O
Sewer Hose Storage Area	S
R-Value Equivalent (R-40 Roof / R-45 Floor / R-11 Sidewalls / R-24 Slideroom Floor)	S

**AUDIO & VIDEO**

Big Screen LED TV in Living Area	S
LED TV in Master Bedroom	M
HDMI Stereo/CD/DVD Entertainment System w/ App Controls	S
Exterior Cable/Satellite Plug-In	S
Exterior Speakers	S
King Jack Antenna	S
Satellite/Cable Prep (All TV Locations)	S

**INTERIOR**

Roller Shade Window Coverings	S
Hardwood Window Treatments	S
Congoleum Flooring w/3-Year Warranty (Main Floor & Upper Landing Area)	S
Easy Clean Solid Surface Steps	S
Hallway Handrail	S
Recessed LED Ceiling Lighting	S
Interior Blue LED Accent Lighting	S
Hardwood Cabinet Doors and End Tables	S
Leaded Glass Cabinet Door Inserts (Select Areas)	S
Signature Wall Mounted Dinette Table w/ 4 Padded Chairs (2 Stow Away Chairs)	S
Power Reclining Theatre Seating w/LED Lighting Package (Includes Heat and Massage Function)	S
Tri-Fold Hide-A-Bed Sofa	S
Double Tri-Fold Hide-A-Bed Sofas (374TH, 375RES, 377MBS, 379FLS)	S
Smoke Detector, LP Alarm, Carbon Monoxide Alarm	S

**UTILITIES**

All-In-One Enclosed and Heated Utility Center	S
50 Amp Service w/Detachable Power Cord	S
75 Amp Converter	S
12-Volt Battery Disconnect	S
12-Volt Tank Heaters	M
<b>Generator Prep</b>	O

**KITCHEN**

Convection Microwave	M
Oversized Kitchen Pantry	S
Real Tile Backsplash	S
Hardwood Kitchen Light Soffit	S
Solid Surface Countertops & Sink Covers	S
Stainless Steel Undermount Kitchen Sink	S
Residential Kitchen Faucet w/Pullout Sprayer	S
Sealed Burner Stainless Steel Range w/22" Oven & Flush Cover	S
Dishwasher Prep (300GK, 310GK, 360RL, 384GK)	S
Stainless Steel 18 Cu. Ft. 4-Door Refrigerator	M
<b>Residential Stainless Steel French Door Refrigerator (IPO 18 cu. ft Refrigerator)</b>	O

**BED & BATH**

60" x 80" Queen Bed (NA 384GK)	S
<b>King Bed (Std 384GK/NA 374TH)</b>	O
Residential Style Headboard	S
Window Above Master Bed Headboard	S
Under Bed Storage Area	S
Pull-Out Ottoman at Bed Base (NA 374TH)	S
Night Stands	S
Individually Switched Reading Lights Over Bed	S
Bedside 110-Volt Outlets (2)	S
Residential Bedroom Dresser	S
One-Piece Fiberglass Shower w/Glass Door	S
Porcelain Toilet	S
White Porcelain Vessel Bowl Sink	S
Linen Storage w/Cabinet Doors	S

**HVAC & PLUMBING**

Stealth AC System (Dual 15k BTU AC's w/Racetrack Ducting)	S
<b>Heat Pump AC Upgrade in Living Area</b>	O
Kitchen 12-Volt High Power MaxxAir Fan with Rain Sensor	S
35k BTU High Output Furnace	S
Fireplace with Electric Heater	M
Washer/Dryer Prep	S
12-Gallon Gas/Electric Water Heater	S
Whole House Water Filtration System	S
Exterior Spray Port (Door Side)	S
Fully Enclosed Underbelly w/Heated Tanks and Storage	S
Enclosed and Heated Low Point Drains	S
Attic Vent	S
High Capacity Heat Ducts	S

**STANDARD BUILD PACKAGES (Mandatory)**

**RESIDENTIAL LIVING PACKAGE**

**PEACE OF MIND PACKAGE**

**MAX BUILT CONSTRUCTION PACKAGE**

**WEATHER-TEK PACKAGE**

- S - STANDARD
- M - MANDATORY
- O - OPTIONAL



Because of our commitment to continuous product improvement, Grand Design Recreational Vehicles reserves the right to change components, standards, options, specifications, and materials without notice and at any time. Photos may show optional equipment which may not be included in the standard purchase price of the featured unit. Be sure to review current product details with your local dealer before purchasing. Rev 12.28.16

# We Strive For Nothing Less Than Customers for Life!

**Thank you for taking the time to tour our coach. We would like to share some insights into what sets Grand Design RV Company apart from all other RV manufacturers and why this difference is important to you.**

The three of us were part of the original ownership team that led a top RV Manufacturer to become the largest travel trailer and fifth wheel company in the world. While proud of our accomplishments at this company, it became difficult to stay in touch with the needs of our customers, employees, and ultimately the products we built.

In 2011, we set out to pursue our dream and re-establish the personal connection we had enjoyed with customers and dealers. The result is Grand Design RV Company. Starting with a blank canvas, we were able to do things differently than what had been done before.

After achieving unparalleled years of growth, Grand Design formed an alliance with one of the industry's most iconic brands...Winnebago. Operating as an independent business within Winnebago Industries provides additional financial stability and enables us to continue Grand Design's unique way of doing business for our current and future customers.

## LONG TERM VALUE

Everything we do at our company is designed to build long term value in what we offer our customers, "more features and superior value for your dollar."

## CUSTOMER FOCUS

Our focus (from the very first day we opened our doors) revolves around the customers.

## STAYING CONNECTED

Magic happens when the President and Senior Management are all actively working in the production facilities to help build the team and develop products.

## EXPERIENCED WORKFORCE

Our local workforce has been hand-picked, and has an excellent reputation for quality craftsmanship that is second to none.

## CLASS LEADING WARRANTY

We back every one of our coaches by a 3-year limited structural warranty.

## RAISING THE QUALITY BAR

We put every Grand Design RV through a series of quality inspection gates during the manufacturing process. Once completed, the unit undergoes a comprehensive final finish inspection. From here, most manufacturers ship their coaches on to the dealer for retail sale. Not Grand Design...Every one of our coaches are shipped to a separate PDI (Pre-Delivery Inspection) location where they are again put through a 250+ point inspection process. It is only after this that we deem a unit ready to ship to our dealers.

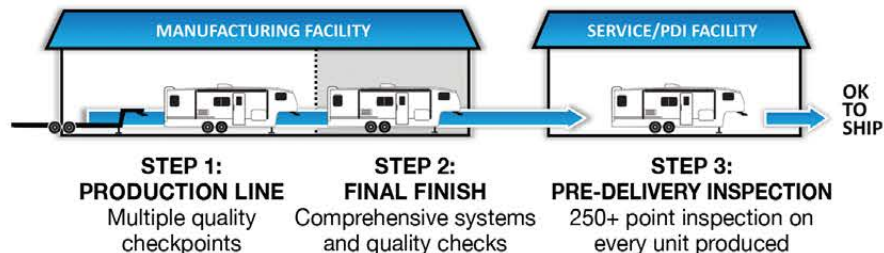

## SUPERIOR SERVICE

We deliver the highest quality in the industry, but anything built by humans can be subject to issues. It's how those issues are addressed that stands out with Grand Design. Don't just take our word for it, visit the owners page on Facebook (Grand Design RV Owners) and see for yourself how we take care of our customers after the sale. An informed customer will be a Grand Design customer!

At Grand Design our goal is simple... Continue leading the industry with quality products while improving the customer's RV experience before, during, and after the sale. We would be honored to personally welcome you to the Grand Design RV family!

Warmest Regards,

**Don Clark, Ron Fenech, Bill Fenech**

President / Co-Founder

Co-Founder

Co-Founder



Grand Design RV was created in 2012 and founded by close friends Don Clark and brothers Ron and Bill Fenech (Representing over 80 combined years of experience in the RV Industry).