

2019 MELBOURNE • MELBOURNE PRESTIGE



2019 MELBOURNE • MELBOURNE PRESTIGE



Mom & Dad hittin' the trails
Big Bend '89



2
YEAR
LIMITED
WARRANTY



MELBOURNE

FEATURED FLOORPLAN 24L:

- RESIDENTIAL-SIZE CONVECTION MICROWAVE
- SOFT-TOUCH VINYL CEILING
- SOUNDSTREAM INFOTAINMENT SYSTEM W/GPS
- SWIVEL DRIVER/PASSENGER SEATS



MELBOURNE FLOORPLANS



24K



24L

SPECS

| MODELS | | DIMENSIONS | | | | | TANKS (GALS.) | | |
|--------------------|-----------|-----------------|----------------|----------------------------|-----------------|------------|-----------------------------|----------------------------------|-----------------------------------|
| MODEL | FLOORPLAN | EXTERIOR LENGTH | EXTERIOR WIDTH | EXTERIOR HEIGHT (WITH A/C) | INTERIOR HEIGHT | WHEEL BASE | FRESH WATER CAPACITY (GAL.) | GREY WASTE WATER CAPACITY (GAL.) | BLACK WASTE WATER CAPACITY (GAL.) |
| MELBOURNE | 24K | 25' 2" | 96" | 11' 5" | 83" | 170" | 43 | 31 | 31 |
| | 24L | 25' 2" | 96" | 11' 5" | 83" | 170" | 43 | 31 | 31 |
| MELBOURNE PRESTIGE | 24AP | 25' 2" | 96" | 10' 11" | 80" | 170" | 39 | 31 | 31 |
| | 24KP | 25' 2" | 96" | 10' 11" | 80" | 170" | 43 | 31 | 31 |
| | 24LP | 25' 2" | 96" | 10' 11" | 80" | 170" | 43 | 31 | 31 |

Gross Vehicle Weight Rating (GVWR): The maximum permissible weight of the motorhome, including the Unloaded Vehicle Weight (UJV) plus passengers, personal items, all cargo, fluids, options and dealer-installed accessories. The GVWR is equal to or greater than the sum of the UJV and the Cargo Carrying Capacity. **Gross Combined Weight Rating (GCWR):** The maximum allowable combined weight of the motorhome used as a tow vehicle and the attached towed vehicle. It is important for your safety and enjoyment that you are aware of the weights and tow ratings of the RV you select. Consult a competent advisor for questions or advice. Whether you are new to RVing or a veteran, get a feel for the performance of your RV before heading out on the roadways. When you tow a vehicle with your RV, you must drive differently than when you drive a single vehicle. Practice hooking up, driving, backing up and braking in a safe environment or seek out professional instruction. Jayco affixes a weight label to each RV which lists weight information for that vehicle. Refer to that label to verify the vehicle will meet your requirements.



MELBOURNE PRESTIGE

FEATURED FLOORPLAN 24LP:

- WOVEN VINYL FLOORING
- ULTRALEATHER FABRICS
- CUSTOM CURVED CABINERY
- DAY/NIGHT ROLLER SHADES
- 750-POUND OVERHEAD BUNK CAPACITY
- AUTOMOTIVE-BONDED PANORAMIC WINDOW IN FRONT CAP

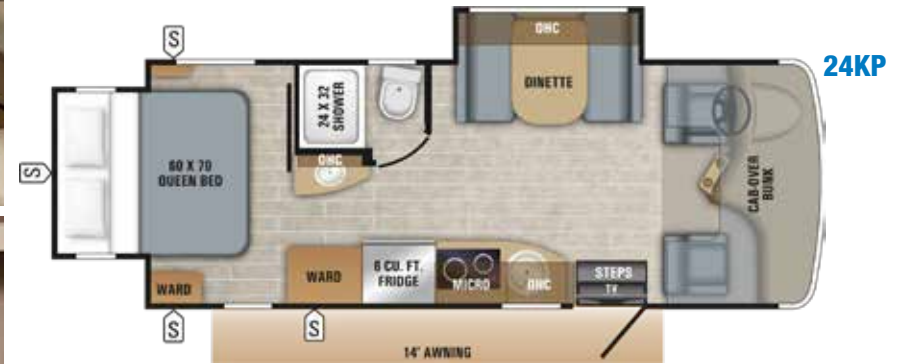



THE JAYCO DIFFERENCE

1. **One-piece seamless fiberglass front cap** for increased durability and protection
2. **750-pound overhead bunk capacity** offers nearly 250 pounds more than the industry average for greater safety and peace of mind
3. **Integrated electric step** maximizes ground clearance and floor space
4. **Integrated third brake light** improves safety on the road
5. **Seatbelts** in every seating position
6. **Frameless windows** make exterior maintenance easier than ever and give the unit a sleek, modern look
7. **Full pass-through storage** for easy packing and unpacking (select models)



To see a full list of standards and options, use your camera app to scan code.



MELBOURNE

MELBOURNE
PRESTIGE

MELBOURNE INTERIOR DÉCOR*

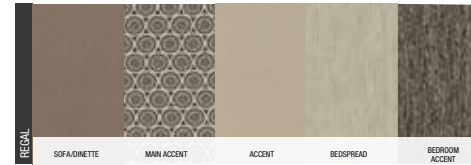
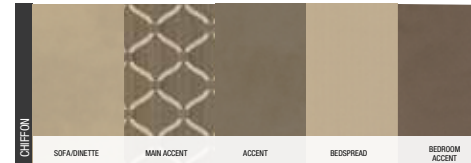

MELBOURNE PRESTIGE INTERIOR DÉCOR**



**Décor is exclusive to Melbourne Prestige

MELBOURNE PRESTIGE EXTERIORS



Premium Paint - Canyon



Premium Paint - Hollywood



Premium Paint - Merlot



Premium Paint - Phantom

MELBOURNE EXTERIORS



Standard Graphics



Premium Paint - Muirfield



Premium Paint - Pinehurst



Premium Paint - Waterville

Meet your Jayco Dealer



Follow Jayco
#Jayco50



Jayco, Inc. | P.O. Box 460 | Middlebury, IN 46540 See dealer for further information and prices. All information in this brochure and on www.jayco.com is the latest available at the time of publication approval. Jayco reserves the right to make changes and to discontinue models without notice or obligation. Photography may show optional equipment or props used for decoration purposes only. RVs built for sale in Canada may differ to conform to Canadian codes. JAYCO and the JAYCO BIRD IN FLIGHT are registered trademarks of Jayco, Inc. Printed in USA 53K 7/18 ©2018 Jayco, Inc. 274892

Travel with Confidence



At Jayco, we build our RVs to handle every adventure, then back them with our industry-leading 2-year limited warranty. We, with support from our select partners, have you covered for **2 camping seasons** or **twenty-four thousand (24,000) miles** (mileage limitation applies to motorized products only), whichever occurs first, from the original date of purchase. You won't find a better warranty in the business, because the only strings we attach are those that deliver the ultimate in reliability. That's the Jayco difference. So go explore. For a copy of our 2-year limited warranty with complete terms and conditions, please contact your local Jayco dealer.



A year's access to Coach-Net™—the country's largest RV emergency road service.

