

# FUZION

F I F T H   W H E E L   T O Y   H A U L E R S



LIVE IT OUT.



# FUZION



— FUZION | TOY HAULERS —

## HIGH ADRENALINE

Keystone Fuzion models bring heart-pumping styling, pioneering floorplans, and the best RV garages, specifically engineered for power sports enthusiasts. Whether you're hauling dirt bikes, ATVs, motorcycles or golf carts, our frame-welded, Adjust-A-Trac™ tie-downs feature 38 connection points to fully secure the widest range of vehicles. Everything you need to get out and get after it!

For more information, please visit [kestonerv.com/Fuzion](http://kestonerv.com/Fuzion)



# KEYSTONE EXCLUSIVE INNOVATIONS

Designed to deliver superior performance, quality and a best-in-class camping experience, every Fuzion model includes engineering innovation available EXCLUSIVELY to Keystone owners. For more information about these features and the Keystone Innovation Lab, visit us online at [www.keystonerv.com/innovations](http://www.keystonerv.com/innovations).



## 3-YEAR LIMITED STRUCTURAL WARRANTY, 1-YEAR LIMITED BASE WARRANTY

Every new Keystone RV comes with the industry's best three-year limited structural warranty AND a one-year limited base warranty. Ask your dealer, visit [keystonerv.com](http://keystonerv.com), or call Keystone Owner Relations for details.



### KeyTV™

No more connection guesswork or poor reception. KeyTV offers a game-changing, single point of control of over-the-air, cable, and satellite feeds.



### Automotive-Grade Painted Fiberglass Cap

Six layers of stunning and resilient automotive-grade paint with Key-Shield™ paint technology.



### Color-Coded Unified Wiring Standard

Easy-to-trace circuits simplify electrical and entertainment system troubleshooting.



### In-floor Heating Ducts

Distributes heat evenly through your coach for superior comfort.

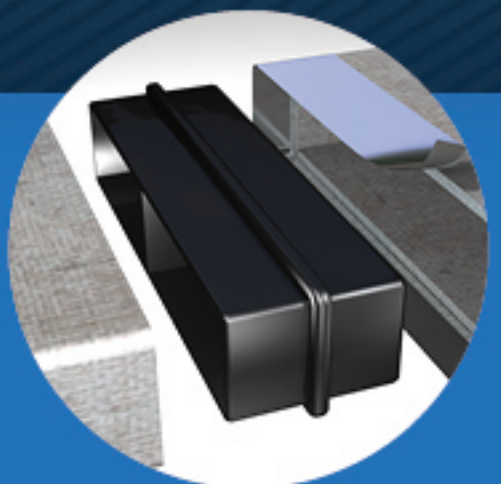

### Tuf-Lok™ A/C Duct Joiners

Crush resistant design securely joins ductwork and A/C units, and drastically reduces chilled-air leaks to boost cooling efficiency and comfort.



### Tru-fit™ Slide Construction

A more durable slide room design that minimizes functional motor and structural stress and resists leaking.





more product detail at  
[www.keystonerv.com/Fuzion](http://www.keystonerv.com/Fuzion)



## HEART-PUMPING STYLE

This year Keystone Fuzion is introducing new on-point interior styling. We wanted to maintain Fuzion's contemporary vibe, but add a warmer more universal appeal. We accomplished that with a focus on brighter and more authentic finishes. The new design features a lighter wallboard, soft gray hardwood cabinetry and subway tile backsplash.







## FLEXIBLE GARAGE SPACE

Garages range from 11' to 15' and feature a great multi-use space for a bonus bedroom, mudroom, art studio, storage, etc.



## NEW & NOTEWORTHY

East/west bed slides now in every Fuzion floorplan.





# blade

HIGH-PERFORMANCE AIR FLOW SYSTEM



## BLADE™ HIGH PERFORMANCE AIR HANDLING SYSTEMS

Engineered to maximize the output from today's high-performance RV air conditioners, Keystone's NEW patented air handling system delivers an average of 20% more cooling power and is built to withstand the rigors of the road. The Blade™ system is designed to accelerate air flow, eliminate leakage and failure points, deliver 360° circulation in the cabin, and withstand environmental and road stressors that lead to reduced performance.

## NEW FULL-BODY PAINT DESIGN

Full-body paint is hotter than ever with Fuzion buyers. Fuzion ups the ante with an exhilarating new design in blue, red, orange and gold colorways.



COLOR OPTIONS





# MODERN AMENITIES

From the EQ smart level to the exclusive adjust-a-track frame welded tie-down system, Impact gives camping a whole new meaning.

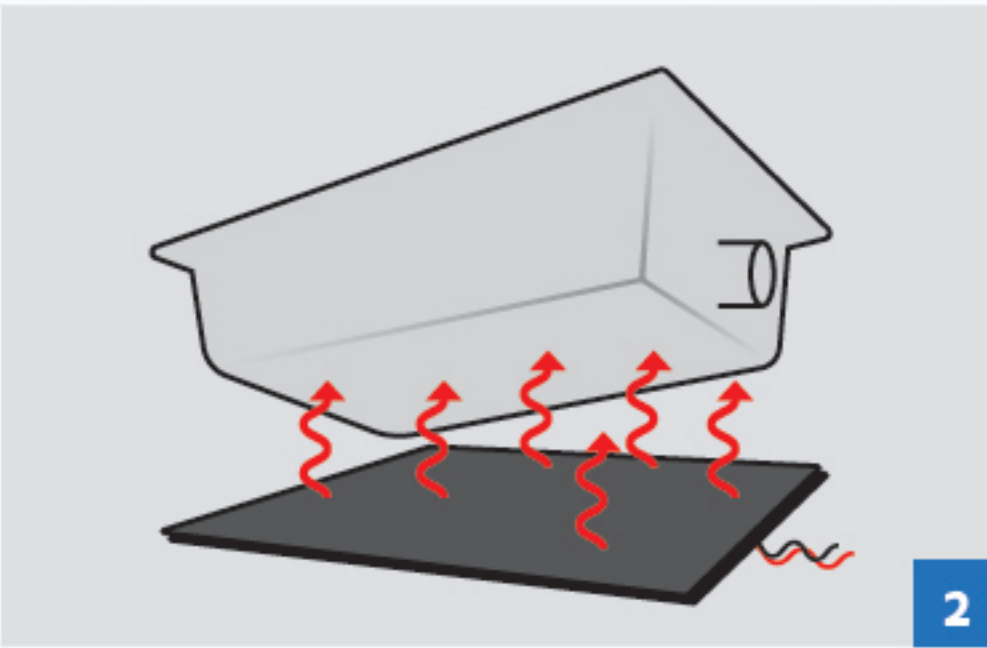
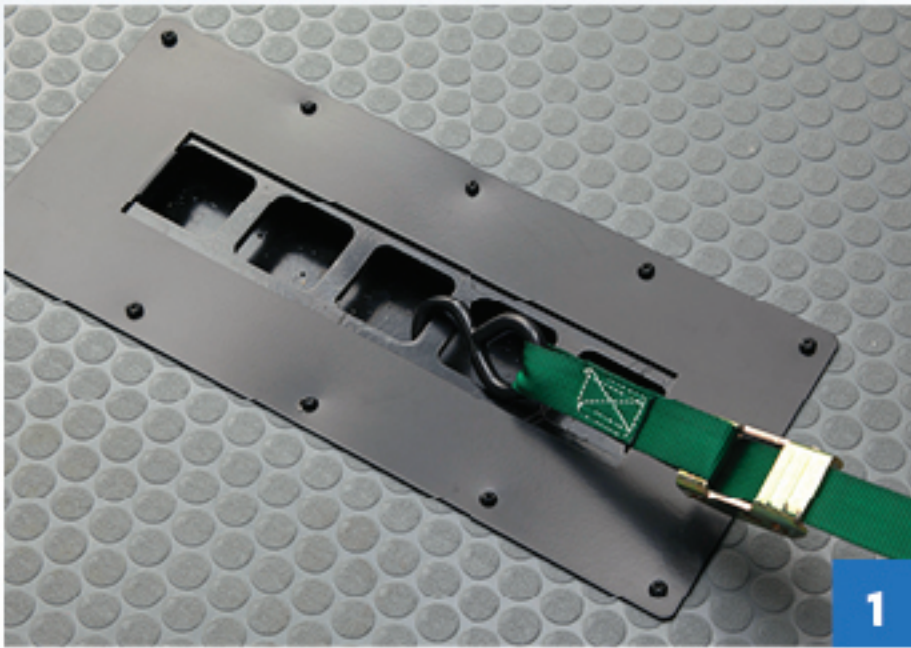

**1. EXCLUSIVE ADJUST-A-TRACK™ FRAME-WELDED TIE DOWN SYSTEM**

Fuzion has 38 points of contact welded into its frame, each supporting up to 5,000 lbs.

**2. THERMAL HEAT PAD UNDER TANKS**

Additional layer of insulation prevents tanks from freezing.

**3. MORRYDE® CRE/3000 SUSPENSION**

Increases dynamic axle travel up to three inches for smoother and more stable towing.

**4. OMNI CHILL™ AIR CONDITIONER SYSTEM**

Operate three A/C units simultaneously for the most cooling power in the industry.

**5. EQ SMART LEVEL BY EQUALIZER SYSTEMS**

With 12" landing pads. Smart phone and iN-Command integration.

**6. CNC Routed SIDEWALLS**

Ensures perfectly cut / perfectly fit windows, doors, and slide-boxes and creates a better seal around windows and doors.

**7. MORRYDE® ZERO-G RAMP DOOR W/ FAST TRACK PATIO SYSTEM**

Spring-assisted garage door opens and closes weightlessly. Comes with a side entrance patio system to extend your living space.

**8. EXTERIOR CONVENIENCE CENTER**

Complete with easy-to-read operation instructions for hookups, dry camping, black tank flush, winterizing, and more.

**9. IN-COMMAND® GENERATION 3 W/ GLOBAL CONNECT**

Systems monitoring and total control over power, slide rooms, awnings, HVAC and more from a central monitoring panel or your smart phone.



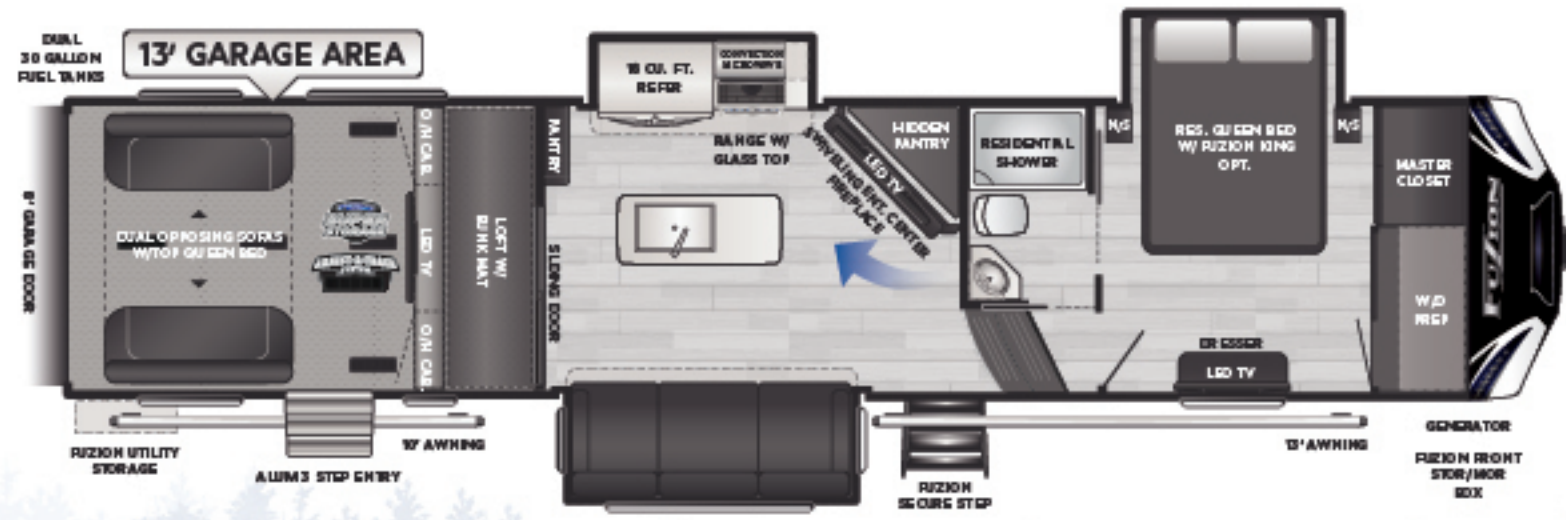

**357** | Kitchen island, hidden pantry, tandem-axle, 13' garage

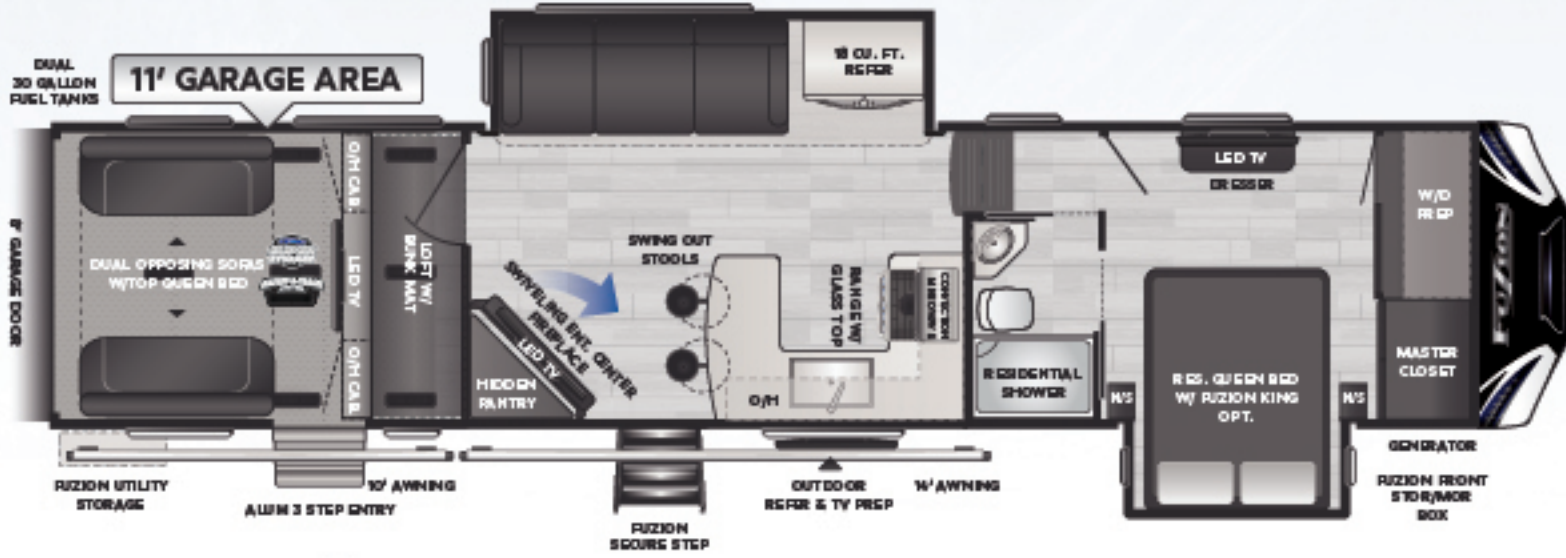

**369** | Bar top seating, hidden pantry, tandem-axle, 11' garage

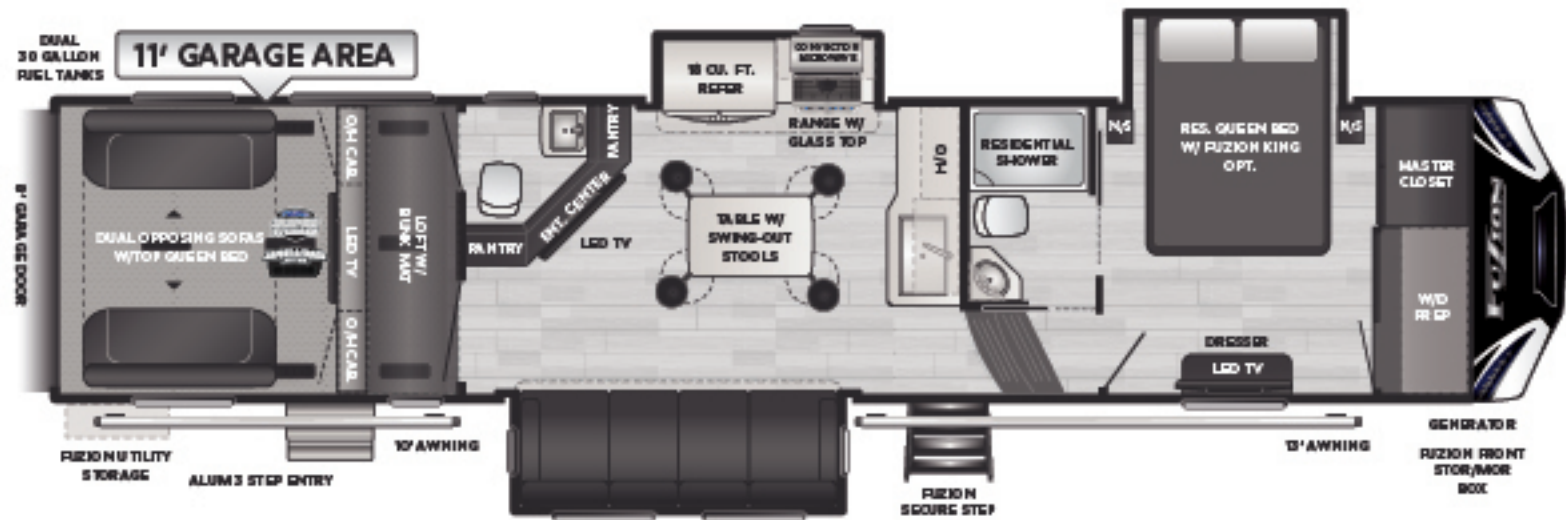

**373** | Kitchen island, swing out stools, 1 1/2 baths, tandem-axle, 11' garage

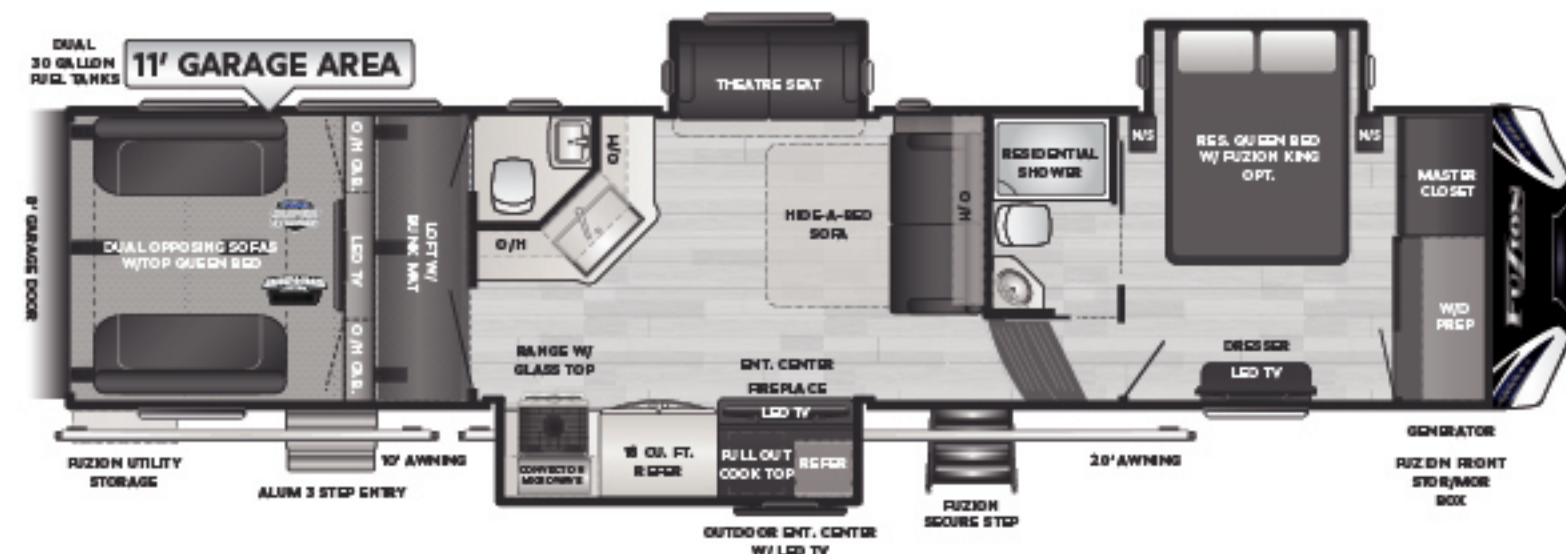

**NEW!** **379** | Cross conversational seating, 1 1/2 baths, outdoor kitchen, 11' garage

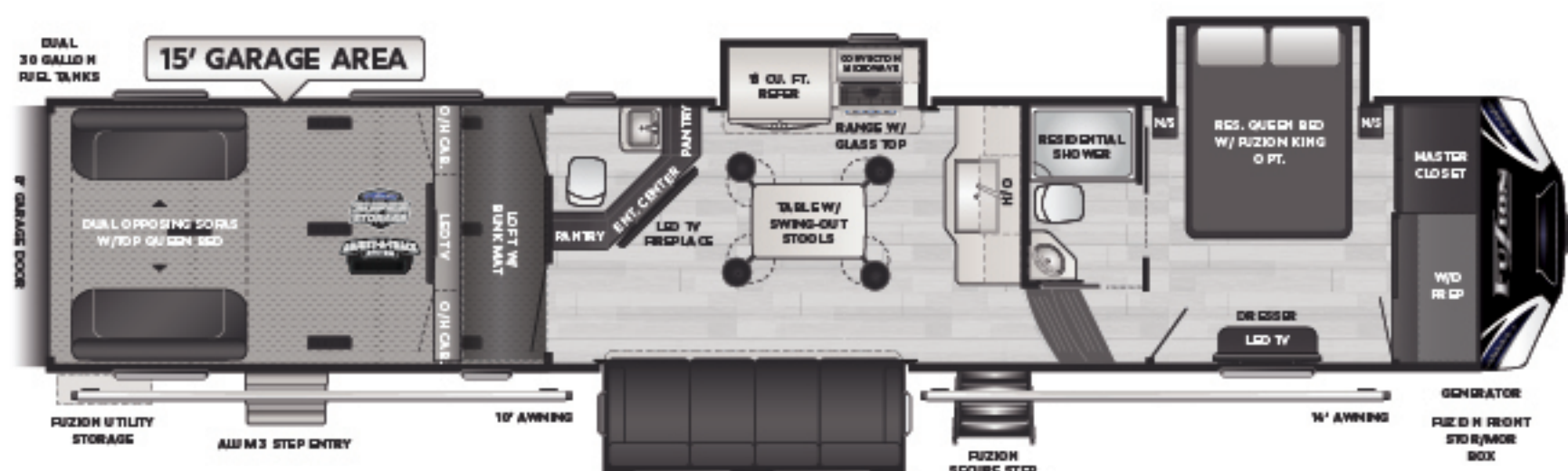

**419** | Kitchen island, swing out stools, 1 1/2 baths, triple-axle, 15' garage



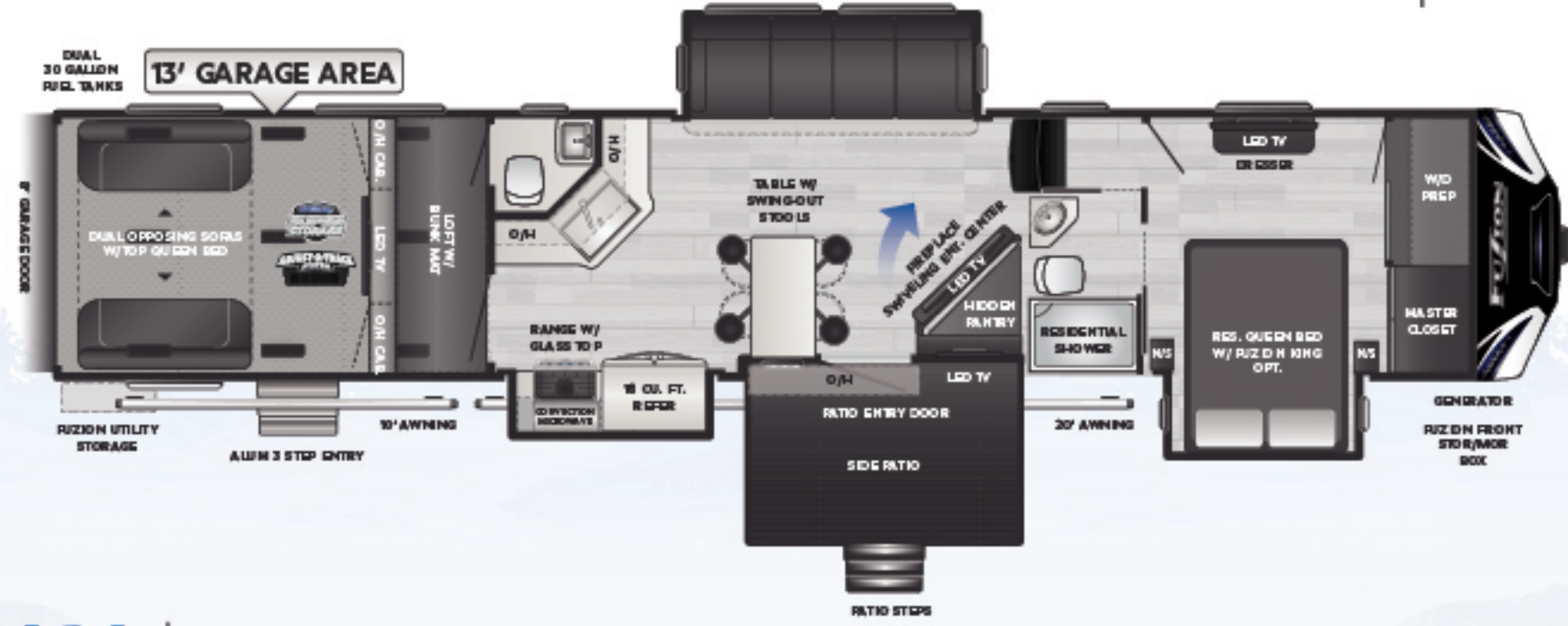

**424** | Side patio, hidden pantry, swing out stools, 1 1/2 baths, triple-axe, 13' garage

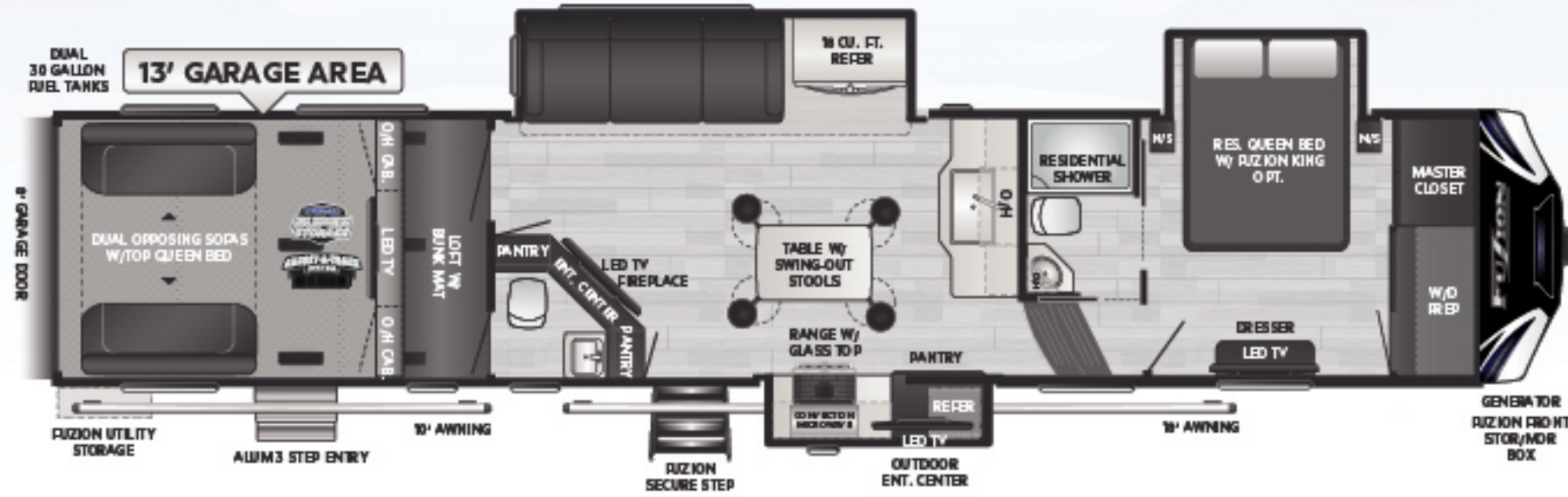

**427** | 1 1/2 baths, outdoor kitchen, triple-axe, 13' garage

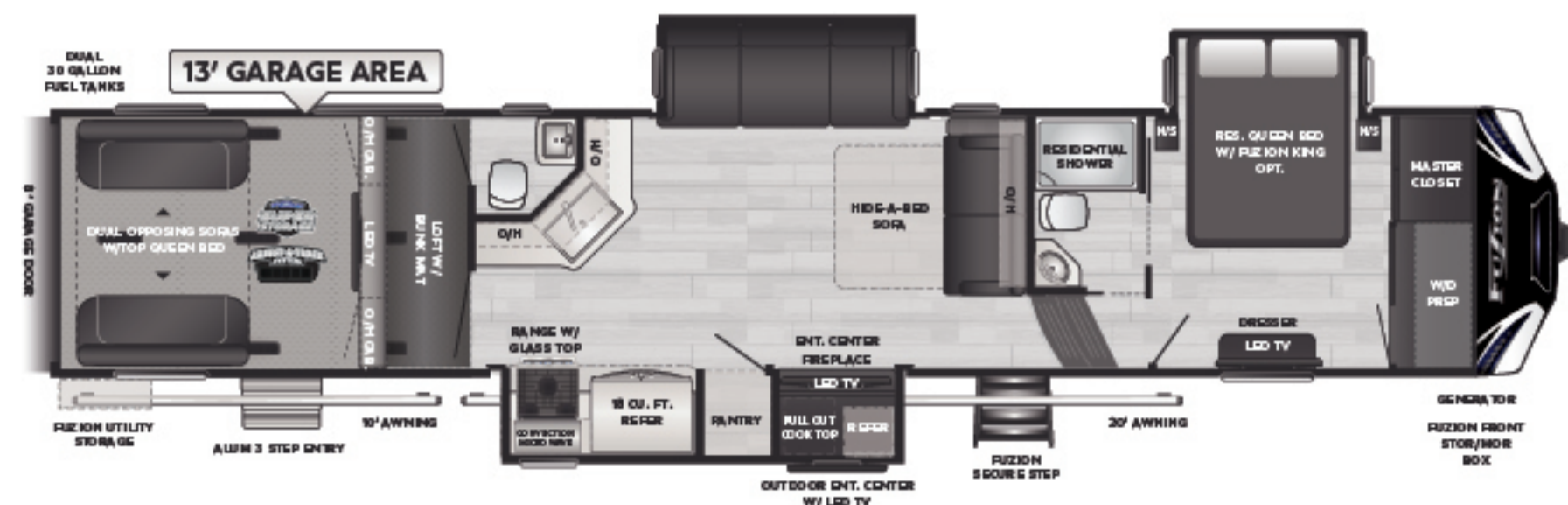

**NEW! 428** | Cross conversational seating, 1 1/2 baths, outdoor kitchen, 13' garage

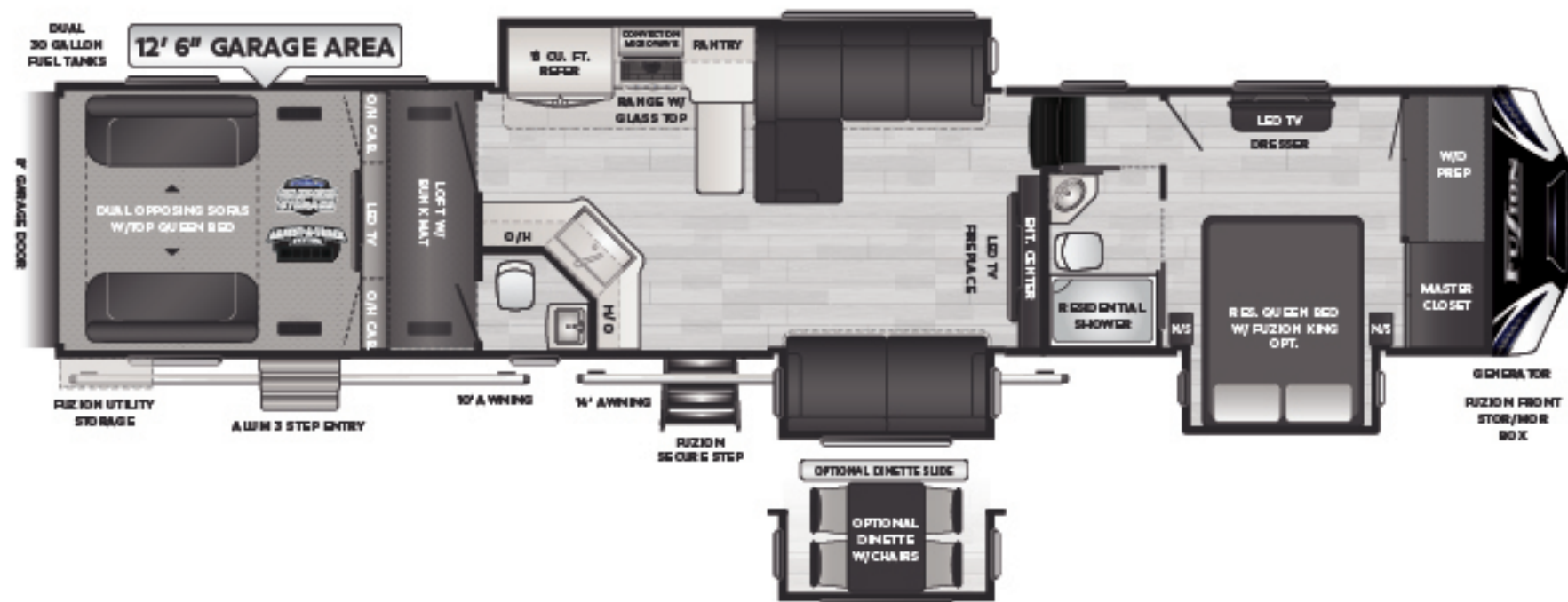

**429** | L-shaped sofa, 1 1/2 baths, triple-axe, 12' 6" garage

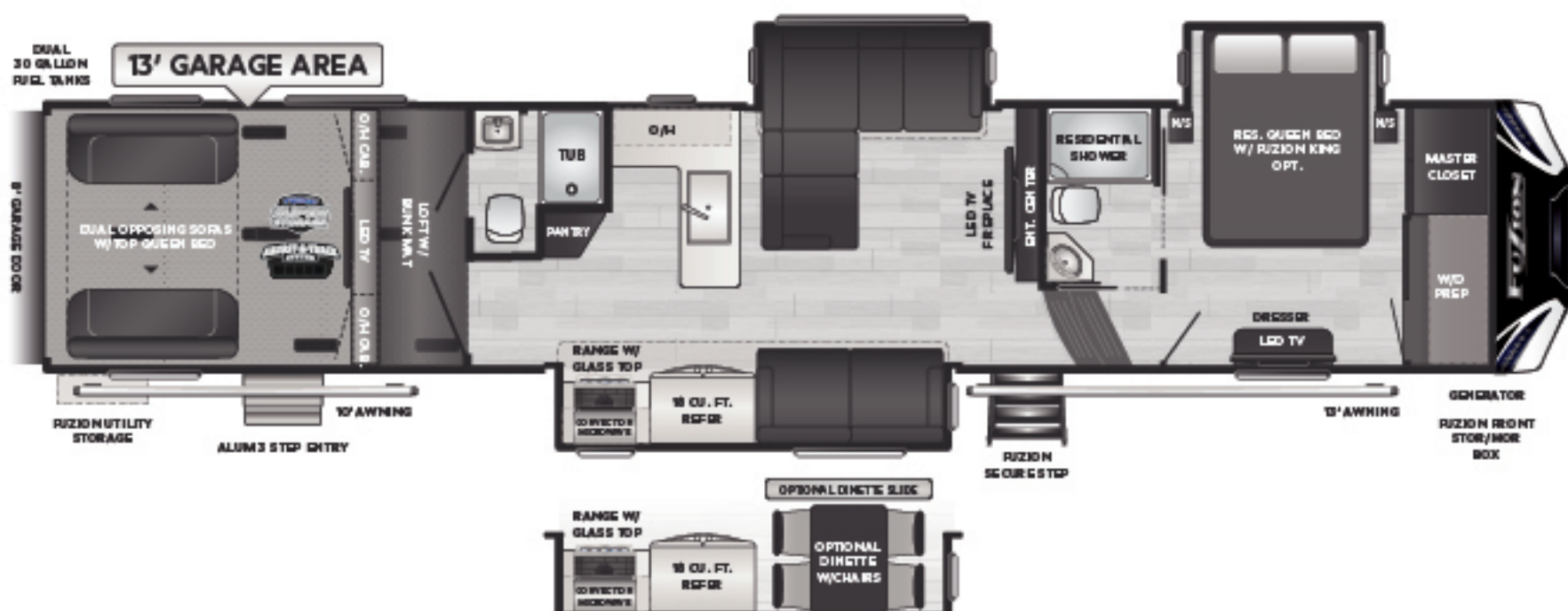

**NEW! 430** | L-shaped sofa, 2 full baths, triple-axe, 13' garage



MODEL	WEIGHT	CARRYING CAPACITY	HITCH WEIGHT	FRESH WATER	WASTE WATER	GRAY WATER	LPG	LENGTH*	WIDTH	HEIGHT	AWNING
357	TBD	TBD	TBD	106	44	88	60	39' 0"	8' 4"	13' 3"	10'/13'
369	13599	3401	3015	106	44	88	60	39' 0"	8' 4"	13' 3"	18'/12'
373	14200	2800	3155	106	88	88	60	39' 0"	8' 4"	13' 3"	10'/13'
379	14485	2515	3155	106	88	88	60	39' 6"	8' 4"	13' 4"	10'/20'
419	15456	3544	3330	106	88	88	60	44' 0"	8' 4"	13' 5"	10'/14'
424	16177	2823	3525	106	88	88	60	44' 0"	8' 4"	13' 5"	10'/20'
427	15655	4345	3400	106	88	88	60	43' 6"	8' 4"	13' 5"	10'/18'
428	15980	4020	3595	106	88	88	60	44' 0"	8' 4"	13' 5"	10'/20'
429	15700	4300	3405	106	88	88	60	44' 0"	8' 4"	13' 5"	10'/14'
430	15475	3525	3325	106	88	88	60	43' 3"	8' 4"	13' 5"	10'/13'

DISCLAIMER: Product information is as accurate as possible as of the date of publication of this brochure. All features, floor plans, and specifications in this brochure are subject to change without notice. Please also consult Keystone's web site at [www.keystonerv.com](http://www.keystonerv.com) for more current product information and specifications. Tow Vehicle Disclaimer. CAUTION: Owners of Keystone recreational vehicles are solely responsible for the selection and proper use of tow vehicles. All customers should consult with a motor vehicle manufacturer or their dealer concerning the purchase and use of suitable tow vehicles for Keystone products. Keystone disclaims any liability or damages suffered as a result of the selection, operation, use or misuse of a tow vehicle. KEYSTONE'S LIMITED WARRANTY DOES NOT COVER DAMAGE TO THE RECREATIONAL VEHICLE OR THE TOW VEHICLE AS A RESULT OF THE SELECTION, OPERATION, USE OR MISUSE OF THE TOW VEHICLE. \*Length is defined as the distance from the centerline of hitch pin/coupler to rear bumper of trailer. Please review owner's manual prior to purchase for more information on service warranties, extended use, towing and maintenance. Owner's manuals can be found at [keystonerv.com](http://keystonerv.com).



## KEY PERFORMANCE

Fuzion is a Keystone Key Performance brand, what that means is every model is designed by a dedicated toy hauler team to deliver a higher standard of durability and performance. Each floorplan is specifically created to haul power sports vehicles, with extra security built in for toys and the humans that travel with them.

### KEYSTONE EXCLUSIVES

- 3-year limited structural warranty
- 1-year limited base warranty
- Color-coded unified wiring standard
- 4G LTE and Wi-Fi prep
- Tuf-Lok™ thermoplastic duct joiners
- KeyTV™ multi-source signal controller
- In-floor heating ducts
- Tru-fit™ slide construction

### INTERIOR

- Premium Jensen® bluetooth compatible stereo with CD/DVD player, flat panel Jensen® LED HDTV, sound bar, 2 all weather Sony exterior speakers, a,b, and c zone indoor/outdoor speaker switch, 3 way speakers
- OmniChill™ A/C w/ thermo-plastic duct couplings
- Insulated A/C ductwork
- 30" convection microwave

21" 3-burner Furrion® oven with glass top

18 cu. ft. refrigerator

Professional bottle opener

Bamboo sink covers

Residential cabinet hardware

Roller shades (living room, bedroom)

Night shades in garage

Solid wood drawer frames

80 lb. rated full-extension ball bearing drawer guides

Recessed LED puck lighting throughout

Residential-style furniture w/ heated seats, LED lights, massage and 110V/USB ports

Stainless steel appliances

Fuzion sky-dome

30" wide radius entry door with screen

KeyTV™ Satellite prep (bedroom, living room, garage, outdoor TV)

Digital TV antenna



60" X 80" residential size queen bed

Under bed storage

Full-size, one piece fiberglass shower w/seat

Fireplace w/surround

Adjustable, hand-held massaging shower fixture

Skylight over shower

Porcelain toilet with foot flush

Fantastic fan in commode room & kitchen

Mirrored medicine cabinet

Loft bunk ladder

40" X 80" Loft mattress

LPG detector

Carbon monoxide detector

Fire extinguisher

GFI duplex receptacles

Washer/dryer prep

**EXTERIOR**

Painted front cap w/ key-shield technology

Aerodynamic fiberglass front cap with lights and improved turning radius

Generator prep with start / stop switch, hour meter and fuel gauge

Fuel station with 12V pump, dual 30-gallon fuel tanks, and static line

6pt EQ Smart Level by Equalizer Systems

MORryde® CRE 3000 suspension

Attic vents

Step light

LED security lights

LED cargo ramp loading lights

Compartment lights

LED tail/brake lights

Frameless tinted safety glass windows

Spare tire and carrier

Collapsible roof ladder

Dual, folding assist handles with padding on entry doors

Dual power awning w/LED lighting

LP quick connect

**GARAGE**

Double electric beds with dual opposing sofas

Residential glass pass-through door

Upgraded sidewall protection

Metal ram air vents (2)

8' ramp door

Gas/oil resistant tuff-ply flooring

Ducted A/C, ducted heat

Independent direct dump A/C in Garage

EXCLUSIVE KeyTV™ cable TV/satellite prep

Night shades

Adjust-A-Track™ frame-welded tie-downs

**EQUIPMENT**

Gen 3 iNCommand control system w/ Global Connect

7,000 Lb. Dexter E-Z Lube® axles

Flipped axles

Electric 12" x 2" brakes on every wheel

16" Aluminum wheels

Goodyear® made in America tires

5500 Watt Onan generator w/ 30-gallon fuel tank

12-gallon gas / electric water heater with direct spark ignition

Low-rise aluminum entrance step in garage

50 Amp service with detachable marine power cord

90 Amp converter

12V disconnect

Water heater bypass

Power tank flush on all black tanks

Outside shower

35,000 BTU furnace

Heated, insulated, enclosed holding tanks

Electric heat pads on tanks

MORryde® Secure Step on main entry door

Fast track 2.0 patio system with electric awning & patio step

**SAFETY**

Fire extinguisher

Smoke detector

LPG detector

CO detector

Safety chains

Emergency breakaway switch

**OPTIONS**

Sliding rear patio door

Dual-pane frameless windows

King bed suite

Full-body paint

SolarFlex™ solar package

Camp-side cinema package



# BUILT FOR THE LONG HAUL



## 1 EASIER SHOPPING.

At Keystone, we make choosing an RV as easy as finding the Big Dipper on a dark summer night. With comprehensive online product information, Key Connect™ product advisors, and an unparalleled dealer network, we will help you select the perfect RV for your family's adventure.

## 2 INNOVATIVE THINKING.

The road's a nicer place when you have the industry's smartest features behind you. Keystone leads the pack in patented innovations that make our RVs safer, more comfortable, and easier to operate.

## 3 LONG HAUL QUALITY.

To keep you on the road, there are certain things we just won't build a Keystone RV without. Game-changing features like our Unified Wiring Standard, Tru-Fit™ five-point slide construction, and no-fail Tuf-Lok™ A/C duct joiners combined with exhaustive testing and inspections are some of the reasons why Keystone is able to offer our owners the industry's best 3-year limited structural warranty.

## 4 WORRY-FREE CUSTOMER SERVICE.

Wherever the road takes you, you're never too far from an authorized Keystone service center. We also offer live service assistance, ultra-fast parts shipping, online maintenance tips and tricks, and a single-point warranty claims policy. *That's* peace of mind.

## 5 KEYSTONE NATION.

When you choose Keystone, you become a part of one of the largest camping families in the country. We're Keystone Nation. A friendly community where people share photos, travel tips and amazing stories — all in the spirit of camaraderie and adventure. Come join us.