

2022 ENTEGRA COACH VISION

# VISION

GAS CLASS A MOTOR COACH



2022



ENTEGRACOACH  
COACH®



# FLOORPLANS

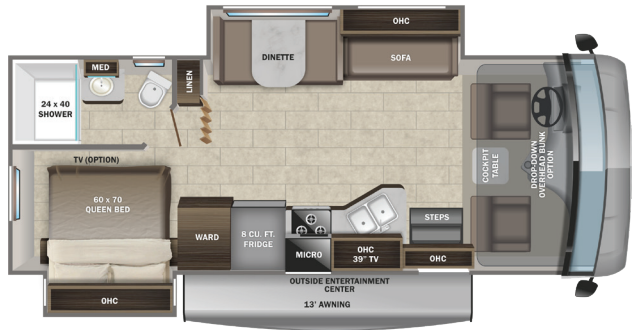

**26X** OPTION B



**27A** OPTION A

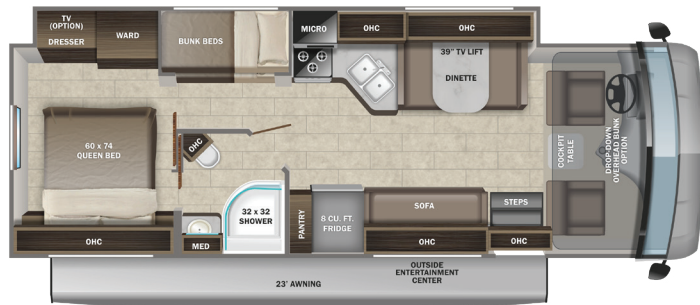

**29F** OPTION A

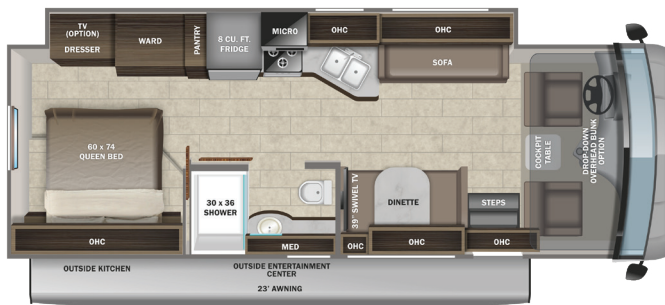

**29S** OPTIONS A AND B

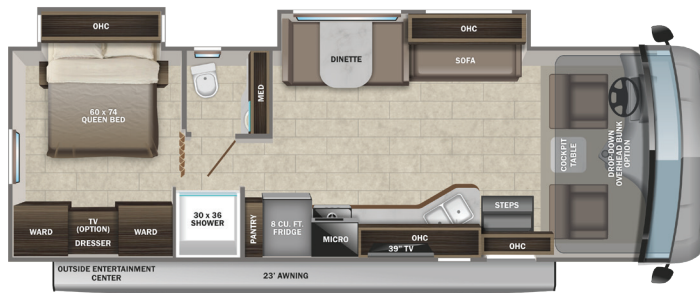

**31V** OPTIONS A AND B

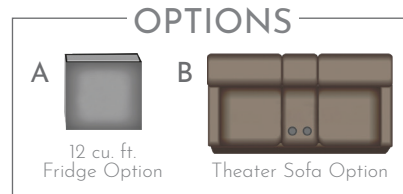

## EXTERIOR SELECTIONS



Cerulean Full-Body Paint

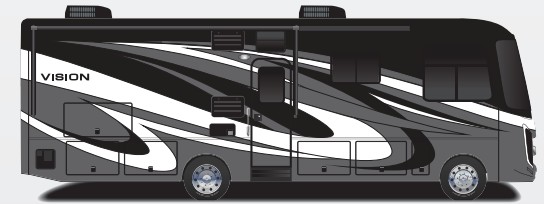

Obsidian Full-Body Paint

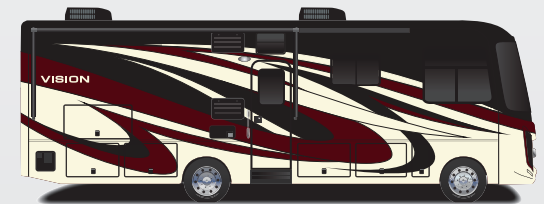

Ruby Full-Body Paint



Ocean Spray Standard Graphics

## CUSTOMER VALUE PACKAGE

E-Z DRIVE™: Computer-balanced driveshaft, jounce bumpers, heavy-duty front and rear stabilizer bars, SACHS shocks  
 One-piece, crowned fiberglass roof  
 Exterior entertainment center with outside speakers, LED TV mounted on swivel bracket and single-disc DVD/FM radio  
 Electric patio awning with LED lights  
 Slideout cover awnings  
 1,000-watt inverter  
 Sony® infotainment center with Apple CarPlay® and Android Auto™  
 Backup and side-view cameras  
 Removable driver/passenger cockpit table  
 LED HD Smart Fire TV in living area  
 Blackout night roller shades

## STANDARD CHASSIS EQUIPMENT

Ford® F53 chassis  
 GVWR - 16,000-lb. (26X), 18,000-lb. (27A, 29F, 29S, 31V)  
 GCWR - 23,000-lb.  
 7.3L V-8 350 HP engine with 468 ft.-lb. torque  
 6-speed automatic TorqShift® transmission with overdrive and tow haul mode  
 210-amp alternator  
 G-rated highway tires-245/70R19.5  
 Front and rear disc, 4-wheel anti-lock brakes  
 5,000-lb. rear hitch receiver with dual connector and 7-pin plug  
 12V chassis battery  
 80-gal. fuel tank

## HEAT, A/C, POWER & WATER EQUIPMENT

Onan Marquis Gold Genset 5,500-watt gas generator (4,000 watt on 26X)  
 Transfer switch with reverse polarity protection  
 50-amp electrical service (30 amp on 26X)  
 (2) 6V AGM house batteries  
 190W solar panel with dual controller  
 Heated holding tanks (12V pads)  
 15,000-BTU A/C unit with heat pump and second 13,500-BTU A/C unit (15,000-BTU A/C unit on 26X)  
 30,000-BTU auto-ignition ducted furnace  
 Girard® tankless LP water heater  
 16.5-gal. propane tank (56-lb.)  
 LP quick-connect hookup  
 Exterior utility center  
 Winterization drain system  
 Black tank flush

Outside shower  
 12V demand water pump  
 Water filtration system

## STANDARD EXTERIOR EQUIPMENT

TuffShell™ vacuum-bond laminated roof, floor and sidewalls  
 Bead-foam insulation (R-24 max roof, R-9 max floor, R-5 max walls)  
 One-piece, seamless, fiberglass front cap with partial paint  
 Fiberglass exterior walls with vinyl graphics  
 Automatic hydraulic leveling jacks  
 Frameless windows  
 Entrance door with industry's largest travel-view window  
 Electric-powered entrance step  
 Lockable pass-through storage compartments with metal slam latches  
 4-in. tube bumper with sewer hose storage  
 Roof ladder

## COCKPIT AMENITIES

Power front privacy shade with manual side privacy shades  
 120-in. panoramic windshield - largest in the industry  
 Swivel driver and passenger seats  
 Soft-touch, vinyl-wrapped automotive dash  
 A/C and cruise control  
 Tilt steering wheel  
 Auxiliary start

## STANDARD INTERIOR EQUIPMENT

84-in. interior ceiling height  
 High-intensity recessed LED ceiling lights  
 LED-lit hardwood fascia  
 Hardwood cabinet doors and drawers  
 Ball-bearing drawer guides  
 Entegra-exclusive, easy-operation legless dinette table  
 Prep for satellite dish  
 Cable TV hookup with RG-6 coax  
 Winegard 2.0 Wifi/4G antenna  
 8-cu.ft gas/electric refrigerator  
 Furrion® all-in-one cooktop and oven  
 Residential-size microwave  
 Large, recessed, stainless steel kitchen sink with cover  
 LED-lit pressed countertops  
 Flip-up countertop extension (select models)  
 Decorative kitchen backsplash  
 Pop-up charging station in kitchen with 110 outlets and USB ports

Shower with decorative surround, glass door, skylight and light  
 Recessed stainless steel bathroom sink  
 Porcelain toilet with foot flush  
 Powered roof vent in bathroom with wall switch  
 Walk-around, queen-size bed with bedspread and nightstands (king size in 27A)  
 Under-bed storage (select models)  
 Powered roof vent in bedroom with wall switch  
 Bedroom TV prep  
 Large wardrobes  
 Bunks with industry-exclusive 300-lb. capacity each (29F)

## STANDARD SAFETY EQUIPMENT

2-point lap safety belts in all designated seating locations  
 Smoke alarm  
 Carbon monoxide detector  
 Third brake light  
 Porch light

## OPTIONS

Drop-down overhead bunk in cab area with 750-lb. capacity  
 12-cu. ft. gas/electric refrigerator (N/A 26X)  
 Theater seating (26X, 29S, 31V)  
 Bedroom TV

## WARRANTY



## NO ONE OFFERS A BETTER WARRANTY

At Entegra Coach, we build our RVs to handle every adventure, then back them with our industry-leading 2+3 limited warranty. Our 2-year limited warranty has you covered for 2 camping seasons. That's 730 days. In addition, our 3-year structural limited warranty has you covered for 3 camping seasons or 1,095 days. You won't find a better limited warranty in the business, because the only strings we attach are those that deliver the ultimate in reliability. For a copy of our 2-year limited + 3-year structural limited warranty with complete terms and conditions, please contact your local Entegra Coach dealer.

| Floorplan | GVWR (lbs.) | GCWR (lbs.) | Wheel Base | Overall Length | Exterior Height w/ A/C & Satellite | Exterior Width | Interior Height | Fresh Water Capacity (gal.) | Grey Waste Water Capacity (gal.) | Black Waste Water Capacity (gal.) |
|-----------|-------------|-------------|------------|----------------|------------------------------------|----------------|-----------------|-----------------------------|----------------------------------|-----------------------------------|
| 26X       | 16,000      | 23,000      | 178        | 28' 5"         | 12' 5"                             | 101            | 84              | 53                          | 40                               | 32                                |
| 27A       | 18,000      | 23,000      | 190        | 29' 11"        | 12' 5"                             | 101            | 84              | 72                          | 50                               | 49                                |
| 29F       | 18,000      | 23,000      | 190        | 32' 2"         | 12' 5"                             | 101            | 84              | 72                          | 40                               | 49                                |
| 29S       | 18,000      | 23,000      | 190        | 31' 4"         | 12' 5"                             | 101            | 84              | 72                          | 40/9                             | 50                                |
| 31V       | 18,000      | 23,000      | 190        | 32' 2"         | 12' 5"                             | 101            | 84              | 72                          | 40                               | 50                                |

It is important for your safety and enjoyment that you are aware of the weights and tow ratings of the RV you select. Consult a competent advisor for questions or advice. Whether you are new to RVing or a veteran, get a feel for the performance of your RV before heading out on the roadways. When you tow a vehicle with your RV, you must drive differently than when you drive a single vehicle. Practice hooking up, driving, backing up and braking in a safe environment or seek out professional instruction. Jayco affixes a weight label to each RV which lists weight information for that vehicle. Refer to that label to verify the vehicle will meet your requirements. Gross Vehicle Weight Rating (GVWR): The maximum permissible weight of the motorhome, including the Unloaded Vehicle Weight (UVW) plus passengers, personal items, all cargo, fluids, options and dealer-installed accessories. The GVWR is equal to or greater than the sum of the UVW and the Cargo Carrying Capacity. Gross Combined Weight Rating (GCWR): The maximum allowable combined weight of the motorhome used as a tow vehicle and the attached towed vehicle.