

Sumova™

2002



Presenting the all-new Itasca Sunova. It's a new breed of motor home that opens wide the door to Class A comfort and accommodations. Loaded with standard features and plenty of available options, the Sunova is the perfect introduction to the Class A motor home lifestyle. As an Itasca product, Sunova is designed and built to the high standards that you would expect from Winnebago Industries. It's a motor home that you'll be proud to own and you'll take added delight in knowing you found the best value around. The 2002 Itasca Sunova — a refreshingly affordable Class A motor home.



Stitchcraft quality and innovation are yours with premium Stitchcraft furniture featured throughout the Sunova. You'll really appreciate relaxing in the new swivel/glider lounge chair. It's a standard Sunova feature.



27C SPRING MEADOW

EXPERIENCED RVers PREFER ITASCA motor homes for their innovative designs and reputation for quality. You'll find thoughtful features like the galley's Congoleum® vinyl flooring, a one-piece fabric ceiling and the convenient recessed **ONEPLACE™** Systems Center. Also included are many features that are simply not available in competitive models at this level — features like ceiling-ducted roof air with wall-mounted thermostat and floor-ducted heating for better climate control. Large, easy-to-operate wall-mounted switches control the strategically placed overhead lighting. Not to be forgotten, Sunova's **STOREMORE™** Slideout System allows interior cabinets and exterior storage compartments to extend with the slideroom for easy access to storage.



INTERIOR DECORS

SPRING MEADOW



SAHARA



PORTSMOUTH OAK
WOODGRAIN



Sunova
2002



27C



STOCKING UP is easy thanks to the food storage available in the double-door refrigerator/freezer and slideout pantry.



ALL THE ESSENTIALS for preparing a savory meal are at your fingertips when using the in-line galley. The touch control microwave and Magic Chef® three-burner range

with oven make meal preparation a snap. A flip-up countertop extension and cover for the recessed stainless steel sink provide additional workspace. Cabinet doors and drawers stay secure with positive catches and open easily with large 4" handles.



27C SPRING MEADOW

A GREAT NIGHT'S REST is just one benefit of a Class A bedroom. In addition to a walk-around queen-size bed with Serta® mattress, you'll find a large wardrobe, shirt closet and plenty of underbed and overhead cabinet storage.

THIS SPLIT BATH DESIGN provides a spacious bathroom area. The residential-height toilet features a foot-pedal flush for added convenience. The lavatory and medicine cabinets optimize storage space while a removable clothes rod in the shower provides additional hanging clothes storage when traveling.



WHEN YOU'RE READY TO TAKE A BREAK from the great outdoors, you'll appreciate the terrific view provided by the 19" TV. Entertainment options also include an available VCR and digital satellite system. Choose the 130 watt inverter and enjoy the TV and VCR even when you're not connected to shoreline or generator power. The beautiful Portsmouth Oak cabinetry is crafted with a combination of old world attention to detail and advanced computerized manufacturing that results in unparalleled fit, finish and durability.



27C SPRING MEADOW

DRIVING IS ONE OF THE JOYS of owning a motor home. Sunova enhances that experience with large, well-labeled dash controls all within easy reach. An available rearview monitor system ensures fearless backing. For your listening pleasure, an AM/FM radio with cassette comes standard.

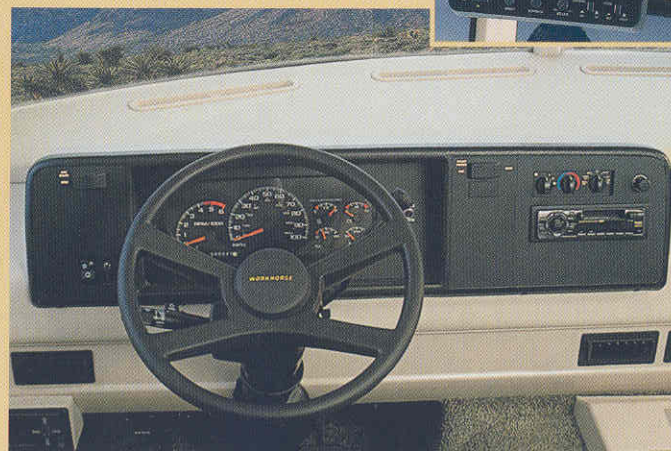

SIT BACK AND ENJOY THE RIDE in custom Stitchcraft driver and passenger seats. Designed with your comfort in mind, they feature high-back frames with fixed lumbar support, dual-position armrests, swivel/slide positioning and a multi-position recline function.



Stop worrying about water runoff dripping on your windows thanks to an innovative, built-in awning rail gutter system that drains water away from the entrance door and windows.

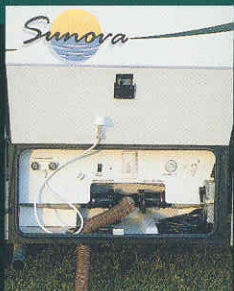

Convenience is the key to Sunova's service center. A heated holding tank compartment and water heater winterization bypass valve let you extend your camping season. An exterior wash station is also available for easy cleanups.



Towing is easy. The standard hitch offers a 5,000-pound towing capacity and 350-pound tongue weight to accommodate your towing needs.*



A standard 4,000 watt Onan® MicroQuiet™ generator provides ample 110 volt power when shoreline service is not available.

27C



AS THE NEWEST MEMBER OF THE ITASCA FAMILY, Sunova does not disappoint. The Thermo-Panel® one-piece fiberglass sidewalls are attractive, durable and easy to maintain. Basement storage provides plenty of space for gear and supplies. Leveling is effortless with the available Kwikiee® hydraulic jacks. And stainless steel wheel liners can be added for an additional touch of style.

COMPARTMENT LIGHTS illuminate stored items

ADVANCED SEAL-PLANE offers improved protection against the elements

GAS STRUTS assist in opening



SINGLE-PADDLE LATCH for easy, one-handed operation

ONE-PIECE METAL SKIN DOORS are an advanced, laminated composite design and construction, creating a door that is lightweight while still providing exceptional strength

STOREMORE



27C

THE STOREMORE SLIDEOUT SYSTEM is a Winnebago Industries original and is still the industry's premier slideout system. StoreMore allows for large storage compartments that accommodate oversized and odd-shaped items. They extend with the slideroom for easy access. The StoreMore Slideout System on the Sunova features a new electric slide mechanism. It's the first electric powered slideout system to meet our stringent quality and performance standards. Winnebago Industries engineers worked in conjunction with Kwikiee® Manufacturing to develop this powerful and reliable dual-ram/dual-motor technology that features electronic synchronization for improved room movement and better sealing, as well as built-in diagnostics for easier service.

NEW

27C

- Dinette/refrigerator
- **STOREMORE** Slideout System
- Swivel/glider lounge chair
- In-line galley
- Split bath/private shower
- Walk-around queen bed

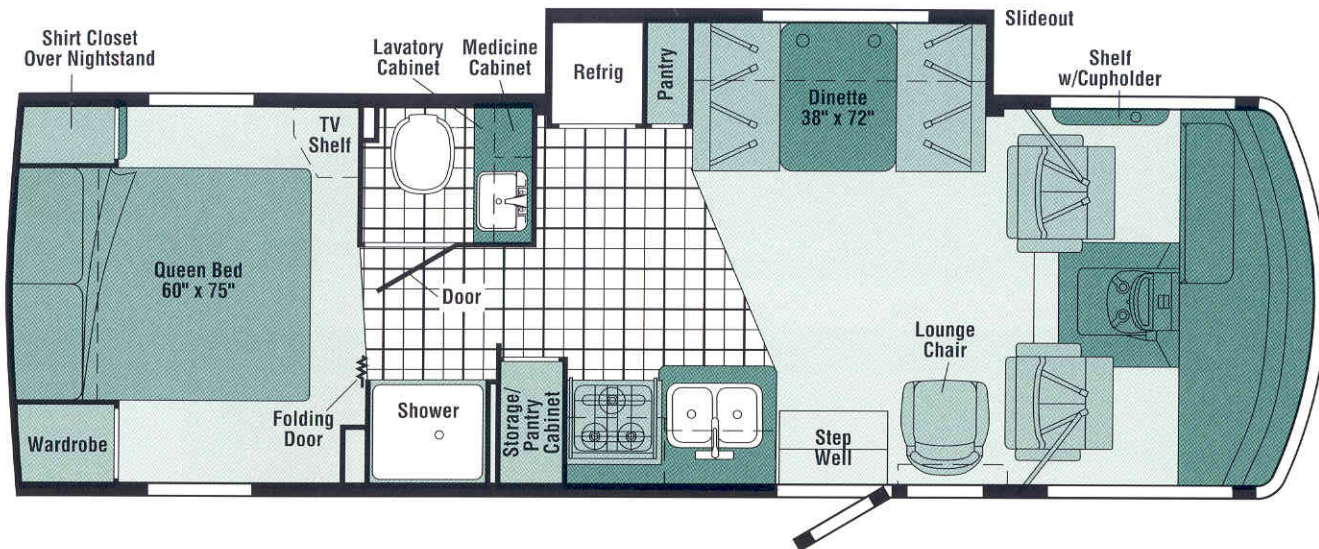

NEW

30B

- Couch/dinette
- **STOREMORE** Slideout System
- Swivel/glider lounge chair
- In-line galley
- Split bath/private shower
- Walk-around queen bed

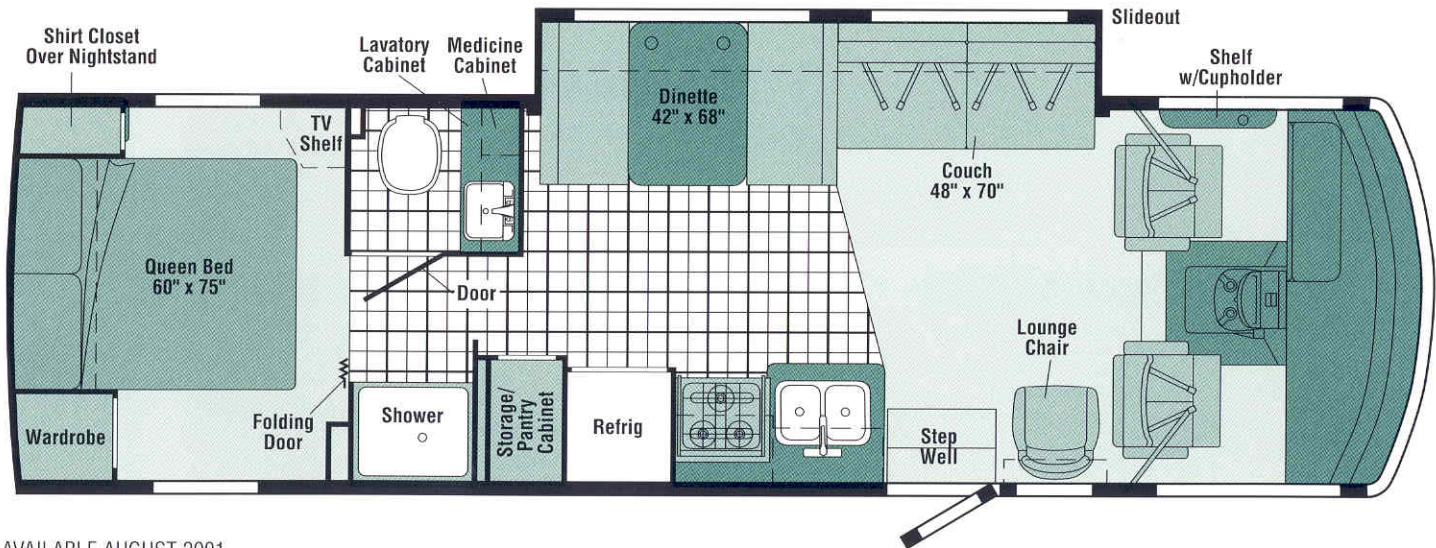

AVAILABLE AUGUST 2001



VINYL FLOORCOVERING



SEAT BELTS

Note: Dimensions shown are for sleeping space only and dashed lines denote overhead storage areas.



2002 SUNOVA SPECIFICATIONS

	27C	30B
Length	27'11"	30'10"
Exterior Height w/AC*	11'11"	11'10"
Exterior Width^	8'5.5"	8'5.5"
Exterior Storage (cu. ft.)	52	108
Interior Height	6'8"	6'8"
Interior Width	8'0.5"	8'0.5"
Fresh Water Capacity w/Heater* (gal.)	75	75
Holding Tank Capacity - Black/Gray (gal.)	41/40	41/40
LP Capacity (gal.)	18	18
Fuel Capacity - Std./Opt. (gal.)	40/NA	75/75
GCWR - Std./Opt. (lbs.)	19,000/NA	26,000/21,000
GVWR - Std./Opt. (lbs.)	14,800 Workhorse™/NA	18,000 Ford®/18,000 Workhorse™
GAWR - Front - Std./Opt. (lbs.)	5,500/NA	7,000/6,000
GAWR - Rear - Std./Opt. (lbs.)	10,000/NA	11,000/12,000
Wheelbase	158.5"	190"

ENTERTAINMENT

Radio (Cab) AM/FM stereo cassette, roof-mounted flexible rubber antenna, speakers (4), **Radio Power Switch** main/auxiliary battery, **Satellite System Ready**, **TV 19" Color AC** w/remote, **TV Enhancement Package** antenna (amplified), 12 volt powerpoint, interior jack(s), coax wiring, cable input, splitter, TV shelf

Radio (Cab) AM/FM stereo CD*

RV-RADIO™ (Cab) AM/FM stereo cassette/CD (available Fall 2001)*

Satellite Dish Antenna Winegard®; RV digital, elevation sensing unit

VCR w/remote

INTERIOR

Blinds mini (lounge, dinette), **Ceiling** textured fabric, **Clock**, **Curtain** front wraparound w/track, **Lights** reading, adjustable halogen (dinette & lounge chair overheads), ceiling, incandescent w/wall switches, **Picture**, **Shades** pleated (bedroom)

CABINERY

Woodgrain Portsmouth Oak stile-and-rail construction w/raised panel inserts on galley/lounge upper doors

COUNTERTOPS

Laminate w/wood-look edge

FLOORCOVERING

Carpeting w/pad, **Vinyl** bath & galley

FURNITURE

Lounge Chair hoop base, swivel/glider, **Dinette** access to storage below

Couch w/throw pillow

AUTOMOTIVE/CHASSIS

Chassis - Ford® 6.8L SOHC Triton® V-10 310 hp, 4-speed overdrive transmission, 4-wheel anti-lock brakes, 130 amp alternator

Chassis - Workhorse™ 8.1L Vortec V-8 340 hp, 4L80E 4-speed overdrive transmission, 4-wheel anti-lock brakes, 145 amp alternator

Tire spare, **Tire Tool** wrench, **Trailer Hitch*** 5000# draw bar/350# maximum vertical tongue weight & wiring, **Wheel Covers**

Leveling Jacks hydraulic - Kwikkee® w/touch pad control

Wheel Liners stainless steel

CAB AREA & DRIVER CONVENIENCES

Beverage Holder, **Cab Seats** (fabric) w/3 point shoulder & lap seat belts w/retractors, armrests, lumbar support, multi-adjustable slide/recline & swivel, **Cigarette Lighter/12 Volt Electrical Supply**, **Convenience Tray**, **Cruise Control**, **Map Light**, **Map Pocket**, **Steering Wheel** tilt w/power assist, **Sunvisors**, **Trim Panel** driver-side w/cupholder & storage tray, **Window** (driver & passenger) full slider w/screen, **Windshield Wipers** intermittent

Defroster Fans (2) auxiliary 2-speed w/instrument panel switch

Monitor System rearview w/single camera & 1-way audio, Videoman®



GALLEY	27C	30B
Countertop w/flip-up extension, Faucet single-control, Microwave Oven , Pantry , Range Hood w/light & fan, Range three-burner (one high-output) w/oven, Magic Chef® Refrigerator/Freezer double-door, Norcold®, Sink double, stainless steel w/sink cover (countertop material), Wall Border	S	S

BATH	27C	30B
Cabinets lavatory, medicine, Faucet (lavatory) dual-control, Faucet (shower) dual-control w/flexible shower head, Light shower, Mirror frameless w/beveled edge, Shower w/removable clothes rod, Shower Door folding, Shower Skylight , Sink rectangular, Tissue Holder , Toilet w/foot-pedal flush, Towel Rack 3-rod, mounted to door, Wall Border	S	S

BEDROOM	27C	30B
Bed queen, Serta® innerspring, w/underbed storage, Bedspring pillow shams, throw pillow, headboard, Lights decorative wall lamps, Nightstand , Shirt Closet , Wall Border , Wardrobe Cabinet carpeted, clothes rod, drawers	S	S

EXTERIOR	27C	30B
Awning Rails w/rain gutters, Door entrance w/separate screen door, deadbolt lock, Entrance Door Steps double, electric w/doorjamb switch, Light porch light w/interior switch, Mirrors manual adjust w/convex, Mudflaps front, Receptacle AC duplex, Sidewall Skin one-piece smooth fiberglass, Storage Compartments valance panels, gas strut, single-paddle latch, lights	S	S
Awning* patio	0	0
Ladder	0	0
Mirrors electric remote w/defrost	0	0
Undercoating Workhorse™ only	0	0

SYSTEMS	27C	30B
Automotive Heater/Air Conditioner , Auxiliary Start Circuit , Batteries (Coach) (2) deep cycle, Battery (Coach) disconnect system, Battery Charge Control automatic dual, Electrical Distribution System AC & DC breaker panels, 45 amp converter/charger, Furnace 30,000 BTU, low profile, Generator* 4,000 watt, Onan® MicroQuiet™ gas, ONEPLACE™ Systems Center wall-mount, battery condition gauge, generator hourmeter gauge, generator start/stop switch, heating/AC thermostat, holding tank levels, LP tank level, water heater light(s), water heater switch, water pump switch, water tank level, Power Cord 30 amp, Roof Vent powered, bath, Service Center city water hookup/tank diverter fill, drainage valves, sewer hose, cable input, power cord, Sewer Hose 10', Tank holding, heated compartment, Tank LP, permanent mount w/gauge, Water Heater 6-gallon, electronic ignition, LP gas, Water Heater Winterization Bypass Valve manual, Water Hookup city, Water Pump demand, Water System Winterization Valve , Water Tank Fill gravity	S	S
Air Conditioner (Roof) 13,500 BTU, ceiling-ducted w/wall thermostat	S	
Air Conditioner (Roof) 14,800 BTU, ceiling-ducted w/wall thermostat		S
Inverter* DC/AC, 130 watt	0	0
Wash Station exterior, w/pump switch located in service center	0	0
Water Heater 6-gallon, electronic ignition w/Motoraid & auxiliary auto heater	0	0

SLIDEOUT	27C	30B
Slideout Room dinette/refrigerator w/slidoor cover, STOREMORE®	S	
Slideout Room couch/dinette w/slidoor cover, STOREMORE®		S

SAFETY	27C	30B
Assist Handle exterior, Assist Strap interior, Bumpers front & rear, Detectors/Alarms LP leak, smoke, carbon monoxide, Fire Extinguisher 10 B.C., Ground Fault Interrupter , Light center high-mount stop lamp, Seat Belts cab, 3 point, Seat Belts lap (in selected areas), Window escape, Windshield laminated safety glass	S	S

WARRANTY	27C	30B
12-month/15,000-mile basic limited warranty , 36-month/36,000-mile warranty on structure , ** 10-year limited parts & labor warranty on roof	S	S

- The height of each model is based on the curb weight of a typically equipped unit on the standard chassis. The actual height of your vehicle may vary by as much as 2" depending on chassis or equipment variations.
- ^ Sunova floorplans feature a wide-body design — over 96". In making your purchase decision, you should be aware that some states restrict access on some or all state roads to 96" in body width. Before making your purchase decision, you should confirm the road usage laws in the states of interest to you.
- * Not all items available in combination. See dealer for details.
- ◇ Capacities shown are tank manufacturer's listed water capacity (W.C.). Actual filled LP capacity is 80% of listing due to overfilling prevention device on tank.
- NA Not Available
- S Standard
- O Optional
- + Actual towing capacity is dependent on your particular loading and towing circumstances which includes the GVWR, GAWR and GCWR as well as adequate trailer brakes. Please refer to your vehicle's operator's manual for further towing information.
- ** See your dealer for complete warranty documentation information.

Winnebago Industries' continuing program of product improvement makes specifications, equipment, model availability and prices subject to change without notice. Comparisons to other motor homes are based on the most recent information available.

NOT ALL MOTOR HOMES ARE CREATED EQUAL, and as you take a closer look, you'll see that there is much more to an Itasca Sunova than a long list of standard features and compelling floorplans. Beneath it all, you'll find a SuperStructure foundation of strength and durability.

**SUPER
STRUCTURE**

is the term given to Winnebago Industries' structural motor home design and construction. Rather than a single component, it is the culmination of design integration that incorporates steel and aluminum substructures, welded tubular steel floor risers, interlocking joint technology and Thermo-Panel® floor, roof and sidewalls to form a high-strength, durable vehicle body.

INTERLOCKING JOINT CONSTRUCTION

utilizes advanced extruded aluminum structural components to create integrated floor-to-sidewall and sidewall-to-roof joints. This design effectively distributes the weight of the walls and roof, making a stronger and more durable body than competitor designs which rely on screws to carry the weight.

TUBULAR STEEL RISERS

feature a truss-design core for superior strength and provide a stable base for the floor structure and storage compartments.

THE ALL STEEL CAB

features integral A and B pillars for added strength and stability.

WINDSHIELDS are mounted in steel with non-hardening sealants for superior strength, safety and durability. Some manufacturers actually use a rubber gasket to hold the windshield to a fiberglass cap.

STORAGE COMPARTMENTS

attach to outrigger assemblies so that the weight of stowed items is carried and dispersed throughout the foundation substructure.

A STEEL BARRIER separates occupants from the engine compartment. Believe it or not, less advanced designs actually use wood in this critical application.

THE FOUNDATION SUBSTRUCTURE ASSEMBLY

is precision-aligned to maximize strength and cross-coach support, as well as durability.

CRITICAL STEEL COMPONENTS are treated using an advanced electrodeposition coating process that provides superior corrosion protection.

1-YEAR OLD ITASCA FIBERGLASS ROOF



1-YEAR OLD COMPETITOR'S RUBBER ROOF



BUILT TO A HIGHER STANDARD. Sunova features a crowned, one-piece fiberglass roof, backed with a 10-year limited parts and labor warranty. Fiberglass offers superior strength, attractiveness and durability over the rubber roofs found on many competitive models. Over time, rubber roofs are susceptible to chalking, streaking and degradation, and have less puncture and tear resistance than fiberglass.

COMMITTED TO SERVICE. We back our motor homes with the best service after the sale in the industry.



TRIP Saver
Emergency Shipped Parts

- 12-month/15,000-mile basic limited warranty
- 36-month/36,000-mile warranty on structure
- Standard 10-year limited parts and labor roof warranty
- Complimentary 24-hour roadside assistance program
- TripSaver emergency warranty parts shipments
- National dealer service network



RECOGNIZED QUALITY. Recreation Vehicle Dealer Association members annually rate RV manufacturers on the quality of their products, sales and service support. We are proud to say that Winnebago Industries is the only major motor home manufacturer to be a recipient of the RVDAs Quality Circle award every year since its inception.



ALL MOTOR HOMES ARE NOT CREATED EQUAL. Learn more about what sets Winnebago Industries apart. Ask your dealer for this guide. It will help you learn what makes Winnebago Industries motor homes distinctly superior to other brands.

WARNING: JOINING WIT HAS BEEN KNOWN TO CAUSE EXCESSIVE FUN. Winnebago-Itasca Travelers (WIT) is a club for owners of Winnebago Industries motor homes. WIT is a great way to meet people and offers:



- Caravans and rallies
- Local and state group activities
- Benefits for RVers

www.winnebagoind.com

For Sales and Service Information Contact:



©2001 Winnebago Industries, Inc.



Printed in USA

Seat belts are your most important hookup. Always buckle up.