

Tradewinds LE

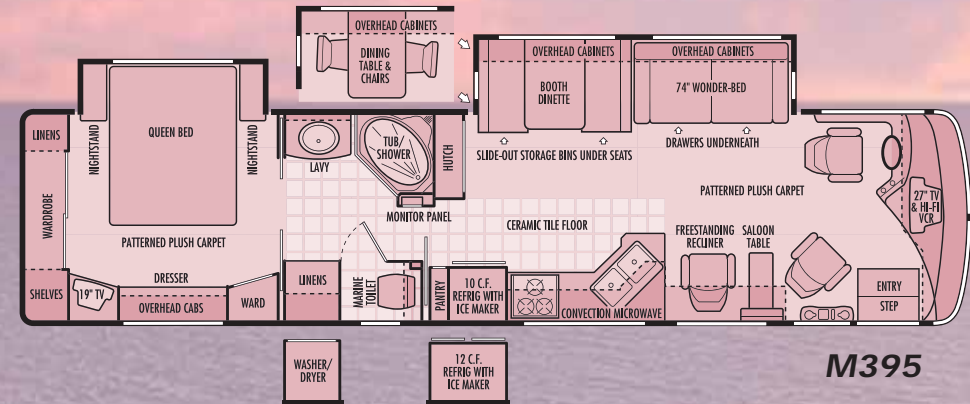
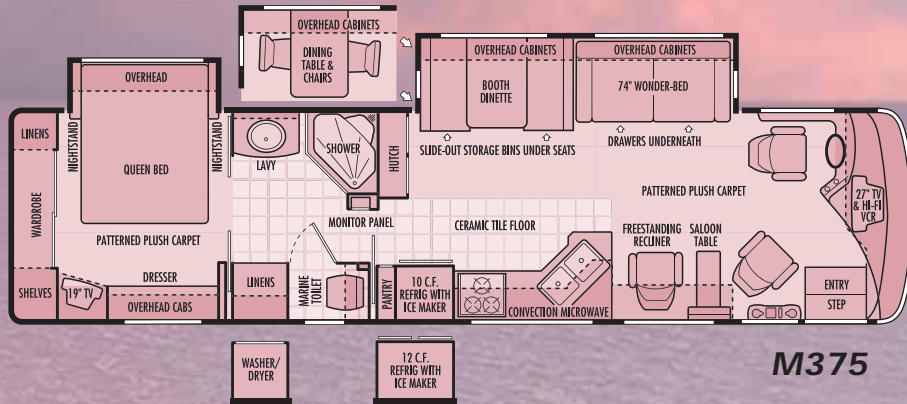
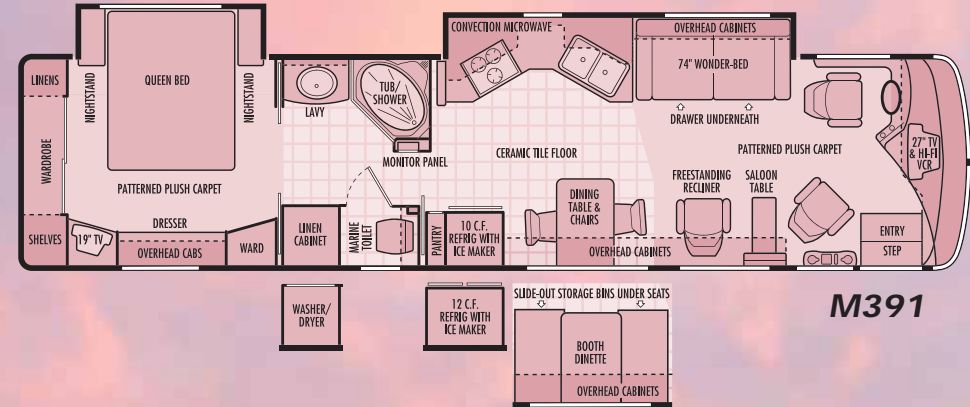
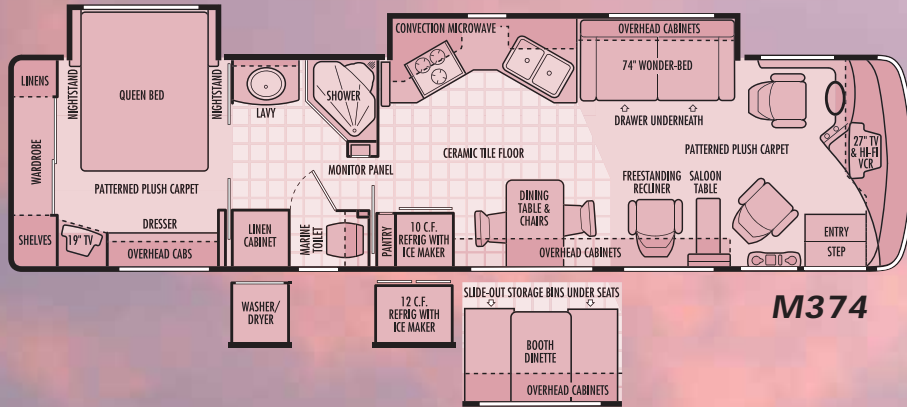

CHASSIS SPECIFICATIONS

	SPARTAN
Chassis	Spartan® Summit GTI (27,410 GVWR)
Chassis Design	Raised rail
Steering Gear	TRW TAS 55 power steering gear with 51° turning angle and 20.4:1 steering ratio
Tires	Michelin® radial tires 255/80R22.5(G)
Wheels	Steel wheels with stainless steel wheel simulators and valve extensions; 10 lugs
Service Brakes	Full air brakes with ABS; 15" x 4" front drums; 16.5" x 6" rear drums
Parking Brake	Spring applied, air release on rear drum brakes
Alternator	Leece-Neville® 160 Amp alternator
Chassis Batteries	Two BCI group 31 1,000 CCA

Front Suspension	Tuthill® independent front suspension
Rear Suspension	Reyco® 610AR 17,000 lb. capacity
Spring Type	Full air ride with dual ride height control valves and electronic manual air dump
Shock Absorbers	Tune Bilstein®
Driveline	Dana® Spicer 1610 series
Drive Axle	Meritor® RS-19-145
Drive Axle Ratio	4.88:1
Fuel Capacity	100 gallon fuel tank
Engine Block Heater	120V 1,000 watt engine block heater
Cooling Pack Mounting	Rear mounted
Charge Air Cooler	Cross flow
Transmission Oil Cooler	Integral to radiator; water to oil

Cooling Fan	Belt driven
Air Intake Restriction Indicator	Air intake restriction indicator
Other features	Frame mounted fuel/water separator
Towing Equipment	7,000 lb. Class III hitch receiver with skid bar and six-pin electrical connector
Chassis Warranty	2 years/50,000 miles
Engine	Caterpillar® 3126B
Displacement	7.2L
Peak Horsepower	330 HP @ 2,200 RPM
Peak Torque	860 lb/ft torque @ 1,440 RPM
Engine/Exhaust Brake	Pac Brake® exhaust brake
Engine Warranty	5 years/unlimited miles

Transmission	Allison® MH 3000
Transmission Type	Six speed automatic with 2 overdrive gears
Gear ratios	3.49:1 First gear 1.86:1 Second gear 1.41:1 Third gear 1.00:1 Fourth gear 0.75:1 Fifth gear 0.65:1 Sixth gear -5.03:1 Reverse
Transmission Shifter	T-handle electronic shifter with digital display
Transmission Warranty	3 years/unlimited miles



TRADEWINDS LE FEATURES & SPECIFICATIONS

BODY CONSTRUCTION

Duraframe® patented steel sub floor construction
Steel framed laminated floor
Steel framed crowned laminated fiberglass roof
Steel framed laminated fiberglass high gloss walls
Custom painted two color exterior graphics with choice of two color packages
Molded, high gloss, full fiberglass caps with integrated front and rear bumpers
Soft touch interior ceiling material
Electric slide-out rooms
Fiberglass exterior storage compartment doors, insulated with integrated paddle latches and struts
Aluminum rear ladder
Convenience D-Ring mounts in basement storage compartments
Automotive undercoating as required
Steel insulated front bulkhead

COCKPIT FEATURES

Pioneer® AM/FM stereo with CD player, XM™ receiver and remote control
Driver and passenger gooseneck reading lights
Custom dash in dark gray matte grid finish with full gauge package
Cockpit heater and air conditioner with dash controls
Convenience tray
Pantographic windshield wipers
Power steering
Electronic cruise control
18" tilt and telescopic steering wheel
Rear vision system with microphone
White power controlled heated exterior mirrors
Hydraulic leveling jacks with dash mounted controls
Passenger workstation with 12V receptacle and 110V receptacle
Aviation style sun visors
Cup holders
Two 2-speed dash fans
Electric stepwell cover
CB radio ready
Wraparound privacy curtain with easy reach wand

APPLIANCES & ACCESSORIES

RCA® 27" TV with front A/V jacks in cockpit
RCA® Hi-Fi VCR in cockpit
Multi-speaker TV sound
RCA® 19" TV with front A/V jacks in bedroom
10 cu. ft. double door refrigerator with icemaker and pantry
High output three burner cook top with flush mount Corian® range cover
GE® SpaceSaver convection microwave oven with carousel, built-in light and fan
Systems monitor panel
Cable TV hook-up and multiple telephone jacks
Wall mounted AM/FM stereo with CD, clock, alarm and inside temperature monitor in bedroom
Winegard® TV antenna

FURNITURE

Kustom Fit® fabric 6-way power driver recliner seat with swivel base and integrated seatbelt
Kustom Fit® fabric passenger recliner seat with swivel base and integrated seatbelt
Kustom Fit® 74" Wonder-Bed® sleeper sofa with slide-in armrests and drawer underneath
Freestanding Kustom Fit® fabric swivel recliner chair with footrest

INTERIORS

Throughout Coach

Maple paneling and doors
Solid wood raised panel cabinet doors and face framing
Deluxe overhead storage doors with telestrut hardware; positive catches on all other doors
Drawers with ball bearing roller guide design

Cockpit Area

Floormats

Living Area

Patterned plush carpet with deluxe pad
Pleated day/night shades
Valances and lambrequins
Magazine rack
Freestanding dinette table with two low-back wooden chairs (M374 and M391)
Booth dinette with slide-out storage drawers (M375 and M395)

Kitchen Area

Corian® kitchen countertop with Corian® sink cover
Slide-out pantry
Wastebasket
Silverware organizer
Ceramic tile floor
Venetian blind and valance

Bath Area

Ceramic tile floor
Corian® edged bathroom lavatory
Raised panel doors
Insulated skylight in shower
Towel bars
Medicine cabinet
Window in private toilet room
Residential style pocket doors
Residential toilet room door with hardware

Bedroom Area

Patterned plush carpet with deluxe pad
Venetian mini-blinds
Valances and lambrequins
Raised panel doors
"Sandpiper Deluxe" residential-style pillow top mattress
Queen bed slide-out
Coordinate bedspread, pillows and shams
Radius padded headboard
Nightstands with Corian® edged tops
Cedar lining in wardrobe
Rear wardrobe with mirrored sliding doors

Wall dresser with drawers and laundry hamper
Residential style closet rods

ELECTRICAL SYSTEMS & LIGHTS

50 Amp 120V distribution panel and cord
50 Amp shore power cord
Dual 10 watt solar panels
Onan® 6.5 kW LP generator
2,000 watt inverter/converter with remote on/off switch
Four 6V deep cycle house batteries
Slide-out battery tray
Two 760 CCA 12V maintenance-free chassis batteries
Battery disconnect switch
Porch light
Patio receptacle
Three water pump switches (kitchen, bath and service station)
Decorative overhead dining light
Cosmetic light in bathroom
Decorative lights in living area
Courtesy light at entry-door switch panel
Fluorescent lights in ceiling

PLUMBING & LPG SYSTEMS

Coach Exterior

Heated and insulated holding and water tanks
Manual dump valves
Pressurized water fill with regulator
Variable rate water pump
Water heater by-pass valve
Winterization antifreeze inlet to pump
Holding tank rinsing system (waste tank only)
Outside shower

Kitchen Area

Water filter in kitchen
10 gallon gas/electric water heater
Delta® single lever faucet with side sprayer

Bedroom/Bathroom Area

Porcelain toilet with sprayer
Clear glass shower enclosure with etched decorative design for privacy
One piece fiberglass tub and shower
Single lever brass faucet with crystal handle
Pre-plumbed for washer/dryer

SAFETY FEATURES

Fire extinguisher
Deadbolt lock on entrance door
12V GFI protected circuits (kitchen, bath and exterior)
Smoke, carbon monoxide (CO) and LPG detectors
Driver and passenger integrated three point lap and shoulder seatbelts
Egress window
Deluxe acrylic exterior assist handle

WINDOWS, DOORS & AWNINGS

Tinted dual pane windows
Power double entrance step with light and anti-skid

Tinted skylight in bathroom
Manual patio awning with metal cover*
Slide-out topper awnings on living room, galley slide and bedroom slide*

VENTILATION

Dual 13,500 BTU Duo-Therm® low profile Penguin® air conditioners with in-ceiling ducting
35,000 BTU furnace
12V fan in bathroom
12V Fan-Tastic® Vent with wall thermostat and rain sensor in living area

OPTIONAL FEATURES

Exterior

Upgraded custom painted two color exterior graphics with choice of two color packages (includes painted to match power controlled heated exterior mirrors)
Manual front entry door awning*
Manual living room and bedroom window awning package
Onan® 7.5 kW Quiet Diesel generator
Dual 13,500 BTU Duo-Therm® low profile Penguin® air conditioners with heat pumps, two-speed fans and in-ceiling ducting

Throughout Coach

Walnut paneling and doors

Cockpit Area

Pioneer® multi-disc CD changer
RCA® DVD player
Kingdome® automatic stationary satellite dish
Roof mounted dual chrome trumpet air horns

Furniture

Kustom Fit® leather 6-way power driver recliner seat with swivel base and integrated seatbelt and Kustom Fit® leather passenger recliner seat with swivel base and integrated seatbelt
Kustom Fit® leather 6-way power driver recliner seat with swivel base and integrated seatbelt and Kustom Fit® leather extra-wide passenger recliner seat with swivel base and integrated seatbelt
Kustom Fit® 74" leather Wonder-Bed® sleeper sofa with slide-in armrests and drawer underneath
Freestanding Kustom Fit® leather swivel recliner chair with footrest
Booth dinette with slide-out storage drawers (M374 and M391)

Living Area

Two wooden folding dining chairs
Freestanding dinette table with two low-back wooden chairs (M375 and M395)
Booth dinette with slide-out storage drawers (M374 and M391)

Kitchen Area

21" high output three burner range and oven
12 cu. ft. side-by-side refrigerator with ice maker (delete slide-out pantry)

Bedroom/Bathroom Area

Combination washer/dryer

WEIGHTS (POUNDS)	M374	M375	M391	M395
Spartan GTI				
Gross Vehicle Weight Rating	27,400 lbs.	27,400 lbs.	27,400 lbs.	27,400 lbs.
Gross Combined Weight Rating	32,400 lbs.	32,400 lbs.	32,400 lbs.	32,400 lbs.
Front Gross Axle Weight Rating	10,410 lbs.	10,410 lbs.	10,410 lbs.	10,410 lbs.
Rear Gross Axle Weight Rating	17,000 lbs.	17,000 lbs.	17,000 lbs.	17,000 lbs.
Unloaded Vehicle Weight	23,180 lbs.	23,530 lbs.	22,600 lbs.	23,960 lbs.
Maximum Carrying Capacity	4,220 lbs.	3,870 lbs.	4,800 lbs.	3,440 lbs.
Cargo Carrying Capacity	2,484 lbs.	2,134 lbs.	3,064 lbs.	1,704 lbs.
MEASUREMENTS	M374	M375	M391	M395
Wheelbase	228"	228"	252"	252"
Overall Length	37' 1"	37' 1"	39' 1"	39' 1"
Exterior Height (Road Height)	12' 2"	12' 2"	12' 2"	12' 2"
Exterior Height (with Satellite)	12' 8"	12' 8"	12' 8"	12' 8"
Interior Height	79 1/2"	79 1/2"	79 1/2"	79 1/2"
Interior Width	98"	98"	98"	98"
Exterior Width	102"	102"	102"	102"
TANK CAPACITIES	M374	M375	M391	M395
Water Heater	10 gal.	10 gal.	10 gal.	10 gal.
Gray Tank	40 gal.	40 gal.	40 gal.	40 gal.
Black Tank	45 gal.	45 gal.	45 gal.	45 gal.
Fresh Water Tank(s)	95 gal.	95 gal.	95 gal.	95 gal.
LPG Tank (Volume W.C.)	69 gal.	69 gal.	69 gal.	69 gal.