

# Tradewinds LTC

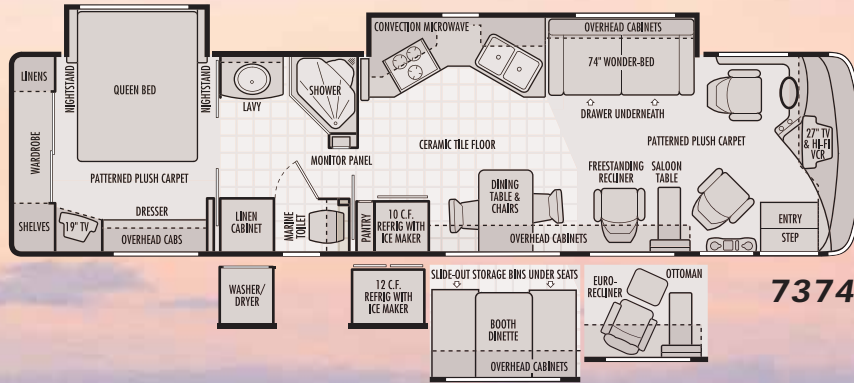

7374

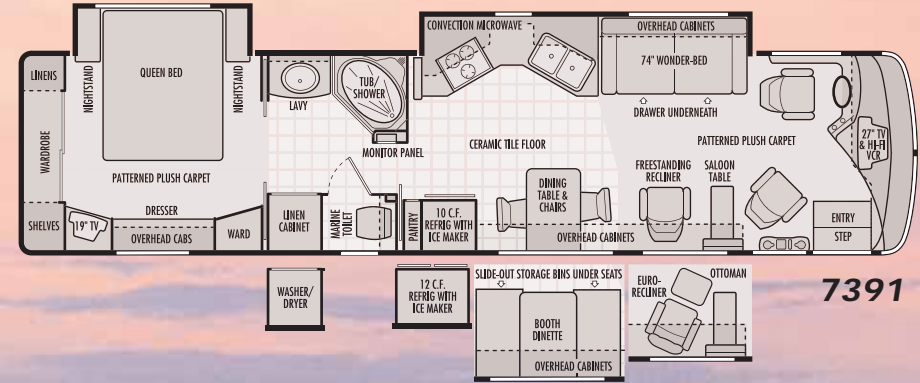

7391

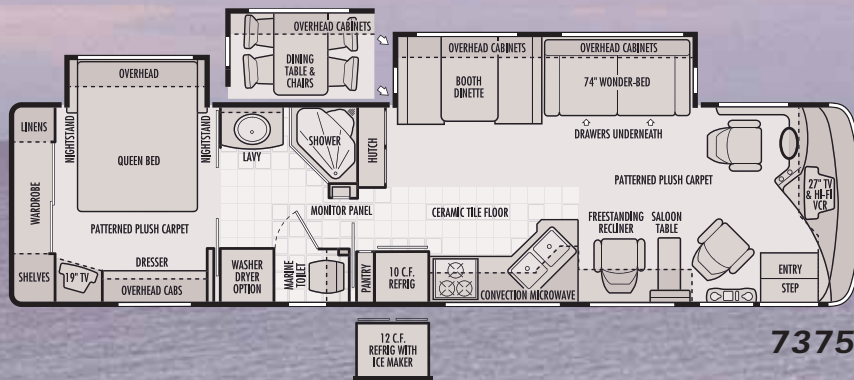

7375

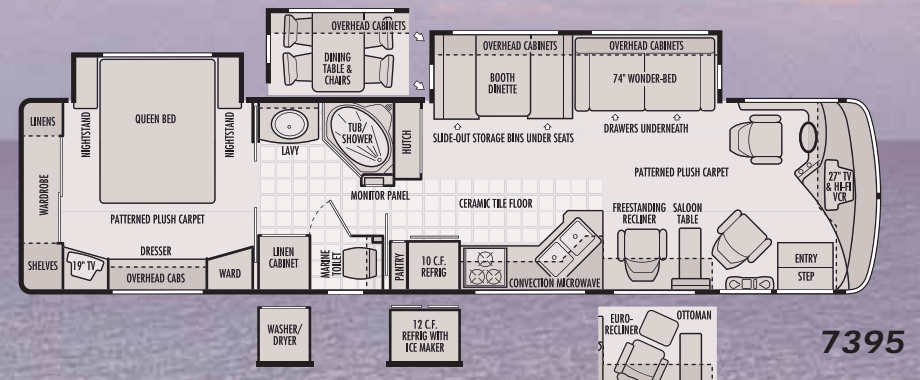

7395



CHASSIS SPECIFICATIONS	DYNAMAX
<b>Chassis</b>	Country Coach Dynamax®
<b>Chassis Design</b>	Dynomax® 8TD <sup>x</sup> tube frame chassis system by Country Coach
<b>Steering Gear</b>	TRW TAS 85 integral hydraulic power steering gear with 95° possible turning angle and 23.5:1 steering ratio
<b>Tires</b>	Steel belted radial tires Toyo® 275R x 22.5 (H)
<b>Wheels</b>	Four 8¼" x 22½" aluminum alloy wheels; two inner dual steel wheels; 10 lug
<b>Service Brakes</b>	Full air brakes with ABS; 16.5" x 7" drums (rear) s-cam style, automatic slack adjusters

<b>Parking Brake</b>	Spring applied, air release on rear drum brakes
<b>Alternator</b>	Leece-Neville® 160 Amp alternator
<b>Chassis Batteries</b>	Group 8 battery with slide-out tray 1,000 CCA engine (4) each 240AH house batteries Manual chassis battery disconnect
<b>Front Suspension</b>	Neway® independent front suspension
<b>Rear Suspension</b>	Neway® AD-200 20,000 lb. capacity
<b>Spring Type</b>	Neway® full air suspension system with electric air dump
<b>Shock Absorbers</b>	Koni® model 88
<b>Driveline</b>	Dana Spicer® 1710 series
<b>Drive Axle</b>	Meritor® RS-21-145
<b>Drive Axle Ratio</b>	4.63:1
<b>Fuel Capacity</b>	110 gallon fuel tank; Fleetguard® fuel/water separator

<b>Engine Block Heater</b>	120V 1,000 watt engine block heater
<b>Cooling Pack Mounting</b>	Side mounted
<b>Charge Air Cooler</b>	Cross flow
<b>Transmission Oil Cooler</b>	Remote mounted; water to oil
<b>Cooling Fan</b>	Variable speed hydraulic
<b>Air Intake Restriction Indicator</b>	Filter Minder®
<b>Other features</b>	Curbside access to service center
<b>Fueling Equipment</b>	Fuel/water separator remote mounted in utility compartment
<b>Towing Equipment</b>	10,000 lb. Class III hitch receiver with skid bar and six-pin electrical connector
<b>Chassis Warranty</b>	2 years/unlimited miles
<b>Engine</b>	Cummins® ISC
<b>Displacement</b>	8.3L
<b>Peak Horsepower</b>	350 HP @ 2,000 RPM

<b>Peak Torque</b>	1,050 lb/ft torque @ 1,400 RPM
<b>Engine/Exhaust Brake</b>	Cummins® extarder exhaust brake
<b>Engine Warranty</b>	5 year/100,000 miles
<b>Transmission</b>	Allison® MH 3000
<b>Transmission Type</b>	Six speed automatic with 2 overdrive gears
<b>Gear ratios</b>	3.49:1 First gear 1.86:1 Second gear 1.41:1 Third gear 1.00:1 Fourth gear 0.75:1 Fifth gear 0.65:1 Sixth gear -5.03:1 Reverse
<b>Transmission Shifter</b>	Keypad electronic shifter with digital display
<b>Transmission Warranty</b>	3 years/unlimited miles

Due to continued product improvement, National R. V., Inc. reserves the right to change materials, colors, specifications and prices at any time without notification. Copyright © 2002 by National R. V., Inc. 07/02

# TRADEWINDS LTC FEATURES & SPECIFICATIONS

## BODY CONSTRUCTION

Duraframe® patented steel sub floor construction  
 Steel framed laminated floor  
 Steel framed crowned laminated fiberglass roof  
 Steel framed laminated fiberglass high gloss walls  
 Custom painted three color full body exterior graphics with choice of three color packages  
 Molded, high gloss, full fiberglass caps with integrated front and rear bumpers  
 Soft touch interior ceiling material  
 Electric slide-out rooms  
 Fiberglass exterior storage compartment doors, insulated with integrated paddle latches and struts  
 Aluminum rear ladder  
 Convenience D-Ring mounts in basement storage compartments  
 Automotive undercoating as required  
 Steel insulated front bulkhead

## COCKPIT FEATURES

Pioneer® AM/FM stereo with CD player, XM™ receiver and remote control  
 Driver and passenger gooseneck reading lights  
 Custom dash in high gloss walnut finish with full gauge package  
 Cockpit heater and air conditioner with dash controls  
 Convenience tray  
 Auxiliary driving lights  
 Pantographic windshield wipers  
 Power steering  
 Electronic cruise control  
 18" tilt and telescopic steering wheel  
 Roof mounted dual chrome trumpet air horns  
 Rear vision system with microphone  
 Painted to match power controlled heated exterior mirrors with power convex control  
 Power Gear® fully automatic leveling jacks  
 Passenger workstation with 12V receptacle and 110V receptacle  
 Aviation style sun visors  
 Cup holders  
 Two 2-speed dash fans  
 Electric stepwell cover  
 CB radio ready  
 Wraparound privacy curtain with easy reach wand

## APPLIANCES & ACCESSORIES

RCA® 27" TV with front A/V jacks in cockpit  
 RCA® Hi-Fi VCR in cockpit  
 Multi-speaker TV sound  
 RCA® 19" TV with front A/V jacks in bedroom  
 10 cu. ft. double door refrigerator with icemaker and pantry  
 High output three burner cook top with flush mount Corian® range cover  
 GE® SpaceSaver convection microwave oven with carousel, built-in light and fan  
 Systems monitor panel  
 Cable TV hook-up and multiple telephone jacks  
 Wall mounted AM/FM stereo with CD, clock, alarm and inside temperature monitor in bedroom

Kingdome® automatic stationary satellite dish  
 Winegard® TV antenna

## FURNITURE

Kustom Fit® monogrammed UltraLeather™ 6-way power driver recliner seat with swivel base and integrated seatbelt  
 Kustom Fit® monogrammed UltraLeather™ passenger recliner seat with swivel base and integrated seatbelt  
 Kustom Fit® 74" Wonder-Bed™ fabric sleeper sofa with slide-in armrests and drawer underneath  
 Freestanding Kustom Fit® fabric swivel recliner chair with footrest

## INTERIORS

### Throughout Coach

Maple paneling and doors  
 Solid wood raised panel cabinet doors and face framing  
 Deluxe overhead storage doors with telescruit hardware; positive catches on all other doors

Drawers with ball bearing roller guide design

### Cockpit Area

Patterned floor mats

### Living Area

Fabrica® patterned plush carpet with deluxe pad  
 Pleated day/night shades  
 Valances and lambrequins  
 Magazine rack  
 Freestanding Corian® topped dinette table with two high-back wooden chairs and two wooden folding chairs

### Kitchen Area

Corian® kitchen countertop with Corian® sink cover  
 Corian® surface countertop extension (lounge slides only)  
 Wastebasket  
 Silverware organizer  
 Beveled mirror galley backsplash  
 Ceramic tile floor  
 Venetian blind and valance

### Bath Area

Ceramic tile floor  
 Corian® surface bathroom lavatory  
 Porcelain oval lavatory sink  
 Raised panel doors  
 Insulated skylight in shower  
 Towel bars  
 Medicine cabinet  
 Window in private toilet room  
 Residential style pocket doors  
 Residential toilet room door with hardware

### Bedroom Area

Fabrica® patterned plush carpet with deluxe pad  
 Pleated day/night shades  
 Valances and lambrequins  
 Raised panel doors  
 "Beachcomber Premium" residential-style pillow top mattress  
 Queen bed slide-out  
 Coordinate bedspread, pillows and shams

Radius padded headboard  
 Nightstands with Corian® tops  
 Cedar lining in wardrobe  
 Rear wardrobe with mirrored sliding doors  
 Wall dresser with drawers and laundry hamper  
 Residential style closet rods

## ELECTRICAL SYSTEMS & LIGHTS

50 Amp 120V distribution panel and cord  
 50 Amp shore power cord  
 Dual 21 watt solar panels  
 Onan® 6.5 kW LP generator  
 2,000 watt inverter/converter with remote on/off switch  
 Four 6V deep cycle house batteries  
 Slide-out battery tray  
 Two 760 CCA 12V maintenance-free chassis batteries  
 Battery disconnect switch  
 Porch light  
 Patio receptacle  
 Three water pump switches (kitchen, bath and service station)  
 Decorative overhead dining light  
 Cosmetic light in bathroom  
 Decorative lights in living area  
 Courtesy light at entry-door switch panel  
 Fluorescent lights in ceiling  
 Decorative indirect mood lights

## PLUMBING & LPG SYSTEMS

### Coach Exterior

Heated and insulated holding and water tanks  
 Manual dump valves  
 Pressurized water fill with regulator  
 Variable rate water pump  
 Water heater by-pass valve  
 Winterization antifreeze inlet to pump  
 Holding tank rinsing system (waste only)  
 Outside shower

### Kitchen Area

Water filter in kitchen  
 10 gallon gas/electric water heater  
 Delta® single lever faucet with pullout sprayer

### Bedroom/Bathroom Area

Porcelain toilet with sprayer  
 Clear glass shower enclosure with etched decorative design for privacy  
 One piece fiberglass tub and shower  
 Single lever brass faucet with crystal handle  
 Pre-plumbed for washer/dryer

## SAFETY FEATURES

Fire extinguisher  
 Deadbolt lock on entrance door  
 12V GFI protected circuits (kitchen, bath and exterior)  
 Smoke, carbon monoxide (CO) and LPG detectors  
 Driver and passenger integrated three point lap and shoulder seatbelts  
 Egress window  
 Deluxe acrylic exterior assist handle

## WINDOWS, DOORS & AWNINGS

Tinted dual pane windows  
 Power double entrance step with light and anti-skid  
 Tinted skylight in bathroom  
 Electric patio awning with metal cover\*  
 Electric front entry door awning\*  
 Slide-out topper awnings on living room, galley slide and bedroom slide\*

## VENTILATION

Dual 13,500 BTU Duo-Therm® low profile Penguin® air conditioners with in-ceiling ducting  
 35,000 BTU and 20,000 BTU furnaces  
 12V Fan-Tastic® Vent in bathroom  
 12V Fan-Tastic® Vent with wall thermostat and rain sensor in living area

## OPTIONAL FEATURES

### Exterior

Upgraded custom painted three color full body exterior graphics with choice of three color packages  
 Dual directional roll-out compartment storage tray  
 Manual living room and bedroom window awning package  
 Onan® 7.5 kW Quiet Diesel generator  
 Dual 13,500 BTU Duo-Therm® low profile Penguin® air conditioners with heat pumps, two-speed fans and in-ceiling ducting  
 Chrome power controlled heated exterior mirrors with power convex control

### Throughout Coach

Walnut paneling and doors

Cherry paneling and doors

### Cockpit Area

Pioneer® multi-disc CD changer  
 Douglas® tilt and telescoping steering column with 18" VIP® Smart Wheel  
 RCA® DVD with Dolby Digital 5.1 receiver and home theater speaker package

### Furniture

Kustom Fit® monogrammed UltraLeather™ 6-way power passenger recliner seat with swivel base, integrated seatbelt and power footrest  
 Kustom Fit® monogrammed UltraLeather™ 6-way power extra-wide passenger recliner seat with swivel base, integrated seatbelt and power footrest  
 Kustom Fit® 74" UltraLeather™ Wonder-Bed® sleeper sofa with slide-in armrests and drawer underneath  
 Freestanding Kustom Fit® UltraLeather™ Euro-recliner with ottoman  
 Freestanding Kustom Fit® UltraLeather™ swivel recliner chair with footrest  
 Corian® topped booth dinette with slide-out storage drawers

### Kitchen Area

GE Advantium™ oven/microwave  
 12 cu. ft. side-by-side refrigerator with ice maker (delete slide-out pantry)

### Bedroom/Bathroom Area

Combination washer/dryer  
 Thetford® electric porcelain toilet with sprayer

WEIGHTS (POUNDS)	7374	7375	7391	7395
<b>Dynamax</b>				
Gross Vehicle Weight Rating	32,800 lbs.	32,800 lbs.	32,800 lbs.	32,800 lbs.
Gross Combined Weight Rating	42,800 lbs.	42,800 lbs.	42,800 lbs.	42,800 lbs.
Front Gross Axle Weight Rating	12,800 lbs.	12,800 lbs.	12,800 lbs.	12,800 lbs.
Rear Gross Axle Weight Rating	20,000 lbs.	20,000 lbs.	20,000 lbs.	20,000 lbs.
Unloaded Vehicle Weight	25,580 lbs.	TBD	TBD	TBD
Maximum Carrying Capacity	7,220 lbs.	TBD	TBD	TBD
Cargo Carrying Capacity	5,579 lbs.	TBD	TBD	TBD
<b>MEASUREMENTS</b>				
Wheelbase	228"	228"	252"	252"
Overall Length	36' 8"	36' 8"	TBD	TBD
Exterior Height (Road Height)	12'	12'	TBD	TBD
Exterior Height (with Satellite)	12' 4"	12' 4"	TBD	TBD
Interior Height	79 1/2"	79 1/2"	79 1/2"	79 1/2"
Interior Width	98"	98"	98"	98"
Exterior Width	102"	102"	102"	102"
<b>TANK CAPACITIES</b>				
Water Heater	10 gal.	10 gal.	10 gal.	10 gal.
Gray Tank	40 gal.	40 gal.	40 gal.	40 gal.
Black Tank	45 gal.	45 gal.	45 gal.	45 gal.
Fresh Water Tank(s)	95 gal.	95 gal.	95 gal.	95 gal.
LPG Tank (Volume W.C.)	42.7 gal.	42.7 gal.	42.7 gal.	42.7 gal.

\*Not available on CSA units