

BEAVER PATRIOT® THUNDER

2007

BEAVER PATRIOT® THUNDER | 2007



BEAVER PATRIOT® THUNDER | 2007

We'll have you at hello.

It's nearly impossible to deny the appeal of the 2007 Beaver's Patriot Thunder. Once you lay eyes on its rich decor or feel the power of its awesome 525 HP Cat® engine, no other coach will do. We dare you to feel the high-gloss cabinetry and not be touched by the craftsmanship. We challenge you to stroll across the ceramic tile and textured carpet and then try to walk away. Or, have a seat on any of the comfortable, yet stylish, furniture — including the 6-way power OptimaLeather™ pilot and co-pilot seats — and try not to feel right at home. It's almost not fair to the other RVs out there.



BEAVER SELECT WOODS

Countless hours of hard work go into creating Beaver's famous hardwood cabinets — work we don't entrust to just anyone. We employ craftsmen who are not only highly skilled but also love what they do. It's a difference you'll see in the cut of the wood, the detail of the inlays and the one-of-a-kind finish.





FULL-WALL SLIDE

▼ PANASUITE™



PanaSuite™ delivers maximum unobstructed living space.

WAIT, THERE'S MORE.

The Patriot Thunder has even more to offer, thanks to the PanaSuite™ full-wall slide. Available on the 44 Winchester III floorplan, PanaSuite creates more room and wider aisles with a single slide that stretches almost the entire length of the RV, for a satisfying, open feeling throughout.





Looks aren't everything.

Behind these great looks you'll find superior performance. The beautiful kitchen cabinets house smart features like low-friction roller drawer guides, lined shelves and a large pan drawer. Appliances offer good looks and efficiency — the two-door refrigerator has an in-door ice and water dispenser and the Spacesaver microwave doubles as a convection oven. The sofa does double duty as well, quickly transforming to a comfortable sleeper with the option of an air mattress. The private bath has both looks and room to spare, and comes with the luxurious option of a bathtub.

BEAVER PATRIOT® THUNDER | 2007

Miles away from everyday.

With Patriot Thunder, life on the road can be whatever you want it to be. Bring out your inner romantic with special dinners for two enjoyed on the side-slide dinette table with freestanding chairs. You can enjoy complete privacy with blackout day/night pleated shades found in the living area and bedroom.



TAKE IT OUTDOORS.



Make the most of the outdoors with the optional Girard® Awning package and exterior 32" LCD TV. There's plenty of exterior storage space, so you can bring along your favorite outdoor furniture. And when it's time to get moving, the automotive dash puts all the controls conveniently at your fingertips, including safety measures like a rear vision system with color monitor.



ROADMASTER AND CHASSIS CONSTRUCTION

It's all riding on a Roadmaster.

Ask any Beaver owner, and they'll tell you — it's the Roadmaster chassis that makes the difference. That's because the Roadmaster is custom-built to the exact specifications of each Beaver model and floorplan. You see, Roadmaster has a 100% commitment to only producing luxury motorhome chassis — and that's something no other manufacturer can say. We invite you to take a closer look at the highlights of the Patriot's incomparable S-Series semi-monocoque chassis. You'll find that it leads the way in safety, performance, convenience and reliability.

POWERED BY CATERPILLAR®

Beaver is proud to offer Caterpillar® 525 HP C-13 engines with ACERT® technology. Road tested for millions of miles, Cat® engines offer unbeatable reliability and durability. Plus, a Cat® with ACERT® technology gives you high performance with the lowest operating costs in the industry. In fact, its maintenance intervals are 30,000 miles, compared with 25,000 for other engines. The C-13 outperforms the competition in horsepower and torque and features the tremendous responsiveness of series turbo charging. The Cat® is also backed by an industry-leading 5-year/200,000 mile warranty with no deductible. And finally, ACERT® technology gives you the cleanest running engine available — and is fully compliant with EPA-mandated standards.

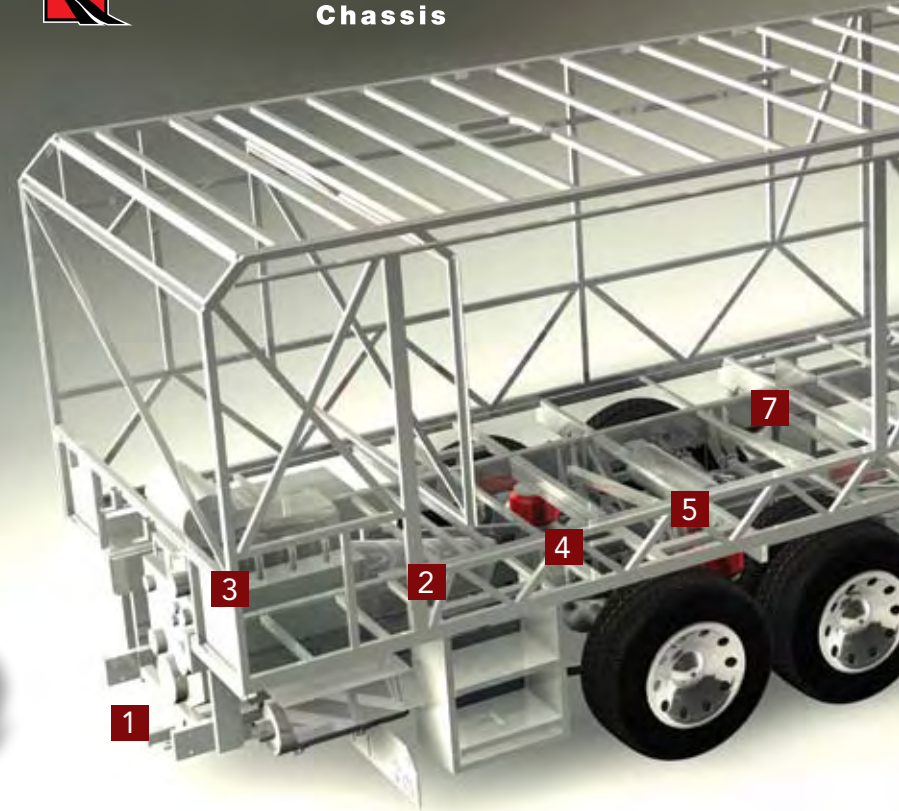

- 1 10,000 lb. hitch receiver offers powerful towing capacity with 7/4-way trailer plug. The coach also has a new pre-wire for a supplemental braking system.
- 2 The three-point engine mounting system lowers the coach's center of gravity and reduces the amount of vibration that reaches the coach. The mounting also makes the engine easier to service by allowing the engine to be easily lowered through the bottom of the coach.
- 3 Caterpillar® 525 HP ACERT® C-13 Engine.
- 4 Allison® 3000 MH 6-speed transmission (Thunder Package: 4000 MH 6-speed transmission) for smooth shifting; our exclusive use of synthetic transmission fluid allows for up to three-year maintenance intervals.
- 5 Cushion Air-Glide Platinum suspension system positions ten Bilstein® shocks and ten air bags, eight of which are outboard mounted with auto-leveling for greater stability, a smoother ride and the best handling in its class.
 - Unique three-degree rear axle tilt perfectly aligns the engine, transmission and differential, minimizing stress on the drivetrain and reducing noise and vibration in the coach.
 - Automatic Traction Control (ATC) eliminates wheel slippage in slick conditions and heightens control.
 - Tag axle lifts for added maneuverability in tight spots.



Aladdin™ makes it easy to keep track of many important functions, including tank levels, temperatures, mileage and much more.



With the optional GPS navigation system, you're free to explore the middle of nowhere and always know exactly where you are.

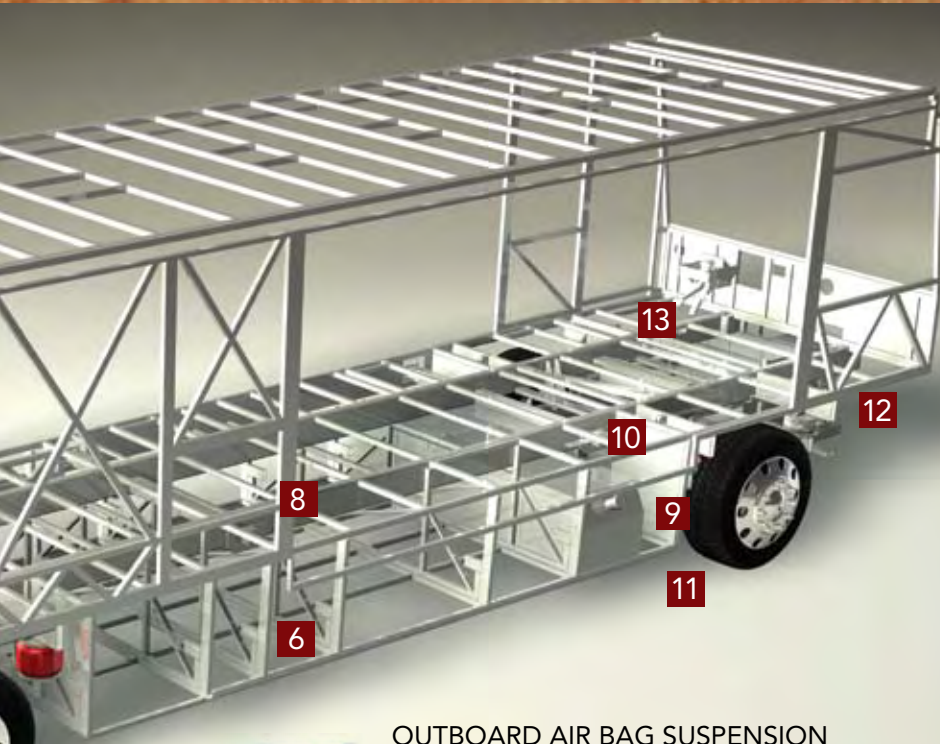

OUTBOARD AIR BAG SUSPENSION

The outboard-mounted air bags are protected by two steel plates and are placed farther apart than the competition, providing a wider, more stable platform for the coach. The active suspension automatically adjusts the pressure of the air bags as you drive and virtually eliminates nosediving and the side-to-side body sway associated with high wind conditions, curvy roads and emergency maneuvers.



- 6 Basement structure rust inhibitor: To prevent corrosion, the basement storage area is constructed with pre-primed steel with rust-inhibiting paint.
- 7 Full-length frame rails fabricated from 3" by 8" by 1/4" 60,000 PSI structural steel; rails are spaced 44" on center for a wider stance and unmatched strength.
- 8 The semi-monocoque design, with trussed superstructure, distributes stress evenly throughout the entire chassis and adds strength to sidewalls and bays.
- 9 PAC brake system assures you of safely traveling steep grades while 6-wheel anti-lock brakes with disc brakes in front help you maintain control in severe road conditions (Thunder Package: CAT® Compression Two-Stage Engine Brake).

8-LAYER ROOF CONSTRUCTION (top to bottom)

- One-piece 1/4" thick fiberglass roof, crowned for water runoff and seamlessly joined with front and rear end caps
- Vapor barrier
- 3-1/2" tapered bead foam supports the crowned roof; the center tunnel houses wiring and air conditioner ducts
- 1/4" marine grade plywood sheeting
- Tubular steel framework
- R 7.5 closed cel foam seals every nook and crevice
- Luaun and vinyl paneling are Vac-U-Bonded
- Sound-absorbing, easy-to-clean padded vinyl interior headliner

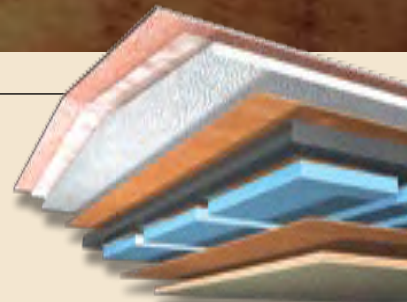

6-LAYER WALL CONSTRUCTION (left to right)

- Gel coat fiberglass outer wall
- Luaun paneling
- Heavy-gauge tubular steel and 4" steel plate backers
- R 7.5 closed cel foam seals every nook and crevice
- Luaun paneling; walls are Vac-U-Bonded together
- Decorative wall coverings

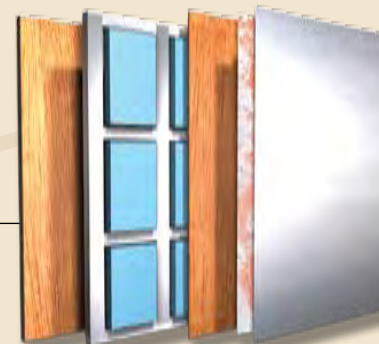

5-LAYER FLOOR CONSTRUCTION (top to bottom)

- Tile, or 1/2" carpet pad and carpeting
- Dyna-Span flooring
- Decibel layer
- Dyna-Span flooring
- Waterproof fiberglass underbelly

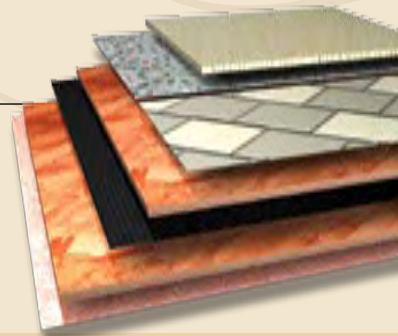

- 10 Dual ping air tanks with 3/4" air lines for quicker response and improved ride and handling.
- 11 P295/80R Goodyear steel-belted all-season tires ensure a safe and quiet ride (G670 RV tire).
- 12 The truss power steering box allows for a 50-degree front wheel turn angle in both directions for better maneuverability and returns the steering wheel to its center position to eliminate driver fatigue.
- 13 All chassis are equipped with steel cage construction, steel firewall and steel stepwell for added safety.



This optional collision avoidance system utilizes a combination of sensors, software and radar to warn you of potential hazards on the road ahead and alongside your coach, which may be outside your view.

ACTIVE CONTROL DAMPENING (ACD)

This optional state-of-the-art system monitors suspension and chassis movement thousands of times per second and adapts the suspension to the input. The result: superior control and unbeatable ride quality.

The luxury of choice.

The Patriot Thunder offers a variety of color, fabric and exterior package options — each as stunning as the next. And because it's from Beaver, the quality is just as impressive. The richness of the colors is matched by the opulence of the fabrics. And to protect the vibrant exterior from nicks and scratches, the 2007 Patriot Thunder features an innovative 3M film front mask.

FABRICS | EXTERIOR | COLORS

- 1. DINETTE
- 2. BEDSPREAD
- 3. SOFA
- 4. CARPET



AFRICAN TWILIGHT



NASSAU GOLD



DESERT SUNSET II



WILLOW BAY



A modern classic.

The true artistry of the 2007 Patriot Thunder is found in its rich wood. Handcrafted from superior hardwoods by experienced craftsmen, Beaver wood cabinets and burl inlays create a look reminiscent of grand estates and fine hotels. Choose from traditional wood cabinets or add striking burl inlays to create a style all your own.

NATURAL CHERRY

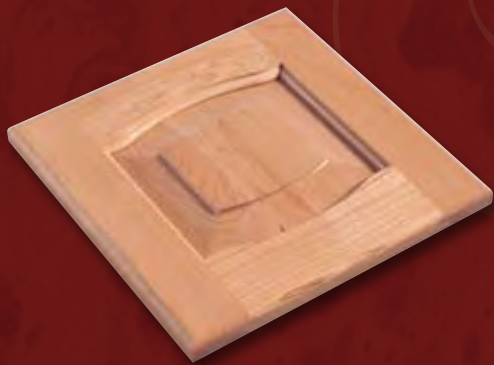

CHERRY WITH MAPLE BURL INLAY

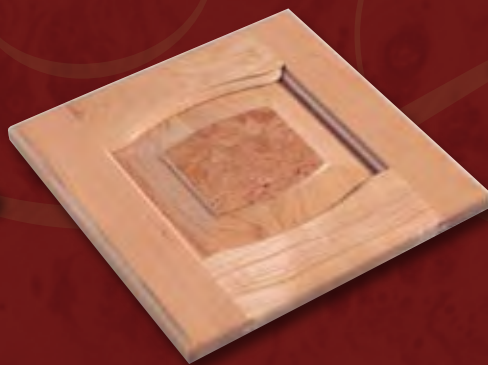

CHERRY WITH MAPPA BURL INLAY

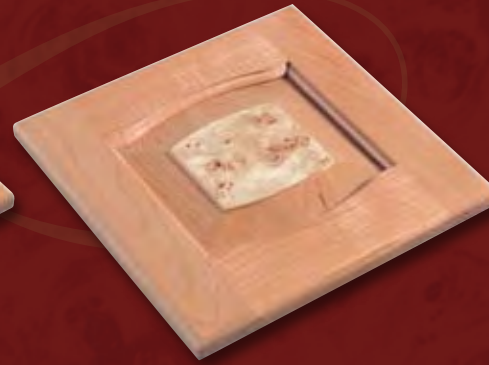

CHERRY WITH MAKORI INLAY

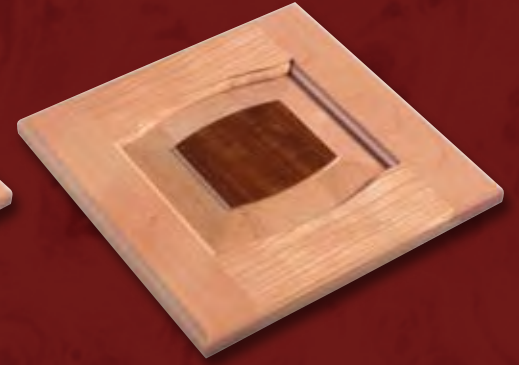

NATURAL MAPLE

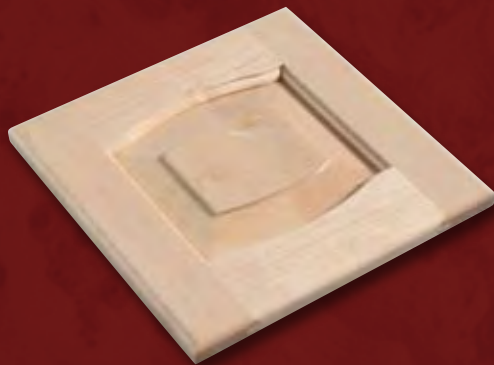

MAPLE WITH MAPLE BURL INLAY

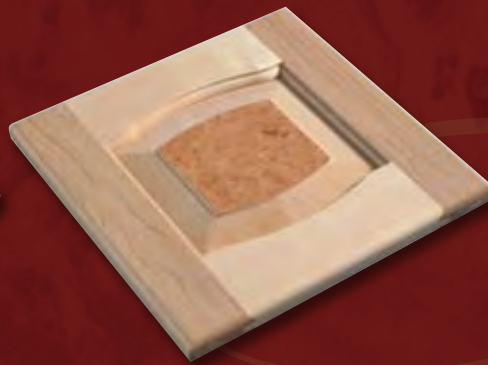

MAPLE WITH MAPPA BURL INLAY



MAPLE WITH BIRD'S EYE MAPLE

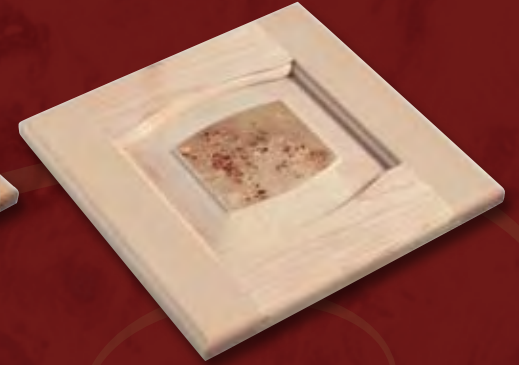

FLOORPLAN OPTIONS

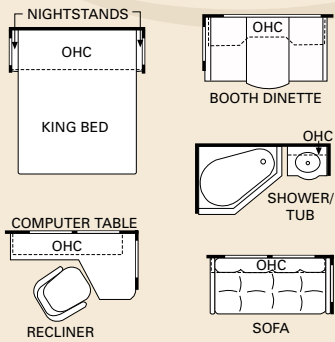

40 LEXINGTON IV

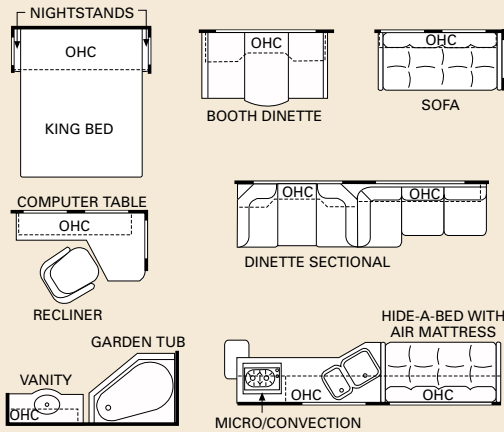
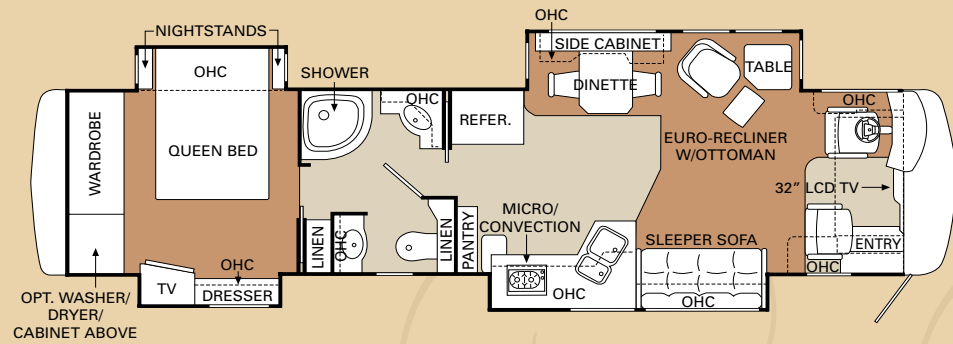

42 VICKSBURG IV

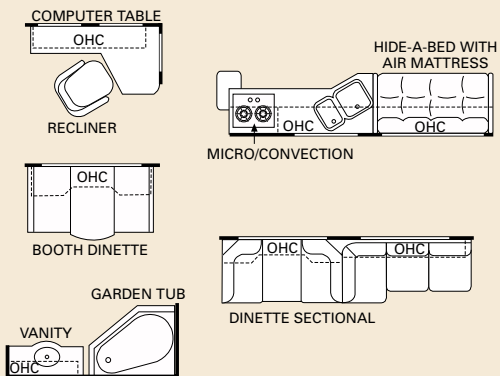
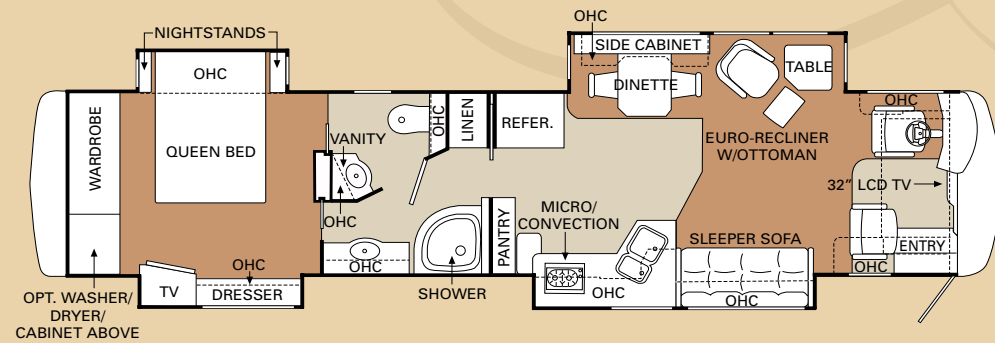

44 BENNINGTON IV

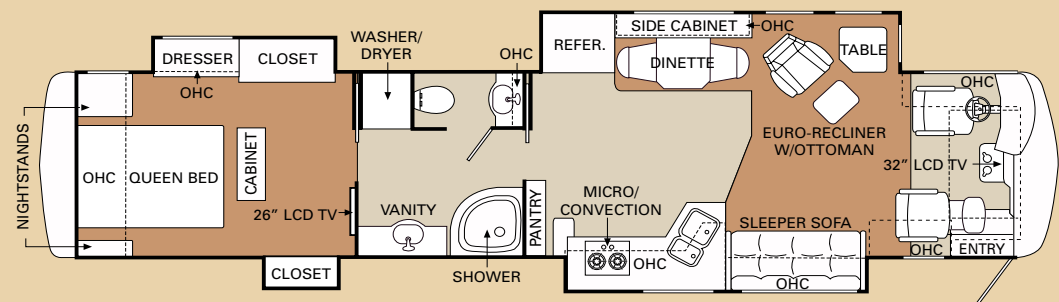

CARPET ■ TILE ■

44 HANOVER IV

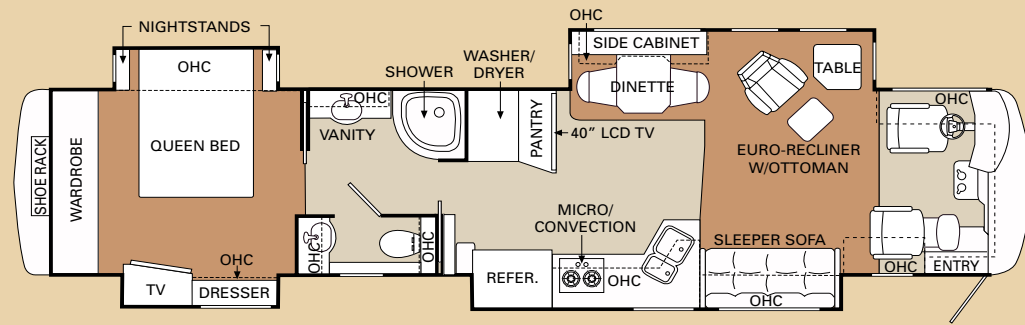

FLOORPLAN OPTIONS

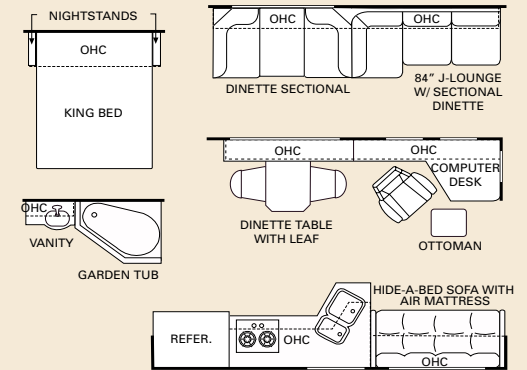

44 SARATOGA IV

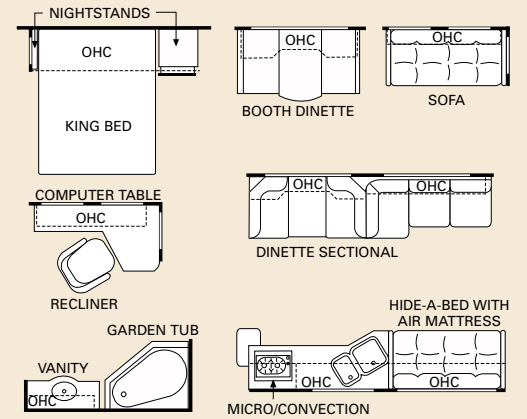
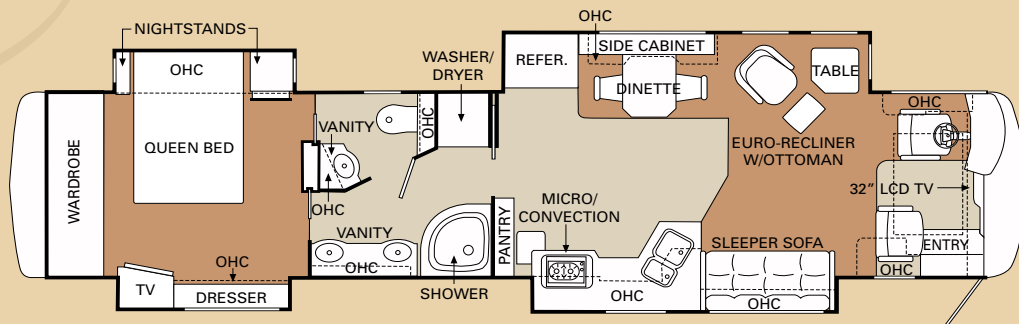

44 WINCHESTER III

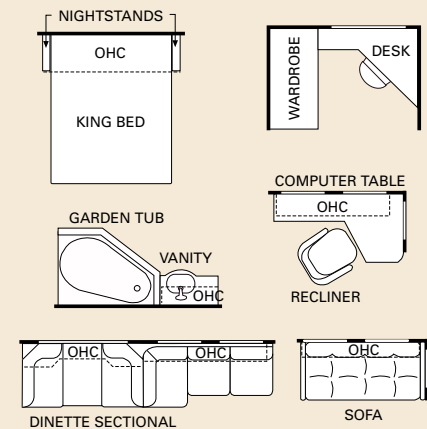
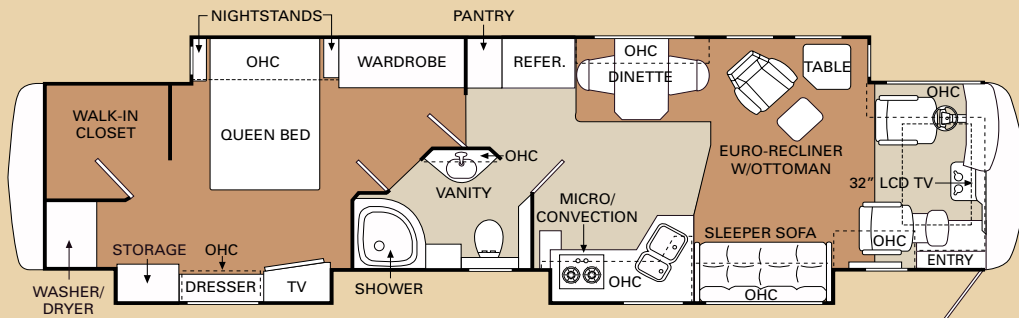

CARPET ■ TILE ■

WEIGHTS	40 Lexington IV	42 Vicksburg IV	44 Hanover IV	44 Bennington IV	44 Saratoga IV	44 Winchester III
Gross Vehicle Weight Rating (Lbs.)	50,160	50,160	50,160	50,160	50,160	50,160
Gross Combined Weight Rating ¹ (Lbs.)	60,160	60,160	60,160	60,160	60,160	60,160
Front Gross Axle Weight Rating (Lbs.)	15,160	15,160	15,160	15,160	15,160	15,160
Rear Gross Axle Weight Rating (Lbs.)	23,000	23,000	23,000	23,000	23,000	23,000
Tag Gross Axle Weight Rating (Lbs.)	12,000	12,000	12,000	12,000	12,000	12,000

MEASUREMENTS	40 Lexington IV	42 Vicksburg IV	44 Hanover IV	44 Bennington IV	44 Saratoga IV	44 Winchester III
Wheelbase	250 3/4"	271"	280"	280"	280"	280"
Overall Length	41' 7"	43' 1"	44' 11"	44' 11"	44' 11"	44' 11"
Overall Height (12' 8" to Optional Satellite)	12' 6"	12' 6"	12' 6"	12' 6"	12' 6"	12' 6"
Exterior Width	100.5"	100.5"	100.5"	100.5"	100.5"	100.5"
Interior Height	84"	84"	84"	84"	84"	84"

TANK CAPACITIES ²	40 Lexington IV	42 Vicksburg IV	44 Hanover IV	44 Bennington IV	44 Saratoga IV	44 Winchester III
Gray Tank (Gal.)	72	72	72	72	72	72
Black Tank (Gal.)	40	40	40	40	40	40
Fresh Tank (Gal.)	100	100	100	100	100	100
Fuel Tank	150	150	150	150	150	150
LP Tank ³ (Gal.)	25	25	25	25	25	25

¹ Towing capacity is limited by GCWR; your vehicle's towing capacity is the difference between the GCWR and the actual vehicle weight, including all water, fuel, passengers and cargo. Your towed vehicle should be equipped with auxiliary brakes if the weight of the towed vehicle exceeds 1,000 lbs. Consult your owner's manual for further towing information.

² All tank capacities are estimated based upon calculations provided by the tank manufacturers and represent approximate capacities. The actual "usable capacity" may be greater or less than the estimated capacities based upon fabrication and installation of the tanks.

³ Actual filled LP capacity is 80% of listing due to safety shut-off required on tank.

The actual overall length of the recreational vehicle may differ from that indicated in the brochure due to variances in the manufacturing process and/or installed components. The actual length may be greater or less than that indicated. Due to the large variety of options and floorplan arrangements available to our customers, actual weights for each

unit can differ significantly. Beaver Motor Coaches provides a weight sticker on each unit we produce which includes that unit's tank capacities and approximate weight. Consult your local Beaver Motor Coaches dealer for unit availability and further information.

The information printed in this brochure reflects product design, fabrication, and component parts at the date of printing. The manufacturer reserves the right, at any time, to make changes in product design material or component specifications as its sole option, without notice. This includes the substitution of components of a different brand or trade name which will result in comparable performance.

All information printed in this brochure is subject to change after the date of printing. Some features shown or mentioned in this brochure are optional and may only be available in selected floorplans. Photographs may show props or decorations that are not standard equipment on Beaver Motor Coach models. Beaver Motor Coaches, the Beaver logo and its design, are registered trademarks. All other products and company names are trademarks and/or

registered trademarks of their respective holders. While the color of the motorhome's exterior and the interior fabrics depicted in this sales brochure are fair and reasonable depictions, the colors depicted may not be an exact match of the actual colors because of the variances in photo-processing and variances caused by inserting the photographs within the sales brochure.

Due to product improvements, changes during the model year and/or transcription errors that may occur, information represented within this brochure may not be accurate at the time of your purchase. If certain information is significant to your purchasing decision, please confirm the information with your dealer prior to submitting your order. Component part and appliance manufacturers issue limited warranties covering those portions of the recreational vehicle not covered by the Limited Warranties issued by Monaco Coach Corporation. To learn which specific component parts and appliances are excluded from the Limited Warranties issued by Monaco Coach Corporation, please contact your selling dealership or Monaco Coach Corporation directly, or review the warranty packet inside the recreational vehicle.

BODY CONSTRUCTION

FEATURES

- › Heavy-Duty Steel Superstructure with Steel Cage Cockpit Construction
- › Seamless One-Piece Molded Crowned Fiberglass Roof
- › All-Season Foam Insulated Roof
- › Laminated Gel Coat Fiberglass Sidewalls
- › Five-Layer Flooring with Two Layers of OSB Flooring
- › Deluxe Full-Body Paint with Thunder Logos on Front and Rear Caps

- › Panaview™ 1-Piece Front Windshield
- › Triple Head Power Controlled Heated Chrome Exterior Mirrors
- › Daytime Running Lights
- › Halogen Driving Lights
- › Recessed Side Docking Lights
- › Dual Trumpet Air Horns
- › Insulated Aluminum Baggage Doors with Power Locks
- › Lined Storage Compartments

- › Interlocking Aluminum Framed Slide-Out Houses
- › Interior Paneling with 1-1/2" Insulation
- › Rear Ladder
- › Full-Length "Beaver" Mud Flap

OPTIONS

- › 3M Film Front Mask
- › One Manual Storage Bay Slide-Out Storage Tray (One Side)
- › One Manual Storage Bay Slide-Out Tray (Full Pass-Through)
- › Electric Slide-Out Storage Tray (Full Pass-Through)
- › Interior Solar Privacy Sunscreens

CHASSIS/ENGINE/SUSPENSION

FEATURES

- › Roadmaster S-Series: Semi-Monocoque Chassis
- › CAT® 525 HP C-13 & Allison® 4000 MH 6-Speed World Transmission with Electronic Shifter
- › Torque: (@ 1,200 RPM) 1,650 lbs./ft. Max. Net
- › Engine Displacement: 763 Cu. In./12.5L
- › Dual Fuel Fill
- › 200 Amp Alternator

- › Rear Axle Ratio: 4.33:1
- › Tires: 295/80R/22.5
- › Polished Aluminum Wheels
- › Full Cushion Air Glide Suspension with Ten Outboard-Mounted Air Bags and Ten Shock Absorbers
- › Automatic Traction Control
- › Air Disc Brake System with ABS
- › Tag Axle with Anti-Lock Braking System
- › Auto Slack Adjusters on Brakes

- › Cat® Compression Two-Stage Engine Brake
- › Pre-Wire for Supplemental Braking System
- › Hydraulic Leveling System
- › 10,000 Lb. Hitch Receiver and 7/4-Way Trailer Plug

OPTIONS

- › Dual Leveling System (Air/Hydraulic)
- › Air Leveling (Replaces Hydraulic Leveling)
- › Electronic Adjustable Suspension System

COCKPIT

FEATURES

- › Fiberglass Automotive Dash with Beige Grid Instrumentation Panel, Black Gauges with White Lettering and Chrome Bezels
- › In-Dash AM/FM Stereo with Multi-Disc CD Changer
- › Rear Vision System with Color Monitor
- › Aladdin™ Video Coach System with Integrated Compass and Temperature Gauge

- › CB Radio Prep (Cable and Antenna)
- › Manual Privacy Drapes
- › Power Sunvisors with Driver and Passenger Switch
- › Adjustable Accelerator and Brake Pedals
- › Two-Tone Leather VIP Lighted Smartwheel® with Controls for Windshield Wipers, ICC and Cruise Control

- › Audible Turn Signals
- › 6-Way Power OptimaLeather™ Pilot and Co-Pilot Seat with Adjustable Head- and Armrests, Electric Lumbar and Heat, Colored Pleats and Thunder Logo on Both; Memory Capabilities on Pilot Seat
- › Carpeted Pilot and Co-Pilot Floor Mats

OPTIONS

- › Power Privacy Cab Drapes
- › CB Radio
- › GPS Navigation System with Touchscreen
- › XM Satellite Stereo (Requires Subscription)
- › Sirius Satellite Stereo (Requires Subscription)
- › SEE-Vision Coach Monitoring System

APPLIANCES AND ACCESSORIES

FEATURES

- › 14 Cu. Ft. 2-Door Refrigerator with Ice and Water Dispenser in Door
- › Recessed High-Output 2-Burner Cooktop with Flush-Mounted Covers
- › Spacesaver Convection Microwave with Touch Control
- › Electric TV Antenna
- › Prep for Satellite Receiver
- › 32" LCD TV with Remote Control in Living Area (N/A: 44 Hanover IV)

- › 40" LCD TV Mounted in Entertainment Center Behind Dinette Area (44 Hanover IV)
- › 23" LCD TV with Remote Control in Bedroom (N/A: 44 Bennington IV)
- › 26" LCD TV with Remote in Bedroom (44 Bennington IV)
- › Home Theater System in Living Area
- › Bedroom DVD Player
- › Universal Remote System for Living Area TV
- › Combination Washer/Dryer Prep

OPTIONS

- › Combination Washer/Dryer
- › Stackable Washer/Dryer
- › Central Vacuum System
- › Residential Refrigerator with 4 Additional Batteries
- › Stainless Steel Refrigerator
- › Stainless Steel Microwave
- › 40" LCD TV in Living Area Ceiling
- › 26" LCD TV with Remote Control in Bedroom (Standard 44 Bennington IV)

- › 32" LCD TV with Remote Control in Bedroom (N/A: 44 Bennington IV)
- › Fully Automatic Digital Satellite System with Receiver in Living Area and Bedroom
- › In-Motion Digital Satellite System with Receiver in Living Area and Bedroom
- › In-Motion Digital Satellite System with HD-Ready Receiver in Living Area and Additional Receiver in Bedroom
- › Exterior 32" Sharp LCD TV

INTERIOR

FEATURES

- › Gloss Finish Cabinetry
- › Lined Cabinet Shelves
- › Dinette Wall Cabinet with Solid Surface Top
- › Built-In Storage Area for Kitchen Countertop Covers
- › Bedroom Dresser
- › Low-Friction Roller Drawer Guides
- › Vinyl Ceiling with Wood Design
- › Solid Surface Countertops Throughout
- › Integrated Solid Surface Sinks in Vanity and Galley
- › Solid Surface and Ceramic Tile Galley Backsplash with Metal Tile Accents
- › Tile and Corian® Vanity Backsplash
- › Sculpted Glass Splash Guard at Edge of Galley

- › Day/Night Shades with Blackouts Throughout
- › Day/Night Shades in Passenger Cockpit Window, Kitchen and Bathroom
- › Vinyl Wallpaper with Chair Rail in Living Area
- › Textured Carpet in Living Area and Throughout
- › Ceramic Tile in Kitchen and Bath Area
- › Ceramic Tile Flooring in Cockpit Area
- › Bedspread with Pillows
- › Nightstands with Solid Surface Countertops
- › Decorative Hardware Throughout
- › Large Pot and Pan Drawer in Kitchen Area
- › Decorative Hardwood Slide-Out Fascia Trim

OPTIONS

- › Interior Decors: Desert Sunset II, African Twilight, Willow Bay, Nassau Gold
- › Gloss Finish Cabinetry Choices: Cherry and Maple
- › Maple Burl Accent Cabinet Door Inserts with Cherry Cabinetry
- › Maple Burl Accent Cabinet Door Inserts with Maple Cabinetry
- › Mappa Burl Accent Cabinet Door Inserts with Cherry Cabinetry
- › Mappa Burl Accent Cabinet Door Inserts with Maple Cabinetry

- › Makori Accent Cabinet Door Inserts with Cherry Cabinetry
- › Bird's Eye Maple Accent Cabinet Door Inserts with Maple Cabinetry
- › Manual Roman Shades (N/A with Slide-Out Endwall Windows)
- › Ceiling Fan in Bedroom
- › Sculptured Carpet in Living Area

FURNITURE

FEATURES

- › Queen Bed with Pillowtop-Hinged Mattress
- › Curbside: Sleeper Sofa with Drawer and Footrest
- › Roadside: OptimaLeather™ Euro-Recliner with Ottoman
- › Solid Surface Fixed Living Area Table

- › Side-Slide, Solid Surface Fixed Dinette Table with Two Freestanding Dinette Chairs and Two Folding Chairs

OPTIONS

- › King Bed with Pillowtop-Hinged Mattress (N/A: 44 Bennington IV)
- › King Air Mattress with Digital Remote (N/A: 44 Bennington IV)
- › Roadside: OptimaLeather™ Recliner
- › Roadside: OptimaLeather™ Sofa with Drawer
- › Roadside: OptimaLeather™ Hide-a-Bed
- › Roadside: OptimaLeather™ Hide-a-Bed with Air Mattress
- › Curbside: OptimaLeather™ Sofa with Drawer

- › Curbside: OptimaLeather™ Hide-a-Bed with Air Mattress (N/A: 44 Winchester III)
- › Curbside: Fabric Hide-a-Bed with Air Mattress (N/A: 44 Winchester III)
- › Roadside: Computer Table
- › Bedroom Workstation and Window ILO Walk-In Closet (44 Winchester III)
- › Fabric/Leather Sectional Booth Dinette Ensemble (Requires New Galley)

ELECTRICAL SYSTEMS AND LIGHTS

FEATURES

- › 50 Amp 120/240V Distribution Panel and Power Cord with Quick Disconnect
- › Power Cord Reel
- › Onan® 10.0 kW Quiet Diesel Generator on Power Slide-Out Tray with Auxiliary Start Switch
- › 2,800 Watt Pure Sine Wave Inverter with Auto Gen Start and Auto Temp Start
- › Computer Hook-Up with Phone Jack at Dinette Area
- › Decorative Lighting in Bedroom and Living Area
- › Pilot/Co-Pilot Reading Lights
- › Cosmetic Vanity Light
- › Adjustable Bedroom Overhead Lights with Switches above Bed

- › Recessed Halogen Lighting under Living Room and Dinette Overhead
- › Halogen Lighting in Ceiling Throughout
- › Fluorescent Light in Bath Area
- › 120V Outlet in Private Bath
- › 120V Outlet in Bed Base
- › 120V Receptacle in Outside Storage Compartment
- › Porch Light
- › Doorbell
- › Lighted Exterior Storage Compartments
- › Four 6V Deep Cycle Coach Batteries
- › Two 12V Deep Cycle Chassis Batteries
- › Surge Guard™ Automatic Transfer Switch
- › Multiplex 12V Wiring Throughout Interior of Coach

- › Locking Battery Disconnect Switch inside Coach
- › Battery Disconnect Switch in Battery Compartment
- › Solar Panel with Regulator (100 Watt)

OPTIONS

- › Glass Matt Batteries (Replace House and Chassis Batteries)

PLUMBING AND LP SYSTEMS

FEATURES

- › Central Water Filtration System in Service Bay
- › Manifold Water Control System
- › Insulated Systems Compartment with Easy Access to Hook-Ups
- › Water Pump Switches in Galley, Bath and Water Bay
- › China Toilet
- › Solid Surface Shower with Corian® Shower Caddy
- › Black and Gray Tank Flush
- › Water Sprayer in Outside Bay
- › Power Water Hose Reel
- › One Touch Pullout Faucet
- › Soap Dispenser in Kitchen

OPTIONS

- › RV Sani-Con Tank Drainage System
- › Electronic Automatic Winterization
- › Bathtub

HEATING, VENTS AND AIR CONDITIONING

FEATURES

- › Aqua-Hot® Heating System
- › Two Low-Profile Ducted 15,000 BTU Roof Air Conditioners with Heat Pumps (40 Lexington IV)
- › Three Low-Profile Ducted 15,000 BTU Roof Air Conditioners with Heat Pumps (N/A: 40 Lexington IV)
- › Electronic AC/Heat Climate Control System
- › Dash Heating and Air Conditioner System with Defroster
- › 12V Attic Fan with Sensor and Wall Switch in Kitchen, Bath and Vanity Area

OPTIONS

- › Two Low-Profile Baseboard Heaters (N/A: 44 Winchester III)

WINDOWS, DOORS AND AWNINGS

FEATURES

- › Flush-Mounted Radius Dual Pane Safety Glass Dark Tinted Windows
- › Front Entry Door with Air Seal and Removable Top Screen
- › Keyless Remote Entry System with Pocket Remote
- › Tinted Skylight in Bathroom
- › Topper Slide-Out Awnings
- › Roof-Mounted Girard® Automatic Front Patio Awning

OPTIONS

- › Girard® Awning Package (Includes: Rear Patio Awning, Automatic Entry Door Awning, Slide-Out Topper Awnings and Window Awnings)
- › Girard® Automatic Front Door Awning
- › Carefree Manual Window Awnings (Required Option)

SAFETY

FEATURES

- › Back-Up Alarm
- › Fire Extinguisher
- › Deadbolt Lock on Entrance Door
- › Lighted Interior and Exterior Grab Handles
- › 120V GFI Protected Circuit (Kitchen, Bath, Exterior)
- › LP Gas Detector
- › Smoke Detector
- › Carbon Monoxide Detector
- › Integrated Pilot and Co-Pilot Three-Point Seatbelts
- › Third Brake Safety Light
- › Egress Window(s)

OPTIONS

- › Security Safe
- › Deluxe Security Alarm System
- › Collision Avoidance System

The inside track.

Beaver dealer links, service center finders, owner news and the latest information on the 2007 Patriot Thunder can be found on our website. It's a direct link to everything Beaver that can be accessed anytime, day or night, from home or on the road.

www.beavermotorcoaches.com



BEAVER PATRIOT® THUNDER | 2007



Artistry in motion.

The 2007 Beaver Patriot® Thunder is not a typical RV. The intention was never overwhelming popularity. Instead, it was designed to appeal to a more discriminating audience. Those in touch with nature. People who are inspired by natural beauty. And individuals who appreciate the finer things in life.

Inspired engineering paired with mesmerizing technology. Unquestionable safety wrapped in unbelievable beauty. Luxurious comfort down to the smallest details. This is the legacy of the 2007 Patriot Thunder from Beaver. A true work of art.



MONACO COACH CORPORATION

Monaco is traded on the New York Stock Exchange under the listing MNC.

© 2006, Monaco Coach Corporation Litho in USA

0806 NPN:BROBPAT

WE'RE HERE. ANYTIME, EVERY TIME.

24/7

ASSISTANCE

SALES • TECH • ROADSIDE



- Reach us anytime — literally — via our live customer support line.
 - Drive in to one of our 350 Service Centers.
 - Enjoy the first year free when you enroll in our Owner Advantage Roadside Assistance Program.
 - See where it all begins with a tour of one of our facilities in Indiana or Oregon.
- Call 1-800-650-7337 or
1-800-634-0855 to find out more.

THE BEAVER LINE OF MOTOR COACHES:

MARQUIS® • PATRIOT® THUNDER • CONTESSA



One coach at a time. Yours.™

BEAVER MOTOR COACH

91320 Coburg Industrial Way, Coburg, OR 97408

www.beavermotorcoaches.com

Daily factory tours.

(800) 634-0855