

Dutchmen 07

Class C Motorhome



Dutchmen Kodiak



Dutchmen Express



Dutchmen Dorado

FW Four Winds
INTERNATIONAL

Indulge Yourself!



Indulge yourself in exceptional comfort and style in the Dutchmen Class C motorhome. Whether you're traveling across town, across the state or across the country, it sets the standard for upscale living.

With a choice of innovative floorplans, you'll find a model to meet your needs, tastes and lifestyle. Once you experience the Dutchmen, nothing else quite measures up. In comfort. In quality. And in value.



Above: Shown with Yonder Natural interior and Maple cabinetry.

Left: Shown with Janus Sterling interior and Cherry cabinetry.

Dutchmen motorhomes are available in a variety of styles to complement your lifestyle. Whether you enjoy traveling in comfort, entertaining guests, camping with the family, or even attending weekend sports events—the Dutchmen Class C motorhome is your best choice.

You'll find a wide selection of single, double and triple slide-out floorplans from which to choose. Plus, all Dutchmen motorhomes are built to meet high quality standards—from the inside out. A spacious living area provides all of the comforts and conveniences of home.

The kitchen is fully equipped with name brand appliances and convenience features to meet your food planning and preparation needs. Attractive kitchen layouts range

from an efficient L-shaped design to an expansive layout with a sofa/dinette slide room. Standard features include a double door refrigerator, three burner gas range top, microwave oven, laminate countertops and Stainless Steel sink.

These motorhomes are designed with plenty of interior and exterior storage space for your personal belongings. All drawers have double metal roller guides for added durability and easy access.





For those who require additional space, models with a sofa/dinette slide-out dramatically expand your living and dining area. You can also enjoy any kind of meal—from a quick snack to an elegant dinner—at the cozy dinette. When not in use, the dinette easily converts into a bed when extra sleeping accommodations are required.

The cockpit area is designed for maximum driver and passenger comfort. Plush captain's chairs can be easily adjusted to your most comfortable position. An ergonomically designed dashboard features an oversized AM/FM radio with large buttons, compact disc player and weather band (most models).

The front overhead is a versatile area that can be tailored to meet your specific needs. From a full bunk to an entertainment center—or anywhere



in-between—you can find a model with a great selection of standard and optional features from which to choose.

Go Anywhere Convenience



Above: Shown with Yonder Natural interior and Maple cabinetry.

Upper left: Shown with Yonder Natural interior, Maple cabinetry and Infiniss™ Leather sofa.

Lower left: Shown with Crystal Blue interior and Maple cabinetry.



You can indulge yourself in gentle comfort after a full day of activities in the cozy bedroom. It features a queen-size bed with innerspring mattress that has a memory foam top for added sleeping comfort. The color-coordinated bedspread, pillow shams and decorative headboard add a touch of style and elegance.

While relaxing in bed, you can enjoy watching television or flip on the overhead lights to read your favorite book or magazine. The handy nightstands provide additional storage for small items. Day/night shades keep the room dark when you want to sleep and enhance your privacy. Models 28A, 29R, 31P and 32B, are available with optional twin beds and nightstand.

Dutchmen motorhomes are available in models that sleep from four to eight people—with many unique features as well. Dutchmen Kodiak Model 33K is a triple slide-out floorplan that greatly increases your living area, and offers a standard hide-a-bed sofa (not available in 34G).

Model 31F features an ergonomically designed L-shaped kitchen, side aisle hallway and full bath with two entry doors. To accommodate a larger family, Model 29R is a double slide-out floorplan that has four separate sleeping areas.

The Dutchmen Dorado Model 31BH is new for 2007 and features a full sofa/dinette slide for an expanded living area, and has additional sleeping areas.



INTERIOR DECOR

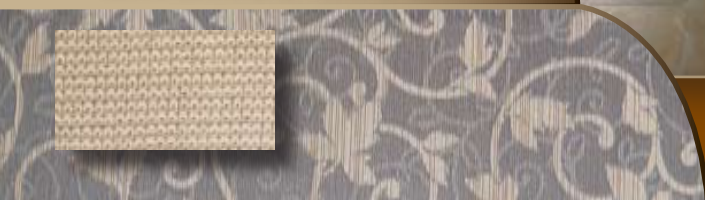

Crystal Blue



Janus Sterling



Yonder Natural



Standard Oak



Optional Maple



Optional Cherry

Dutchmen Dorado shown with Janus Sterling interior and Cherry cabinetry.

No matter what your traveling requirements are, Four Winds International has a Dutchmen to meet your needs. For those who prefer a cab style chassis with the added power, interior space (including an over-head

bunk), and towing capacity of a Class A motorhome—the Dutchmen Kodiak is the right model for you.

If you are more comfortable with a traditional Class C motorhome for family vacations, entertaining or tailgating at your favorite sports events, take a close look at the Dutchmen and Dutchmen Express floorplans.

For those who are looking to downsize from a larger motorhome without sacrificing upscale amenities

The Dutchmen Difference

and like to travel in style—the Dutchmen Dorado offers several different models from which to choose.

All models offer a choice of designer interior decor packages and classic cabinetry wood. On the outside, the Dutchmen is available in either a standard graphics, graphics/partial paint or full-body paint package (most models), to suit your taste and style.

Dutchmen motorhomes offer many convenience features to make your life more enjoyable while on the road. You'll find a wide selection of entertainment features available (depending on model), including:

- Home theater system with DVD player
- Outside entertainment center with compact disc player
- 20" flat screen LCD television on electric swivel in cab-over
- Overhead entertainment center with up to a 27" television and slide-out bunk
- Satellite dish



Above: Back-up monitor on Dutchmen Kodiak.

Left: Pass-through exterior storage compartment.

Safety & Convenience Features

Four Winds International takes pride in making safety and convenience a priority in the design and manufacture of our motorhomes.

A back-up monitor is available as an option on all Dutchmen motorhomes. The Dutchmen Kodiak has a back-up monitor mounted close to the upper part of the windshield for easy viewing. You can keep track of your tow vehicle while driving with a quick glance, and backing up is a snap.

When traveling with young children, you can attach your child's safety seat to the optional

tether anchor located in the booth dinette (available in most models). The pass-through exterior storage compartment features seamless roto-cast construction for extra durability and water protection.



Tether anchor behind booth dinette cushion securely holds child's safety seat while traveling.





Graphics/partial paint exterior option



Standard graphics exterior

BODY CONSTRUCTION/ EXTERIOR STANDARD

- ❑ Fully welded tubular steel floor system
- ❑ Fully welded tubular aluminum roof and sidewall cage construction

- ❑ Seamless fiberglass exterior sidewalls
- ❑ Exterior graphics package
- ❑ Air conditioning ductwork molded into roof insulation and residential-style ducted heat
- ❑ Premium one-piece TPO roof—Energy Star approved and labeled
- ❑ Crown roof

- ❑ Automatic electric entrance step
- ❑ Patio awning
- ❑ Roof ladder
- ❑ Exterior shower

OPTIONS

- ❑ Exterior partial paint package
- ❑ Slick fiberglass exterior
- ❑ Automatic electric patio awning

AUTOMOTIVE/ COCKPIT STANDARD

- ❑ 10,000-lb. trailer hitch
- ❑ Oversized AM/FM radio with large buttons and compact disc player
- ❑ Power window and door
- ❑ Upgrade dash insert with drink tray
- ❑ Heated, remote exterior mirrors
- ❑ Fully automatic leveling jacks
- ❑ Cockpit carpet mat
- ❑ Stainless Steel wheel liners

OPTIONS

- ❑ Duramax™ diesel engine with Onan® RV Marquis Gold™ 5500 LP generator (5500 watts)
- ❑ Duramax™ diesel engine with Onan® RV Quietdiesel™ 5500 generator (5500 watts)
- ❑ Back-up monitor

- ❑ Infiniss™ Leather driver and passenger captain's chairs
- ❑ Spare tire (not available on 35B)

INTERIOR STANDARD

- ❑ Full 84" interior ceiling height
- ❑ Residential linoleum (galley, bath and entry way)
- ❑ Metal entry grab handle
- ❑ 13,500 BTU ducted roof air conditioner in front
- ❑ Windshield privacy curtain
- ❑ Oak cabinetry
- ❑ Raised panel upper cabinet doors with hidden hinges
- ❑ Hardware with Brushed Nickel finish
- ❑ Day/night shades throughout
- ❑ Soft Touch vinyl ceiling
- ❑ Barrel chair (32B and 35B only)
- ❑ Fabric sofa (34G only)
- ❑ Fabric hide-a-bed sofa (32B, 33K and 35B only)

OPTIONS

- ❑ Cherry or Maple cabinetry
- ❑ 15,000 BTU roof air conditioner with heat pump and solar charger
- ❑ 13,500 BTU rear roof air conditioner (requires 5500-watt generator)
- ❑ Fantastic® fan in kitchen
- ❑ Fantastic® fan in bunk overhead
- ❑ Infiniss™ Leather sofa (34G only)
- ❑ Infiniss™ Leather recliner (32B and 35B only)
- ❑ Infiniss™ Leather hide-a-bed sofa (32B, 33K and 35B only)
- ❑ Fabric recliner (32B and 35B only)

Kodiak

- ❑ Leather Euro recliner with ottoman (32B and 35B only)
- ❑ Dual pane windows (not available on 35B)

GALLEY STANDARD

- ❑ Double door refrigerator
- ❑ Decorative raised wood refrigerator panels
- ❑ 3-burner high-output gas range top with oven
- ❑ Residential 30" over the range microwave oven
- ❑ Laminate countertops
- ❑ Flip-up countertop extension (not available on 33K)
- ❑ Large Stainless Steel double bowl sink
- ❑ Full extension metal drawer guides
- ❑ Booth dinette

OPTIONS

- ❑ Convection microwave with high-output gas range top

ENTERTAINMENT STANDARD

- ❑ 20" television in bedroom (33K, 34G and 35B only)
- ❑ Television cabinet in bedroom (32B only)
- ❑ Front television cabinet (not available with the entertainment center)

OPTIONS

- ❑ Entertainment center with 27" television and slide-out bunk
- ❑ Home theater system with DVD player (requires entertainment center or 20" LCD television option)
- ❑ 20" LCD television on electric swivel in cab-over; includes bunk window
- ❑ 14" television with pull-out swivel tray in living room

Specifications

MODEL	32B	33K	34G	35B
WEIGHT RATING (LBS.)				
Chevy Kodiak 8.1L Vortec Engine	V8	V8	V8	V8
Gross Vehicle (GVWR)	19,500	19,500	19,500	19,500
Gross Combined (GCWR)	26,000	26,000	26,000	26,000
MEASUREMENTS				
Wheel Base	213.5"	213.5"	213.5"	239"
Exterior Length (without ladder)	33'	33'5"	34'7"	35'8"
Exterior Height (with air conditioner)	11'10"	11'10"	11'10"	11'10"
Interior Height	84"	84"	84"	84"
Awning Size	16'	15'	16'	16'
TANK CAPACITIES				
Fuel (gallons)	80	80	80	80
LPG (pounds)	81.3	81.3	81.3	81.3
Fresh Water (gallons)	65	65	65	65
Waste Water (gallons)	54	54	54	44
Gray Water (gallons)	44	44	44	54
Water Heater (gallons)	6	6	6	6
Furnace (BTUs)	30,000	30,000	30,000	30,000

Floorplans

- ❑ 14" television in bedroom (32B only)
- ❑ Outside entertainment center with compact disc player
- ❑ DVD player
- ❑ Satellite dish

BEDROOM/BATHROOM STANDARD

- ❑ Queen-size bed with innerspring mattress and memory foam top (32B only)
- ❑ King-size bed with innerspring mattress and memory foam top (33K, 34G and 35B only)
- ❑ Bedsprad and pillow shams
- ❑ Vanity with stool (33K and 35B only)
- ❑ Neo-angled shower with glass door (34G and 35B only)
- ❑ Skylight in shower
- ❑ China bowl toilet

OPTIONS

- ❑ Twin beds with nightstand (32B only)
- ❑ Glass shower door (32B and 33K only)

SAFETY/CONVENIENCE STANDARD

- ❑ Entry door with deadbolt lock
- ❑ Telephone jack
- ❑ Systems Control Center
- ❑ Smoke detector
- ❑ Fire extinguisher
- ❑ LPG detector
- ❑ Carbon monoxide detector
- ❑ Three-point seatbelts for the driver and passenger, and seatbelts throughout

OPTIONS

- ❑ Child safety seat tether anchor in booth dinette
- ❑ Convenience package includes keyless entry, two-way radios and valve stem extenders
- ❑ Central vacuum system (requires 50-amp service)

ELECTRICAL SYSTEMS

STANDARD

- ❑ Guardian RV Quietpac™ 40G generator (3600 watts)
- ❑ 30-amp service
- ❑ Marine-type detachable power cord
- ❑ 6-gallon gas water heater with electronic ignition
- ❑ Water heater bypass system
- ❑ Automatic transfer switch
- ❑ Battery disconnect switch
- ❑ Emergency start switch

OPTIONS

- ❑ Onan® RV Microquiet™ 4000 generator (4000 watts)
- ❑ Guardian RV Quietpac™ 55G generator (5500 watts)
- ❑ Onan® RV Marquis Gold™ 5500 generator (5500 watts)
- ❑ 50-amp service with 6-gallon gas/electric water heater
- ❑ 600-watt inverter
- ❑ Second auxiliary battery

STORAGE AREAS

STANDARD

- ❑ Large pass-through roto-cast storage compartments
- ❑ Flush mount radius luggage doors
- ❑ Heated and enclosed roto-cast holding tanks for full height storage compartments
- ❑ Heated and enclosed roto-cast holding tanks

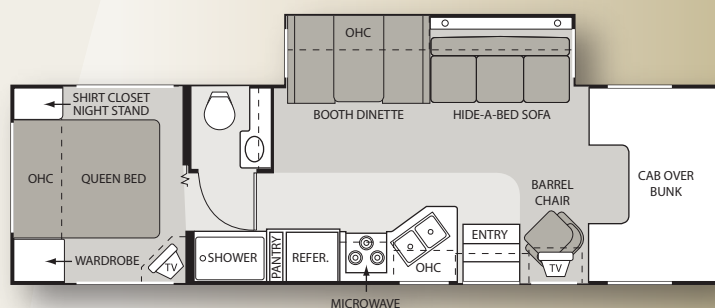

32B

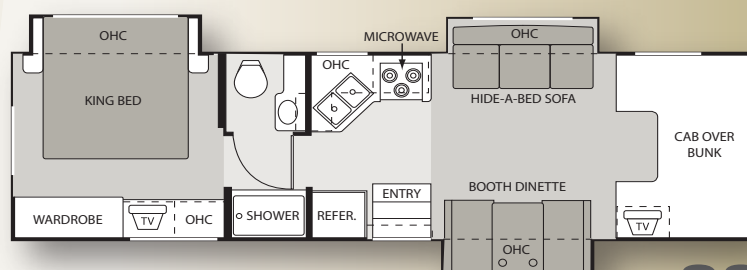

33K

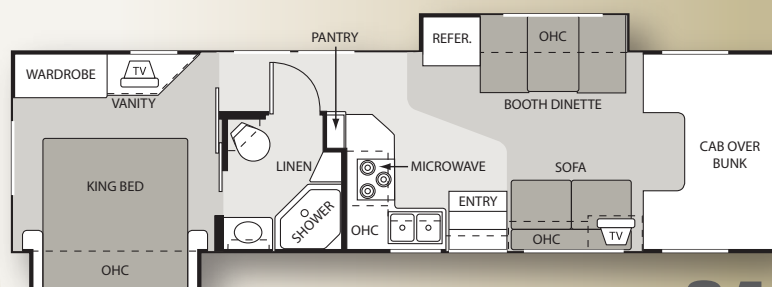

34G

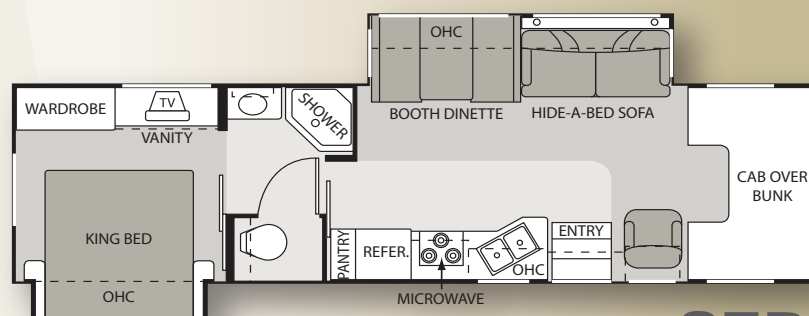

35B

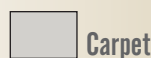

Carpet

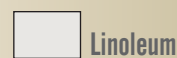

Linoleum

Dutchmen



Taupe Mist partial paint exterior option



Standard graphics exterior

BODY CONSTRUCTION/ EXTERIOR

STANDARD

- ❑ Fully welded tubular steel floor system
- ❑ Fully laminated roof, walls and floors with high-density block foam insulation
- ❑ Fully welded tubular aluminum roof and sidewall cage construction
- ❑ Seamless fiberglass exterior sidewalls
- ❑ Exterior graphics package
- ❑ Air conditioning ductwork molded into roof insulation and residential-style ducted heat
- ❑ Crown roof
- ❑ Premium one-piece TPO roof—Energy Star approved and labeled
- ❑ Patio awning
- ❑ Roof ladder

OPTIONS

- ❑ Exterior graphics/partial paint package
- ❑ Slick fiberglass exterior
- ❑ Automatic electric entrance step
- ❑ Exterior shower

AUTOMOTIVE/ COCKPIT

STANDARD

- ❑ 5,000-lb. trailer hitch
- ❑ Oversized AM/FM radio with large buttons, compact disc player, and weather band
- ❑ Upgrade dash insert with drink tray
- ❑ Power window and door locks
- ❑ Deluxe exterior mirrors
- ❑ Spare tire
- ❑ Aluminum running boards

OPTIONS

- ❑ Infiniss™ Leather driver and passenger captain's chairs
- ❑ Power driver's seat (Ford chassis only)

- ❑ Stainless Steel wheel liners
- ❑ Back-up monitor
- ❑ Heated remote exterior mirrors

INTERIOR

STANDARD

- ❑ Residential linoleum (galley, bath and entry way)
- ❑ Metal entry grab handle
- ❑ 13,500 BTU ducted roof air conditioner in front
- ❑ Windshield privacy curtain
- ❑ Oak cabinetry
- ❑ Raised panel upper cabinet doors with hidden hinges
- ❑ Hardware with Brushed Nickel finish
- ❑ Day/night shades throughout
- ❑ Soft Touch vinyl ceiling
- ❑ Barrel chair (31P only)

OPTIONS

- ❑ Cherry or Maple cabinetry
- ❑ 15,000 BTU roof air conditioner with heat pump and solar battery charger
- ❑ Fantastic® fan
- ❑ Fantastic® fan in overhead bunk
- ❑ Infiniss™ Leather sofa
- ❑ Leather Euro recliner with ottoman (31P only)

GALLEY

STANDARD

- ❑ Double door refrigerator
- ❑ Decorative raised wood refrigerator panels
- ❑ 3-burner high-output gas range top with oven
- ❑ Microwave oven
- ❑ Laminate countertops
- ❑ Flip-up countertop extension
- ❑ Large Stainless Steel double bowl sink
- ❑ Full extension metal drawer guides
- ❑ Booth dinette

Specifications

MODEL	31F	31P
WEIGHT RATING (LBS.)		
Ford Chassis 6.8L Triton	V10	V10
Gross Vehicle (GVWR)	14,050	14,050
Gross Combined (GCWR)	20,000	20,000
Chevy Workhorse Chassis 6.0L Vortec	V8	V8
Gross Vehicle (GVWR)	14,050	14,050
Gross Combined (GCWR)	17,000	17,000
MEASUREMENTS		
Wheel Base Ford/Chevy	223"/224"	211"/212"
Exterior Length (without ladder)*	32'6"	31'4"
Exterior Height (with air conditioner)	11'6"	11'6"
Interior Height	80"	80"
Awning Size	16'	16'
TANK CAPACITIES		
Fuel Ford/Chevy (gallons)	55/57	55/57
LPG (pounds)	40.9	40.9
Fresh Water (gallons)	33	32
Waste Water (gallons)	32	32
Gray Water (gallons)	36	36
Water Heater (gallons)	6	6
Furnace (BTUs)	30,000	30,000

*Add 11" for Chevy chassis length

Floorplans

OPTIONS

- ❑ Convection microwave with high-output gas range top

ENTERTAINMENT

STANDARD

- ❑ 14" television in bedroom (31F only)
- ❑ Television cabinet in bedroom (31P only)
- ❑ Front television cabinet (not available with entertainment center)
- ❑ Cable television and satellite prep

OPTIONS

- ❑ Entertainment center with 24" television and slide-out bunk
- ❑ 20" LCD television on electric swivel in cab-over; includes bunk window
- ❑ 14" television with pull-out swivel tray in living room
- ❑ 14" television in bedroom (31P only)
- ❑ Home theater system with DVD player (requires entertainment center or 20" LCD television option)
- ❑ Outside entertainment center with compact disc player
- ❑ DVD player
- ❑ Satellite dish

BEDROOM/BATHROOM

STANDARD

- ❑ Queen-size bed with innerspring mattress and memory foam top
- ❑ Bedsprad and pillow shams
- ❑ Neo-angled shower with glass door (31F only)
- ❑ Skylight in shower
- ❑ China toilet

OPTIONS

- ❑ Twin beds with nightstand (31P only)
- ❑ Glass shower door (31P only)

SAFETY/CONVENIENCE

STANDARD

- ❑ Entry door with deadbolt lock
- ❑ Telephone jack

- ❑ Smoke detector
- ❑ Fire extinguisher
- ❑ LPG detector
- ❑ Carbon monoxide detector
- ❑ Seatbelts at designated seating positions

OPTIONS

- ❑ Child's safety seat tether anchor in booth dinette
- ❑ Convenience package includes keyless entry, two-way radios and valve stem extenders

ELECTRICAL SYSTEMS

STANDARD

- ❑ Guardian RV Quietpac™ 40G generator (3600 watts)
- ❑ 30-amp service
- ❑ 6-gallon gas water heater with electronic ignition
- ❑ Water heater bypass system
- ❑ Battery disconnect switch
- ❑ Emergency start switch

OPTIONS

- ❑ Onan® RV Microquiet™ 4000 generator (4000 watts)
- ❑ 600-watt inverter
- ❑ 6-gallon gas/electric water heater with automatic generator change-over

STORAGE AREAS

STANDARD

- ❑ Large pass-through roto-cast storage compartments
- ❑ Flush mount radius luggage doors
- ❑ Heated and enclosed roto-cast holding tanks

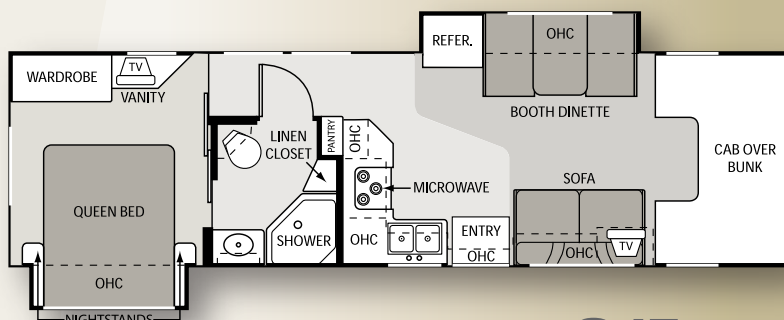

31F

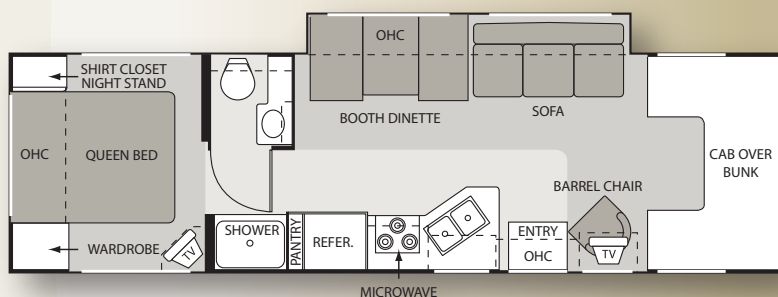

31P

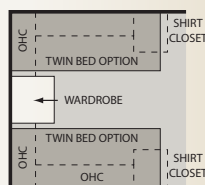

Twin Bed Option
(31P only)

Carpet

Linoleum



Dutchmen

Express



Taupe Mist partial paint exterior option



Standard graphics exterior



Specifications

MODEL	21RB	23A	24T	28A	29R
WEIGHT RATING (LBS.)					
Ford Chassis 6.8L Triton	V8	V10	V10	V10	V10
Gross Vehicle (GVWR)	10,700	11,500	14,050	14,050	14,050
Gross Combined (GCWR)	13,000	18,500	20,000	20,000	20,000
Chevy Workhorse Chassis 6.0L Vortec	V8	V8	V8	V8	V8
Gross Vehicle (GVWR)	12,300	12,300	14,050	12,300	14,050
Gross Combined (GCWR)	17,000	17,000	17,000	17,000	17,000
MEASUREMENTS					
Wheel Base	138"/139"	158"/159"	178"/179"	190"/191"	195"/196"
Exterior Length (without ladder)*	22'2"	24'7"	25'11"	29'7"	30'6"
Exterior Height (with air conditioner)	10'8"	10'8"	11'6"	10'8"	10'8"
Interior Height	80"	80"	80"	80"	80"
Awning Size	12'	15'	13'	14'	15'
TANK CAPACITIES					
Fuel Ford/Chevy (gallons)	37/35	55/57	55/57	55/57	55/57
LPG (pounds)	40.9	40.9	40.9	40.9	40.9
Fresh Water (gallons)	20.5	37	37	32	32
Waste Water (gallons)	16	22	37	25	22
Gray Water (gallons)	22	16	45	22	23
Water Heater (gallons)	6	6	6	6	6
Furnace (BTUs)	25,000	25,000	30,000	30,000	30,000

*Add 11" for Chevy chassis length

BODY CONSTRUCTION/ EXTERIOR

STANDARD

- Fully welded tubular steel floor system
- Fully laminated roof, walls and floors with high-density block foam insulation
- Fully welded tubular aluminum roof and sidewall cage construction
- Seamless fiberglass exterior sidewalls
- Exterior graphics package
- Premium one-piece TPO roof—Energy Star approved and labeled
- Rubber tread entry steps
- Patio awning
- Roof ladder

OPTIONS

- Exterior paint package
- Automatic electric entrance step
- Exterior shower

AUTOMOTIVE/COCKPIT

STANDARD

- Oversized AM/FM radio with large buttons, compact disc player and weather band
- Power window and door locks
- Spare tire

OPTIONS

- 5,000-lb. trailer hitch
- Ford diesel engine with propane generator conversion (24T and 28A only)
- Infiniss™ Leather driver and passenger captain's chairs
- Power driver's seat (Ford chassis only)
- Upgrade dash insert with drink tray
- Back-up monitor
- Deluxe exterior mirrors
- Deluxe heated remote exterior mirrors
- Aluminum running boards

INTERIOR

STANDARD

- Residential linoleum (galley, bath and entry way)
- Metal entry grab handle
- 13,500 BTU roof air conditioner in front
- Windshield privacy curtain
- Oak cabinetry
- Raised panel upper cabinet doors
- Hardware with Brushed Nickel finish
- Mini-blinds throughout

OPTIONS

- Cherry or Maple cabinetry

Floorplans

- ❑ 15,000 BTU roof air conditioner with heat pump and solar battery charger
- ❑ Day/night shades throughout
- ❑ Fantastic® fan
- ❑ Fantastic® fan in overhead bunk
- ❑ Infiniss™ Leather sofa (not available on 23A or 24T)
- ❑ Fabric sofa with pedestal table in place of dinette (29R only)
- ❑ Infiniss™ Leather sofa with pedestal table in place of dinette (29R only)
- ❑ Fabric hide-a-bed sofa (29R only)
- ❑ Infiniss™ Leather hide-a-bed sofa (29R only)

GALLEY

STANDARD

- ❑ Double door refrigerator
- ❑ 3-burner high-output gas range top
- ❑ Microwave oven
- ❑ Laminate countertops
- ❑ Large Stainless Steel double bowl sink
- ❑ Full extension metal drawer guides
- ❑ Booth dinette

OPTIONS

- ❑ Convection microwave with 3-burner high-output gas range top
- ❑ 3-burner high output gas range top with oven
- ❑ Decorative raised wood refrigerator panels

ENTERTAINMENT

STANDARD

- ❑ Television cabinet in bedroom (28A and 29R only)
- ❑ Front television cabinet (not available with entertainment center)
- ❑ Cable television and satellite prep

OPTIONS

- ❑ Entertainment center with 20" television and slide-out bunk (not available on 24T)
- ❑ Entertainment center with 24" television and slide-out bunk (24T only)
- ❑ 20" LCD television on electric swivel in cab-over
- ❑ 14" television with pull-out swivel tray in living room
- ❑ 14" television in bedroom (28A and 29R only)
- ❑ Outside entertainment center with compact disc player (not available on 21RB)
- ❑ DVD player
- ❑ Satellite dish

BEDROOM/ BATHROOM

STANDARD

- ❑ Queen-size bed with innerspring mattress and memory foam top (not available on 21RB)
- ❑ Bedsread and pillow shams (not available on 21RB)
- ❑ Power bath vent
- ❑ China bowl toilet

OPTIONS

- ❑ Twin beds with wardrobe (28A and 29R only)
- ❑ Glass shower door
- ❑ Skylight in shower

SAFETY/CONVENIENCE

STANDARD

- ❑ Entry door with deadbolt lock
- ❑ Telephone jack
- ❑ Smoke detector
- ❑ Fire extinguisher
- ❑ LPG detector
- ❑ Carbon monoxide detector
- ❑ Seatbelts at designated seating positions

OPTIONS

- ❑ Child safety seat tether anchor in booth dinette

ELECTRICAL SYSTEMS

STANDARD

- ❑ 30-amp service
- ❑ Shore line power cord
- ❑ 6-gallon gas water heater with electronic ignition
- ❑ Water heater bypass system

OPTIONS

- ❑ Guardian RV Quietpack™ 40G generator (3600-watts)
- ❑ Onan® RV Microquiet™ 4000 generator (4000 watts)
- ❑ Onan® RV Microquiet™ LP 3600 generator (3600 watts) (requires Ford diesel chassis)
- ❑ 6-gallon gas/electric water heater with auto transfer switch
- ❑ Battery disconnect switch
- ❑ Emergency start switch

STORAGE AREAS

STANDARD

- ❑ Large pass-through roto-cast storage compartments (28A and 29R only)
- ❑ Seamless roto-cast storage compartments
- ❑ Flush mount square luggage doors

OPTIONS

- ❑ Holding tanks with heat pads

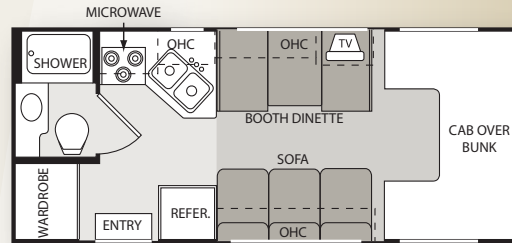

21RB

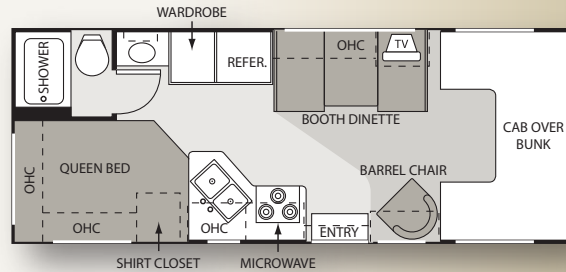

23A

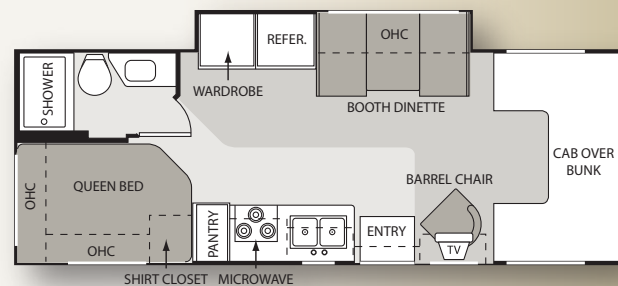

24T

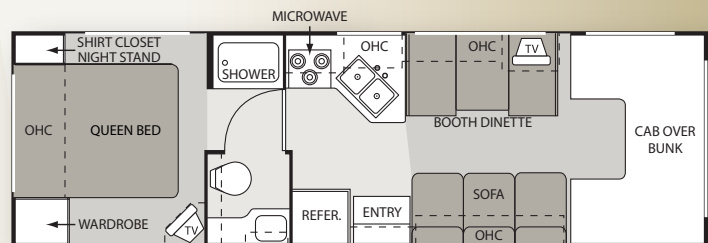

28A

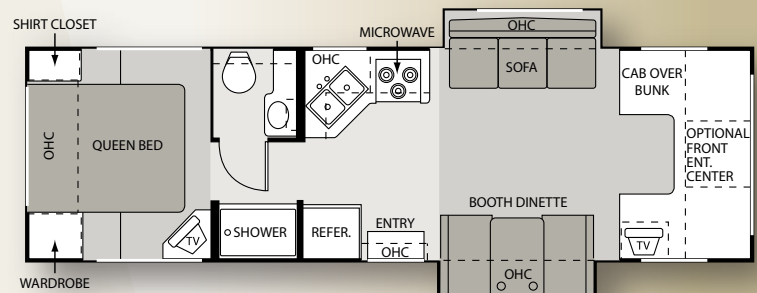

29R

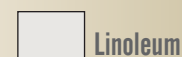
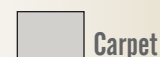

Dutchmen

Dorado



Mocha Mist full-body paint option



Taupe Mist partial paint exterior option



Standard graphics exterior

Specifications

MODEL	21BC	26BE	29BG	31BH
WEIGHT RATING (LBS.)				
Ford Chassis 6.8L Triton	V8	V10	V10	V10
Gross Vehicle (GVWR)	10,700	14,050	14,050	14,050
Gross Combined (GCWR)	13,000	20,000	20,000	20,000
Chevy Workhorse Chassis 6.0L Vortec	V8	V8	V8	V8
Gross Vehicle (GVWR)	12,300	12,300	14,050	14,050
Gross Combined (GCWR)	17,000	17,000	17,000	17,000
MEASUREMENTS				
Wheel Base Ford/Chevy	138"/139"	171"/172"	213"/214"	223"/224"
Exterior Length (without ladder)*	22'8"	27'4"	30'11"	31'11"
Exterior Height (with air conditioner)	10'7"	10'7"	10'7"	10'7"
Interior Height	80"	80"	80"	80"
Awning Size	13'	13'	13'	13'
TANK CAPACITIES				
Fuel Ford/Chevy (gallons)	37/35	55/57	55/57	55/57
LPG (pounds)	41	41	41	41
Fresh Water (gallons)	39	33	33	33
Waste Water (gallons)	26	25	25	25
Gray Water (gallons)	26	23	23	22
Water Heater (gallons)	6	6	6	6
Furnace (BTUs)	25,000	25,000	25,000	25,000

*Add 11" for Chevy chassis length

BODY CONSTRUCTION/ EXTERIOR

STANDARD

- ❑ Fully welded tubular steel floor system
- ❑ Vacu-Bond laminated roof, walls and floors with high-density block foam insulation
- ❑ Fully welded tubular aluminum roof and sidewall cage construction
- ❑ Slick fiberglass exterior sidewalls
- ❑ One-piece fiberglass front and rear caps
- ❑ Insulated ceiling ducted air conditioning and residential style heating
- ❑ Premium one-piece TPO roof—Energy Star approved and labeled
- ❑ Rubber tread entry steps
- ❑ Clear acrylic entry grab handle

OPTIONS

- ❑ Exterior paint package
- ❑ Full-body paint package
- ❑ Automatic electric entrance step
- ❑ Electric "legless" patio awning
- ❑ Manual "legless" patio awning
- ❑ Aluminum roof ladder
- ❑ Exterior shower

AUTOMOTIVE/COCKPIT STANDARD

- ❑ 5,000-lb. trailer hitch
- ❑ Windshield privacy curtain
- ❑ Oversized AM/FM radio with large buttons, compact disc player, and weather band
- ❑ Power window and door locks
- ❑ Deluxe exterior mirrors
- ❑ Fiberglass running boards
- ❑ Stainless Steel wheel liners

OPTIONS

- ❑ Ford diesel engine with propane generator conversion (26BE only)
- ❑ Infiniss™ Leather driver and passenger captain's chairs
- ❑ Power driver's seat (Ford chassis only)
- ❑ Back-up monitor
- ❑ Upgrade dash insert with drink tray
- ❑ Heated remote exterior mirrors (Ford chassis only)
- ❑ Spare tire kit with cover

INTERIOR

STANDARD

- ❑ Full 6'8" interior ceiling height
- ❑ Residential linoleum (galley, bath and entry way)
- ❑ Metal entry grab handle
- ❑ 13,500 BTU low-profile ducted roof air conditioner
- ❑ Fluorescent ceiling lighting
- ❑ Oak cabinetry
- ❑ Raised panel upper cabinet doors
- ❑ Hardware with Brushed Nickel finish
- ❑ Adjustable shelves in overhead galley cabinets
- ❑ Low friction roller drawer guides
- ❑ Day/night shades throughout
- ❑ Soft Touch vinyl ceiling
- ❑ Booth dinette
- ❑ Fabric jackknife sofa

OPTIONS

- ❑ Cherry or Maple cabinetry
- ❑ 15,000 BTU low profile air conditioner with heat pump
- ❑ Fantastic® fan
- ❑ Fabric hide-a-bed sofa (29BG only)

Floorplans

- ❑ Infiniss™ Leather hide-a-bed sofa (29BG only)
- ❑ Sofa with pedestal table in place of booth dinette (not available on 21BC with Ford chassis)
- ❑ Infiniss™ Leather sofa with pedestal table in place of booth dinette (not available on 21BC with Ford chassis)

GALLEY

STANDARD

- ❑ 6-cubic-foot double door refrigerator
- ❑ 3-burner high-output gas range top
- ❑ Power range hood
- ❑ Range cover
- ❑ Microwave oven
- ❑ Laminate countertops
- ❑ Flip-up countertop extension (26BE, 29BG and 31BH only)
- ❑ Stainless Steel double bowl sink
- ❑ Full extension drawer guides

OPTIONS

- ❑ 3-burner high output gas range top with oven
- ❑ Solid surface kitchen countertop with Stainless Steel microwave oven
- ❑ Convection microwave in place of standard microwave
- ❑ Decorative raised panel wood refrigerator front

ENTERTAINMENT

STANDARD

- ❑ 24" television in cab-over with remote control
- ❑ Cable television and satellite prep
- ❑ Television antenna and booster

OPTIONS

- ❑ 20" LCD television with removable mount in bedroom (26BE, 29BG and 31BH only)
- ❑ Home theater system with DVD player
- ❑ Outside entertainment center with compact disc player (not available on 21BC)
- ❑ DVD player
- ❑ Satellite dish

BEDROOM/BATHROOM

STANDARD

- ❑ Queen-size bed with innerspring mattress, memory foam top and decorative headboard (26BE and 29BG only)

- ❑ Tub/shower surround with decorative stone pattern
 - ❑ Skylight in shower
 - ❑ Power bath vent
- ### OPTIONS
- ❑ Glass shower door
 - ❑ Twin beds with nightstand (31BH only)

SAFETY/CONVENIENCE

STANDARD

- ❑ Entry door with deadbolt lock
- ❑ Telephone jack
- ❑ Smoke detector
- ❑ Fire extinguisher
- ❑ LPG detector
- ❑ Carbon monoxide detector
- ❑ Three-point seatbelts for the driver and passenger
- ❑ Driver and passenger air bags

OPTIONS

- ❑ Convenience package: keyless entry, two-way radios and valve stem extenders

ELECTRICAL SYSTEMS

STANDARD

- ❑ 30-amp service
- ❑ Systems monitor panel
- ❑ 6-gallon gas water heater
- ❑ Water heater bypass system
- ❑ Battery disconnect switch

OPTIONS

- ❑ Guardian RV Quietpac™ 40G generator (3600 watts)
- ❑ Onan® RV Microquiet™ 4000 generator (4000 watts)
- ❑ Onan® RV Microquiet™ 3600 LP generator (3000 watts) (requires Ford diesel chassis)
- ❑ Emergency start switch

STORAGE AREAS

STANDARD

- ❑ Seamless roto-cast storage compartments
- ❑ Flush mount radius luggage doors

OPTIONS

- ❑ Heated holding tanks

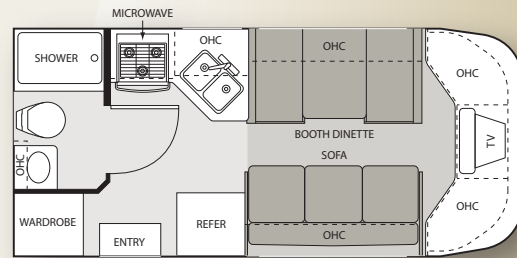

21BC

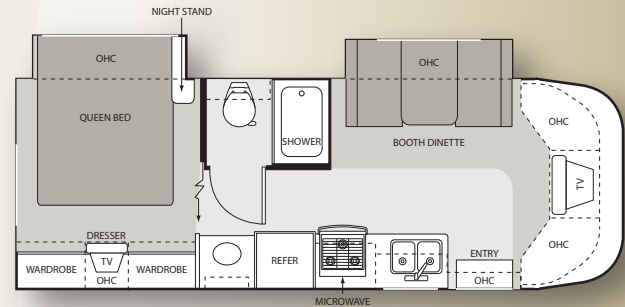

26BE

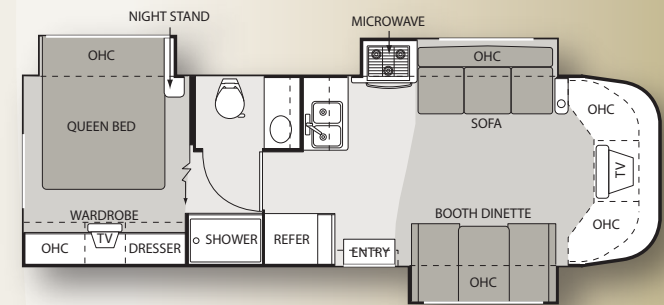

29BG

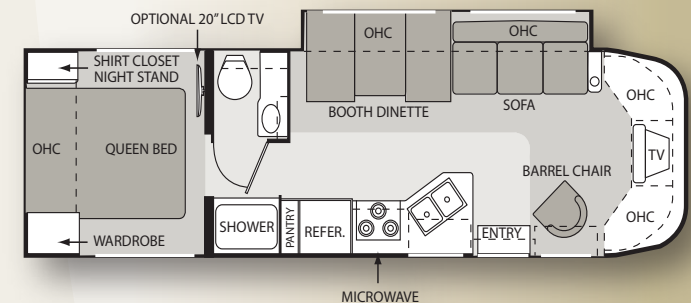

31BH

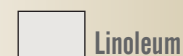

THE FOUR WINDS INTERNATIONAL QUALITY DIFFERENCE

What sets Four Winds International apart from other manufacturers? It's a better level of quality built in each motorhome from the inside out. It's exceptional value that is integrated into each design. It's a dedication to innovation that allows us to continually improve our motorhomes. Our ultimate goal is to build the right combination of quality, functionality and durability so you get many years of enjoyment from your new motorhome. It's a commitment we take seriously, and one on which you can depend.



**3-Year/
45,000
Mile
Limited
Structural
Warranty***

THE DIFFERENCE IS CLEAR

At Four Winds International (FWI), we strive to go beyond your expectations with every motorhome we build. By doing so, you will be able to enjoy a better quality of life while on the road.

All FWI motorhomes come with a full one-year, 15,000 mile bumper-to-bumper warranty, as well as a three-year, 45,000-mile limited structural warranty. Our nationwide dealer network is fully equipped and trained to meet your service needs. The FWI support staff has many years of experience, and is available to provide assistance on all technical, service and warranty issues. For complete warranty details, contact your Four Winds International dealer.

FWI is proud to offer high-quality products and support services that result in customer satisfaction—one customer at a time. So whether you are a first-time recreational vehicle owner, or an experienced one, we're confident that you'll enjoy years of adventures in your new motorhome. This is the Four Winds International difference.

VEHICLE LOADING

Every effort has been made to provide the greatest number of options for the recreation vehicle owner. Along with these choices comes the responsibility to manage the loads that are imposed by the choices so that they remain within the manufacturer's specified chassis weight limits. Do not overload the recreation vehicle.

DRY WEIGHTS

Based on standard features; optional equipment not included. Net carrying capacity (NCC) determined by subtracting unloaded vehicle weight (UVW) from gross vehicle weight, (GVWR) and includes fluids, options, and cargo. Liquid capacities and weights are approximations only.

Product information, specifications, and photography in this brochure were as accurate as possible at time of printing. Photographs may contain some features that are optional on your vehicle. Since we continually strive to improve our products, actual products may differ. Prices and specifications are subject to change without notice. All capacities are approximate and dimensions are nominal. Some features or options may be different or unavailable in Canada.

WARNING

This information is intended as a guide only. Weights of individual vehicles may vary. Consult your owner's manual for complete loading, weighing, and towing instructions.

IMPORTANT

Towing capacity may vary by chassis model, floorplan, options and loading of the vehicle. This may result in a towing capacity which is less than the maximum capacity of the hitch. Do not exceed the vehicle's Gross Combined Weight Rating (GCWR), or the hitch rating. A separate functioning brake system is required for any towed vehicle or trailer weighing more than 1,000 lbs. (450 KG) when fully loaded.

WHY THOR IS YOUR BEST RV VALUE

Thor Industries, Inc., listed on the New York Stock Exchange (THO), proudly traces its history back over 70 years to the pioneering days of the recreational vehicle industry with the founding of Airstream, the industry's oldest and most renowned brand. Our total commitment to quality and our philosophy of putting our customers first has led to our continuous growth.

Today, Thor is the largest builder of recreational vehicles. Thor's strong financial condition and years of solid growth are your assurance that we will be here to serve you for years to come. We think this extra peace of mind is important when you are making a significant investment. Because our customers are always #1 with us, we work harder than other manufacturers to satisfy you.



© 2006 Four Winds International Litho USA 1006-35M

FW
Four Winds
INTERNATIONAL

P.O. Box 1486 • Elkhart, Indiana 46515-1486

Phone: 574-266-1111 • Fax: 574-294-8971

www.fourwinds-rv.com