

2007

CLASS C
MOTORHOMES

ENDURA

DEDICATED TO QUALITY,
INNOVATION AND
VALUE.

ENDURA





LIVING AREA WITH OPTIONAL CABOVER BED AND SIDE-OVER LCD • MODEL 6331, 6340

The main living space features hardwood cabinetry, full kitchen, deluxe carpet, Comfort Plus sofa, dinette seats, and stand alone chair, residential hardwired lighting, and fixtures, and your choice of either a cabover sleeping, cabover entertainment center cabinet featuring a flat screen television and 5.1 surround sound system or the side-over LCD TV and DVD player to entertain you and your family during your travels.

GULF STREAM





LIVING AREA WITH OPTIONAL CABOVER BED AND SIDE-OVER LCD • MODEL 6331, 6340

The main living space features hardwood cabinetry, full kitchen, deluxe carpet, Comfort Plus sofa, dinette seats, and stand alone chair, residential hard wood floors, and fixtures, and your choice of either a cabover sleeping, cabover entertainment center, or dinette cabinet featuring a flat screen television and 5.1 surround sound system or the side-over LCD TV and DVD player to entertain you and your family during your travels.

GULF STREAM



COACH, INC.
FAMILY VEHICLES

ENDURANCE

Chevy Kodiak Chassis

Exclusively brought to you by Gulf Stream Coach

**MULTI-LEAF
SUSPENSION**

**RUST-PROHIBITIVE
COATING ON FRAME**

**ERGONOMICALLY
SPACED STEPS**

STABIL-RIDE™

Suspension System
The best just got better. The optional Stabil-Ride™ suspension system integrates parabolic leaf springs, auxiliary springs, a stabilizer bar and tuned shocks, designed to provide a low maintenance, stable ride comparable to the ride of a diesel pusher. Enjoy unsurpassed handling with reduced body sway particularly while cornering and superior straight-line stability.

Gulf Stream specifies an extra heavy duty hitch rated at 10,000 lb, however it is up to the owner not to exceed the Gross Combined Weight Rating (gcwr). gcwr is calculated as follows:

- 22,000 gcwr is loaded to its maximum of 22,000 lb, this would leave towing capacity of 4,000 lb. to the 26,000 gcwr.
- 19,500 gcwr is loaded to its maximum of 19,500 lb, this would leave a 4,500 lb. towing capacity to 26,000 gcwr.

Towing capacity can be increased by reducing payload appropriately.

- INTENSE 22,000 LB. GVWR (6378)
- 19,500 LB. GVWR (6331, 6340, 6316)
- SUPERIOR TOWING CAPACITY 26,000 GCWR
- 10,000 LB. HITCH RATING

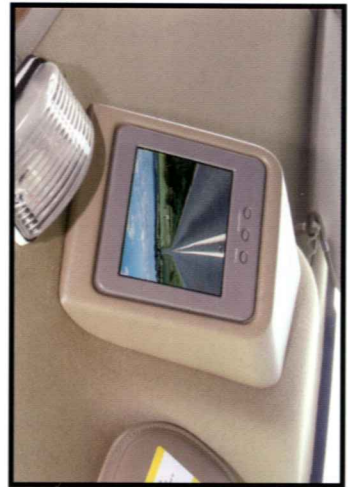

Backup monitor built in the overhead console for unobstructed viewing and safer backing

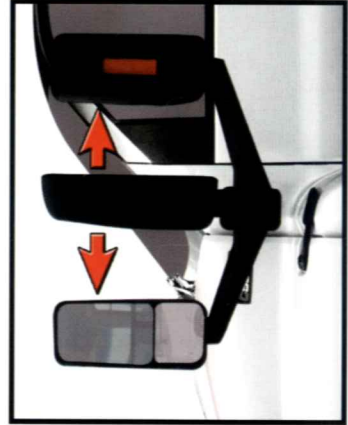

Breakaway mirrors fold 90 degrees inward or outward to manage tight spaces reducing the risk of damage



126-square inch-surface mirror including a 6x7 inch convex section on both mirrors.



BREAKAWAY MIRRORS

**EASY ACCESS
PULL FORWARD HOOD**

**POWERFUL CHEVROLET
VORTEC GAS OR
DURAMAX DIESEL**

**UP-LEVEL HEADLIGHTS
WITH CHROME TREATED
FRONT BUMPER AND GRILL**

**FOUR WHEEL
DISC BRAKING**

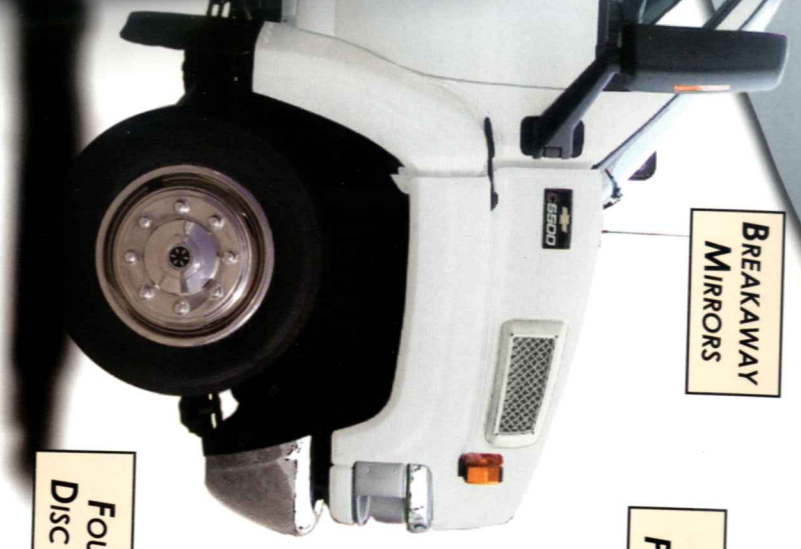

- 19.5" TIRES
- DRIVER AND PASSENGER AIRBAGS
- DAYTIME RUNNING LIGHTS
- AM/FM CD PLAYER

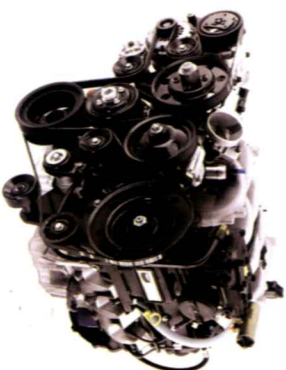

**VORTEC™ 8.1 LITRE V8
GASOLINE ENGINE (standard)**
HP 325hp
Torque LB-FT 450



**DURAMAX™ 6600 V8
TURBO DIESEL ENGINE (optional)**
HP 300hp
Torque LB-FT 605

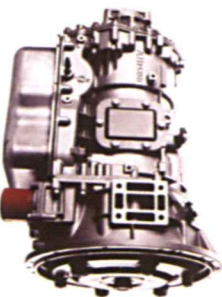

**ALLISON™ 1000 SERIES
AUTOMATIC TRANSMISSION (standard)**
5 speed 1000
Gross Torque (lb-ft) 620

VISIBILITY AND MANEUVERABILITY

Negotiating a tricky curve in the campground or on a major city street there will be no reason to worry while you're in the Chevrolet Kodiak. With a 54 degree turning radius, giant mirrors, large windshield and sloped hood this vehicle drives more like a light duty truck. Sloped hood allows the driver to see just a mere 13 feet in front of them, doubling their field of vision versus the competition's 26 feet!



ENDURA

SOLID HARDWOOD CABINETS



**PREDRILLED
HARDWOOD
CONSTRUCTION**

Our residential style cabinets are constructed of solid hardwood doors and fronts that are predrilled and screwed then they are stained and top coated with a furniture grade finish that provides long lasting beauty and durability as well as adding strength and quietness to your motorhome.



COMPETITOR'S CABINETS

Other companies use wrapped cabinet fronts prone to peeling, fading and tearing. The softer composite wood used does not hold screws as well as hardwood resulting in loss of strength and squeaking. Discoloration will degrade the beauty and lower the value of the motorhome.

**GALVANIZED
STEEL
STORAGE
COMPARTMENTS**

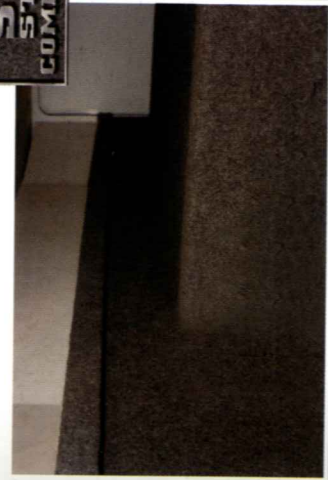

Seamless, carpeted, galvanized steel storage compartments safely cradle your valuables. Rust protective paint and foam sealed, extended life and a quiet ride.

Excellent Weathering - Maintaining the vehicle's quality appearance enhances its resale value.

Tear Resistance - Flexroofs hard abuse resistant finish resists tearing, a condition that can cause leaks and lead to expensive repair.

Low Maintenance - Road grime can easily be removed with normal cleaning maintenance. Rubber chalking due to solar breakdown of the roof surface is eliminated, preserving the original appearance and resale value of the vehicle.

Stain Resistance - Fiberglass Flexroof is designed to resist staining and maintain its quality appearance.

Structural Integrity - Unlike conventional EPDM rubber roof membranes, Flexroof is a structural component of the roof system.

Textured Fiberglass - Helps dissipate heat and prevents free limbs from tearing or scratching your roof.

Seamless
FIBERGLASS ROOF



Comfort Plus furniture by Gulf Stream Coach features residential styling, solid construction, total comfort and a comprehensive warranty.

FLUSH FLOOR
slide out rooms



Gulf Stream offers true flush floor slide out rooms to give you more headroom in the slide and eliminates the step up into the slide room that you will experience in many of our competitors motorhomes.

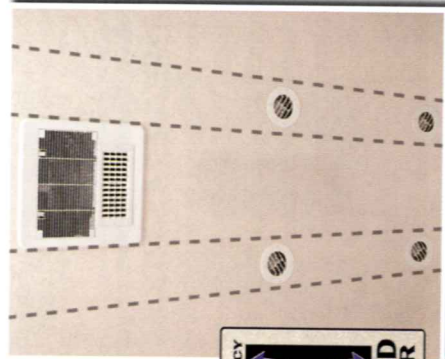

**HIGH EFFICIENCY
VAC
H-DUCTED
ROOF AIR**

Dual metal H-Ducted air conditioning system with foil bubble wrapped insulation for superior climate control.



The Endura has nearly 7' interior ceilings for a residential look and feel with 6 foot ceilings in the slideroo

Cradle of Strength

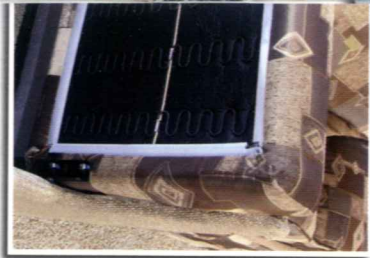

1. Seamless Fiberglass Roof For Greater Energy Efficiency and Dependability.
2. Luan Decking for Additional Strength.
3. Molded, High Density EPS (Expanded Polystyrene) Roof Brick Insulation - Provided Consistent Insulation Value as well as Superior Dimensional Rigidity.
4. One-Piece Formed Aluminum Air Conditioning Duct, Completely Surrounded By EPS Insulation.
5. Bubble-Wrapped Foil Insulation Provides Superior Insulation and Helps Prevent Condensation.
6. Rugged Welded Tubular Aluminum Roof Framing.
7. Rugged Heavy-Gauge Tubular Aluminum, Fixture Welded to Form the Sidewall Framing.
8. High-Density EPS Insulation Provides Superior Lamination and Bonding Characteristics and Insures Greater Energy Efficiency.
9. Interior Wall Panels Securely Laminated to Sidewall Framing.
10. "Super-Slick" Fiberglass Exterior Vacuum-bond Laminated to Sidewall Framing for Lasting Beauty and Durability.
11. High-Quality Stain-Resistant Carpeting Available in Designer Coordinated Colors.
12. Extra-Thick Padding Under Carpet Provides Extra Comfort and Increases Carpet Durability.
13. Seamless Structurewood Floor Decking Laminated to Steel Floor Structure Assures a Quiet, Long-Lasting Rigid Floor.
14. Heavy-Gauge Tubular Steel Framing, Fixture Welded for Extra Strength and Stability.
15. Heavy-gauge Tubular Steel Framed, Fixture Welded Floor Truss System Provides the Strongest Foundation in the Industry.
16. Seamless Layer of Galvanized Steel Securely Laminated to the Steel Floor Framing.
17. Galvanized Steel Used to Form Each Storage & Holding Compartment.
18. Durable All-Weather Carpeting Completes Each Accessible Storage Compartment, Providing Extra Protection for Luggage and Valuables.
19. Rust-Prohibitive Paint Coating Applied to All Steel Framing Assures Corrosion and Rust Protection.
20. The Industry's Strongest, Most Spacious Exterior Storage Compartments.
21. Reinforced Heavy-Gauge Steel "W" Transition.

SUPER STRENGTH TRUSS SYSTEM



8" C CHANNEL EXTENSION

TUFF TRUSS
6000 lbs.

TAKE THE TIME TO COMPARE...

and you will see the exceptional value of a Gulf Stream Coach

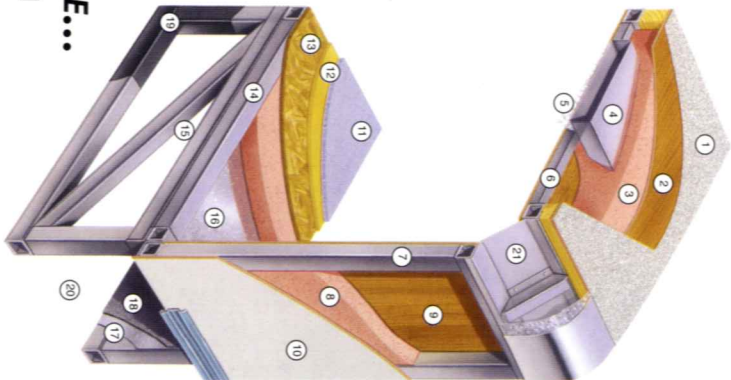

The Cradle of Strength super strength truss system is unmatched in the RV industry. The structural subfloor foundation begins by welding a network of integrated steel trusses to the chassis rail. Specifically designed to distribute and transfer the tremendous forces from the coach to the chassis rail these trusses are individually tested to withstand 6,000 pounds each.

When the chassis is stretched, Gulf Stream stands alone in the industry by using a full 8" C channel extension versus the traditional 4" or less. This practice adds to the strength of the foundation and offers peace of mind that towing is safe on an extension that is true to the chassis.



TAN



GREEN



CARPET

Available only with Tan & Green

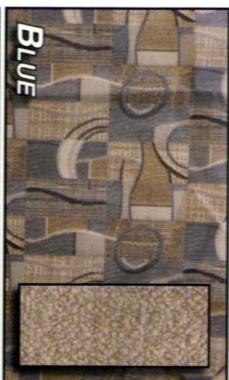

BLUE

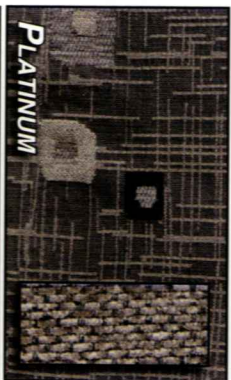

PLATINUM



CARPET

Available only with Blue & Platinum



ISLAND PALM



CARPET

Available only with Silver

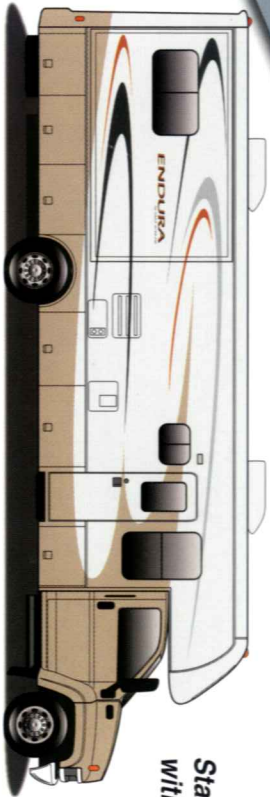

**Standard Paint
with Hi-Tech Vinyl Graphics**



Optional Full Body Paint Burgundy & Tan



Optional Full Body Paint Black & Tan

Popular Options

- ENDURA PACKAGE (REQUIRED)
- 7' INTERIOR HEIGHT
- ONE-PIECE FIBERGLASS ROOF
- SUPER SILK FIBERGLASS W/BACK SIDEWALLS
- EXTERIOR PAINTED GRAPHICS
- BUS STYLE SLAM LATCH BAGGAGE DOORS
- G SOUND
- FLUSH FLOOR SLIDE
- FULL ENTERTAINMENT CENTER
- W/FLAT SCREEN COLOR TV (6331 6340)
- DIESEL PACKAGE (6331 6340)
- 22,000 GVWR DURAMAX 6.6 L DIESEL CHASSIS (239" WB)
- ELECTRONIC EXHAUST BRAKE
- 5.5 OMAN DIESEL GENERATOR
- DIESEL PACKAGE (6362)
- 22,000 GVWR DURAMAX 6.6 L DIESEL CHASSIS (239" WB)
- ELECTRONIC EXHAUST BRAKE
- 5.5 OMAN DIESEL GENERATOR
- DIESEL PACKAGE (6362)
- 22,000 GVWR DURAMAX 6.6 L DIESEL CHASSIS (239" WB)
- ELECTRONIC EXHAUST BRAKE
- 5.5 OMAN DIESEL GENERATOR
- CARPET THROUGHOUT COACH
- UPGRADED DASH
- VINYL CEILING LINER
- 3-SPEED FANTASTIC ATTIC FAN
- SPARE TIRE
- 15,000 BTU LOW PROFILE DUCTED ROOF AC IPO 13,500
- HEATED HOLDING TANKS
- FRONT CABOVER WINDOW (6331 6340)
- THERMO-pane WINDOWS
- (NA ON 6331 & 6340 UNLESS DSL PKG IS CHOSEN)
- STABIL-RIDE STABILIZER (REQUIRED)
- ELECTRIC MAIN AWNING
- FULL BODY PAINT - BURGUNDY & TAN
- FULL BODY PAINT - BLACK & TAN
- CABOVER BED W/LCD COLOR TV & DVD PLAYER (6331 6340)
- LOD FLAT SCREEN TV W/REMOTE IN REAR BEDROOM (6362)
- FLAT SCREEN COLOR TV W/REMOTE (REAR BEDROOM) (6331 6340)
- (7) FLUORESCENT CEILING LIGHTS
- OUTSIDE ENTERTAINMENT CENTER (6331 6340)
- PHONE JACK
- DSS PRE-WIRE
- BACK-UP MONITOR
- 5.5 OMAN GAS GENERATOR (NA W/DIESEL PKG)
- 6-WAY OPTIMA DRIVER/PASSENGER SEATS
- SOFT TOUCH OPTIMA H-A-B SOFA
- IPO CLOTH (DS) (6331 6340)
- SOFT TOUCH OPTIMA J-KNIFE SOFA IPO CLOTH (DS) (6362)
- SOFT TOUCH OPTIMA J-KNIFE SOFA IPO CLOTH (PS) (6362)
- FREE STAND DINETTE W/2 CHAIRS (6331 6340)
- (2) ADDITIONAL FOLDING CHAIRS (6331 6340)
- EURO RECLINER IPO BARREL CHAIR (6331 6340)
- (2) EURO RECLINERS W/FLIP UP TABLE IPO PS SOFA (6362)
- 2-WAY DOUBLE DOOR REFER

- Chassis**
- 19,500 GVWR CHEVY, KODIAK V8 ENGINE, 80 GAL FUEL TANK W/ POWER LOCKS & WINDOWS (6331 6340)
 - 22,000 GVWR CHEVY, KODIAK V8 ENGINE, 80 GAL FUEL TANK W/ POWER LOCKS & WINDOWS (6362)

- Exterior**
- WELDED ALUMINUM PERIMETER FRAME
 - LAMINATED 3/8" STRUCTURE BOARD STEEL FLOOR FRAME
 - FIBERGLASS FRONT CAP
 - SLIDE OUT ROOM (BOOTH DIN, SOFA) (6331 6340)
 - SLIDE OUT ROOM (KING BED) (6331)
 - SLIDE OUT ROOM (6340)
 - (BED) (WARDROBE) (6362)
 - (BED) (WARDROBE) (DINETTE)
 - SLIDE OUT ROOM (6362) (KITCHEN/ SOFA/REFER)
 - RADIUS TINTED WINDOWS
 - FRONT CABOVER WINDOW (6362)
 - LIGHTED TRUNK BOXES
 - REAR MUD FLAPS
 - UNDER CHASSIS SPARE TIRE CARRIER
 - LADDER
 - METAL WRAP MAIN AWNING
 - (2) SLIDE OUT TOPPERS
 - STAINLESS STEEL WHEEL INSERTS
 - HEATED & REMOVED INTERIOR SIDEVIEW MIRROR

- Decor**
- FOAM SEAL & UNDERCOATING
 - BEAD BOLT LOCK ENTRY DOOR
 - ACRYLIC ENTRY DOOR ASSIST BAR
 - LEVELING JACKS
 - HITCH W/PLUG
 - AUTO ELECTRIC STEP
 - OUTSIDE RINSE & WASH (NA 6331)

- Power**
- (2) AUXILIARY BATTERIES
 - 50 AMP SERVICE W/AUTO CHANGEOVER & CONVERTER
 - GENERATOR PREP
 - BATTERY DISCONNECT
- Heating & Cooling**
- DASH AC
 - 13,500 BTU LOW PROFILE DUCTED AC (FRONT)

- Bath**
- DELUXE STOOL
 - SKYDOME
 - POWER BATH VENT
 - CORNER SHOWER W/SURROUND
 - NEO-ANGLE SHOWER DOOR

- Electrical**
- EMERGENCY START SWITCH
 - TV ANTENNA WITH AMP & BOOST
 - MONITOR PANEL
 - GENERATOR SWITCH & HOUR METER
 - TV JACK IN BEDROOM
 - CABLE TV READY
 - CEILING LIGHT WALL SWITCH
 - CD PLAYER
 - 20" LCD COLOR TV IN DINING AREA (6362)
 - 26" ISLAND ENTERTAINMENT CENTER (6362)
- Furnishings**
- QUEEN BED W/ LIFTS, INNERSPRING MATTRESS, BEDSPREAD & PILLOWS (6340 6362)
 - KING BED W/LIFTS, INNERSPRING MATTRESS, BEDSPREAD & PILLOWS (6331)
 - COMFORT PLUS DINETTE BENCH BED (6331 6340)

- Apliances**
- CONVECTION MICROWAVE
 - W/3-BURNER TOP
 - 6 GAL ELECTRONIC IGNITION WATER HEATER W/BY-PASS VALVE
 - SM, 2-WAY DBL DOOR REFER
 - LP GAS TANK
 - CARBON MONOXIDE DETECTOR
 - LP LEAK DETECTOR

- Appliances**
- 11,000 BTU LOW PROFILE DUCTED AC (BEDROOM)
 - 35,000 BTU FURNACE
 - 2 WAY DRIVER PASSENGER SEATS
 - SINGLE BARREL CHAIR (PS) (6331 6340)
 - H-A-B SOFA (DS) (6331 6340)
 - JACK KNIFE SOFA (PS) (6362)
 - JACK KNIFE SOFA (DS) (6362)
 - PLEATED PRIVACY DOOR (6331 6340)
 - INSIDE HANDRAIL (6331 6340)
 - FREE STANDING DINETTE TABLE W/(4) CHAIRS (6362)

Over your unlimited mileage trial use warranty, under normal use against defects in material and/or workmanship in construction and original components, we warrant the structure of the side walls, floor and back walls, roof and floor to the structure of the side walls, floor and back walls, roof and floor. See the official written Gulf Stream Coach, Inc. Limited Warranty for details.

**2 YEAR
UNLIMITED MILEAGE
TRANSFERABLE
WARRANTY**
ON STRUCTURAL COMPONENTS

Coach-Net
24 HR. EMERGENCY ROADSIDE ASSISTANCE

- One Year Coach-Veh Membership
- Towing and Winching
- Flat Tire Change
- Mobile Mechanic
- Delivery of emergency Fluids
- Jump-Start/ Battery Boost
- Lockout



DEDICATED TO QUALITY,
INNOVATION AND
VALUE.

Gulf Stream Coach

has been a manufacturer of recreational vehicles for over 20 years. Our slogan, "Family Value", speaks to our family-owned company, the value offered in our products and to our customers.

We use advanced manufacturing techniques to build everything from entry-level travel trailers to luxury motorhomes. We offer the largest product line in the industry.

RV dealers and consumers look to Gulf Stream for high-value products offering quality construction, innovative features, contemporary design, unmatched service and on-going support.

We'd love to have you as part of the family

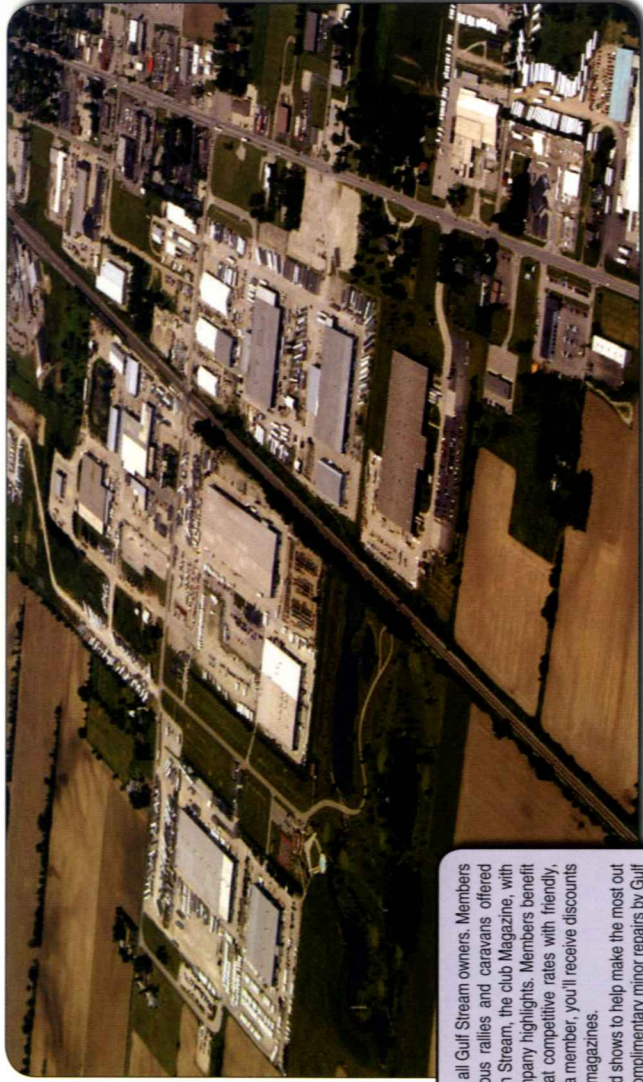

The Gulf Streamers RV Club is a valuable benefit to all Gulf Stream owners. Members enjoy staying active and participating in the various rallies and caravans offered throughout the United States and Canada. The Main Stream, the club Magazine, with up-to-date product information, service tips and company highlights. Members benefit from the Emergency Road Service and Gulf Streamers Insurance options. Both are available at competitive rates with friendly, reliable service. The 10% discount program at campgrounds throughout the U.S. and Canada. As a member, you'll receive discounts at National Theme Parks and special attractions, including RV and travel guides, directories and magazines.

Gulf Streamers spend time touring attractions, enjoying fabulous meals, taking in area highlights and shows to help make the most out of your RV experience. Special rallies throughout the year include Gulf Stream supplier seminars, complimentary minor repairs by Gulf Stream technicians, Gulf Stream dealer product displays and round table discussions to voice your product improvement ideas.



POST OFFICE BOX 1005
• YOUR GULF STREAM COACH DEALER •



NAPPANEE, IN 46550

VISIT

WWW.GULFSTREAMRV.COM OR CALL
1-800-765-8787-EXT. 3288

For more information and available options, contact your local Gulf Stream dealer, www.gulfstreamrv.com or Gulf Stream Coach, Inc. Gulf Stream Coach, Inc. reserves the right to make changes in prices, materials, components and specifications and to discontinue models at any time without notice or obligation. Gulf Stream Coach, Inc. assumes no responsibility for any errors or omissions in this literature. Photographs may show equipment or items that are optional and are not included in the purchase price of the vehicle. Test drive and review a current model at your nearest Gulf Stream Coach, Inc., Nappanee, Indiana. © 2002 Gulf Stream Coach, Inc. 8/06-SP-15K Vert