

WINDSPORT 07

Class A Motorhome



FW Four Winds
INTERNATIONAL



Above: Shown with Tandem Taupe interior, Cherry cabinetry and jackknife sofa.

Top, middle and lower right: Model 31H shown with Ebony Reflection interior and Maple cabinetry.



The Windsport Class A motorhome offers the perfect blend of world-class comfort and contemporary style. With a choice of innovative floorplans, you'll find a model to meet your needs, tastes and lifestyle.

Once you experience the Windsport, nothing else quite measures up. In comfort. In quality. And in value.

The Windsport is designed to meet a wide range of lifestyle needs—from the casual to full-time recreational vehicle enthusiast. These versatile double slide-out models feature a spacious living area, fully equipped kitchen, cozy bedroom and bath area with all the conveniences of home.

For example, Model 32E is a triple slide-out floorplan packed with great amenities. They include a hide-a-bed sofa, L-shaped kitchen, side aisle hallway and full bath with two entry doors.

All Windsport motorhomes are built to meet high quality standards—from the inside out.

Interior Decor

Ebony Reflection

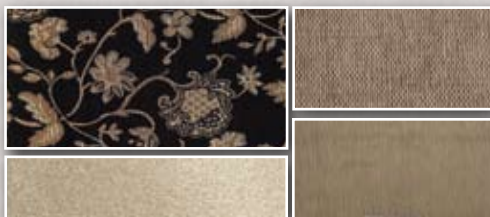

Janus Steel



Tandem Taupe



Standard Oak



Optional Maple



Optional Cherry

Windsport Features

BODY CONSTRUCTION/EXTERIOR

STANDARD

- Tubular steel welded floor system
- Vacu-Bond laminate roof, walls and floors with high-density block foam insulation
- Fully welded tubular aluminum roof and sidewall cage construction
- Air conditioning ductwork molded into roof insulation
- Premium one-piece TPO roof—Energy Star approved and labeled
- Automatic electric entry step
- Patio awning
- Roof ladder

OPTIONS

- Choice of exterior paint packages
- Slick fiberglass exterior
- Hydraulic leveling jacks
- Exterior shower

AUTOMOTIVE/COCKPIT

STANDARD

- 5,000-lb. trailer hitch
- Wood grain dash insert
- Dash fans
- Deluxe exterior mirrors and phone jack
- One-piece fiberglass front and rear caps
- Fog lights
- Oversized AM/FM radio with large buttons, compact disc and cassette player, and weather band
- Generator start switch on dash
- 19.5" tires
- Stainless Steel wheel liners

OPTIONS

- Infiniss™ Leather driver and passenger captain's chairs
- Six-way power driver's seat
- Back-up monitor with one-way audio

- Heated remote exterior mirrors
- Spare tire with rim

INTERIOR

STANDARD

- Residential linoleum (galley, bath and entry way)
- Metal entry grab handle
- 13,500 BTU roof air conditioner
- Oak cabinetry
- Overhead lights in living room
- Raised panel wall cabinet doors
- Hardware with Brushed Nickel finish
- Mini-blinds throughout
- Soft Touch vinyl ceiling
- Fabric hide-a-bed sofa (31D and 32E only)

OPTIONS

- Cherry or Maple cabinetry
- 13,500 BTU rear roof air conditioner (requires 50-amp service and 5500-watt generator)
- Day/night shades throughout
- Fantastic® fan in kitchen
- Dual pane windows
- Residential linoleum throughout
- Infiniss™ Leather sofa (30Q and 31H only)
- Infiniss™ Leather hide-a-bed sofa (31D and 32E only)
- Fabric sofa with pedestal table in place of dinette (not available on 30Q)
- Infiniss™ Leather sofa with pedestal table in place of dinette (not available on 30Q)

GALLEY

STANDARD

- Double door refrigerator
- 3-burner high-output gas range top with oven
- Microwave oven
- Laminate countertops
- Large Stainless Steel double bowl sink

- Full extension metal drawer guides
- Flip-up countertop extension

OPTIONS

- Convection microwave with 3-burner high-output range top

ENTERTAINMENT

STANDARD

- Cable television and satellite prep
- 20" television in front overhead
- Television cabinet in bedroom

OPTIONS

- Home theater system with DVD player and recessed ceiling speakers
- DVD player
- Satellite dish
- Outside entertainment center with compact disc player
- 14" television in bedroom

BEDROOM/BATHROOM

STANDARD

- Inner spring mattress
- Bedspread and pillow shams
- Attractive headboard with sconce wall lighting
- China bowl toilet
- Neo-angled shower with glass door (not available on 30Q)

OPTIONS

- Twin beds with nightstand (30Q and 31D only)
- Glass shower door (30Q only)

SAFETY/CONVENIENCE

STANDARD

- Entry door with deadbolt lock
- Telephone jack
- Smoke detector

- Fire extinguisher
- LPG detector
- Carbon monoxide detector
- Three-point seatbelts for the driver and passenger, and seatbelts throughout
- Three seatbelts in sofa

OPTIONS

- Utility package includes two-way radios and valve stem extenders

ELECTRICAL SYSTEMS

STANDARD

- Guardian RV Quietpack™ 40G generator (3600 watts)
- 30-amp service
- Marine-type detachable power cord
- 6-gallon gas water heater
- Water heater bypass system
- Battery disconnect switch
- Emergency start switch

OPTIONS

- Onan® RV Microquiet™ 4000 generator (4000 watts)
- Guardian RV Quietpack™ 55G generator (5500 watts)
- Onan® RV Marquis Gold™ 5500 generator (5500 watts)
- 50-amp service with gas/electric water heater
- Second auxiliary battery

STORAGE AREAS

STANDARD

- Large pass-through roto-cast storage compartments
- Flush mount radius luggage doors

OPTIONS

- Heated holding tanks



Floorplans

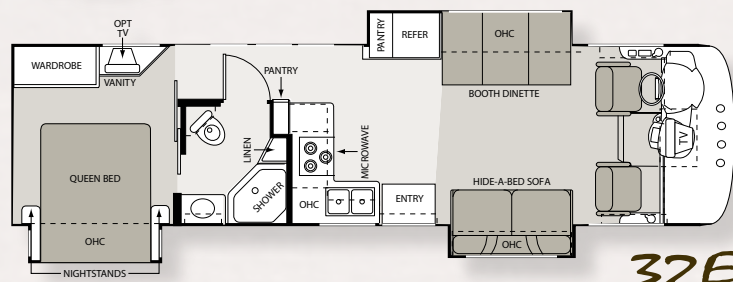
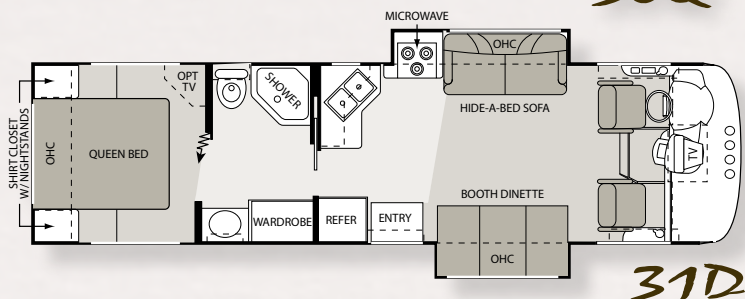
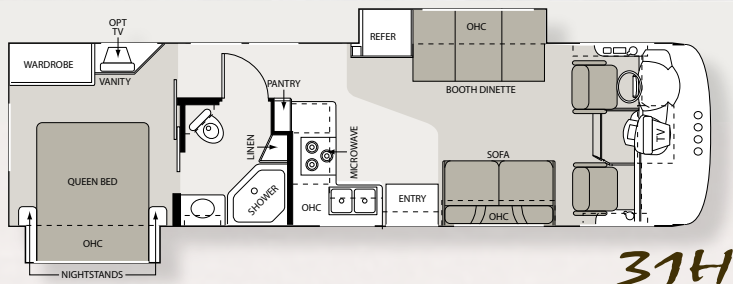
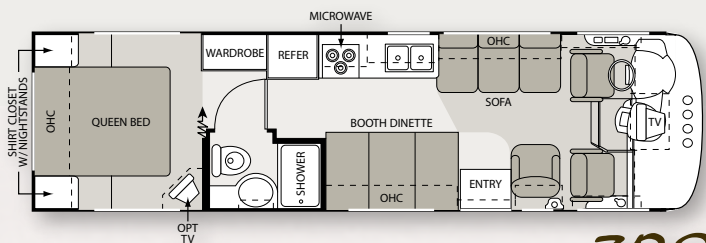

Exterior Choices



Sahara exterior paint option

Taupe Mist exterior paint option

Standard graphics exterior

Specifications

MODEL	30Q	31D	31H	32E
WEIGHT RATING (LBS.)				
Ford Chassis 6.8L Triton	V10	V10	V10	V10
Gross Vehicle (GVWR)	15,700	18,000	18,000	18,000
Gross Combined (GCWR)	26,000	26,000	26,000	26,000
Workhorse Chassis 8.1L Vortec	V8	V8	V8	V8
Gross Vehicle (GVWR)	16,000	18,000	18,000	18,000
Gross Combined (GCWR)	22,000	22,000	22,000	22,000
MEASUREMENTS				
Wheel Base	190"	190"	197"	212"
Exterior Length (without ladder)	31'5"	32'3"	32'10"	33'7"
Exterior Height (with air conditioner)	11'7"	11'7"	11'7"	11'7"
Interior Height	80"	80"	80"	80"
Awning Size	16'	16'	17'	18'
TANK CAPACITIES				
Fuel (gallons)	75	75	75	75
LPG (pounds)	64	64	88	88
Fresh Water (gallons)	52	52	50	50
Waste Water (gallons)	26	26	32	32
Gray Water (gallons)	44	44	43	43
Water Heater (gallons)	6	6	6	6
Furnace (BTUs)	35,000	35,000	35,000	35,000

* Available on units built after December 1, 2006

IMPORTANT:

Towing capacity may vary by chassis model, floorplan, options and loading of the vehicle. This may result in a towing capacity which is less than the maximum capacity of the hitch. Do not exceed the vehicle's Gross Combined Weight Rating (GCWR), or the hitch rating. A separate functioning brake system is required for any towed vehicle or trailer weighing more than 1,000 lbs. (450 KG) when fully loaded.

DRY WEIGHTS:

Based on standard features; optional equipment not included. Net carrying capacity (NCC) determined by subtracting unloaded vehicle weight (UVW) from gross vehicle weight, (GVWR) and includes fluids, options, and cargo. Liquid capacities and weights are approximations only.

WARNING:

This information is intended as a guide only. Weights of individual vehicles may vary. Consult your owner's manual for complete loading, weighing, and towing instructions.

VEHICLE LOADING:

Every effort has been made to provide the greatest number of options for the recreation vehicle owner. Along with these choices comes the responsibility to manage the loads that are imposed by the choices so that they remain within the manufacturer's specified chassis weight limits. Do not overload the recreation vehicle.



Product information, specifications, and photography in this brochure were as accurate as possible at time of printing. Photographs may contain some features that are optional on your vehicle. Since we continually strive to improve our products, actual products may differ. Prices and specifications are subject to change without notice. All capacities are approximate and dimensions are nominal. Some features or options may be different or unavailable in Canada.



© 2007 Four Winds International Litho USA 107-20M

FW
Four Winds
INTERNATIONAL

P.O. Box 1486 • Elkhart, Indiana 46515-1486

Phone: 574-266-1111 • Fax: 574-294-8971

www.fourwinds-rv.com