

Chateau

CITATION
BY FOUR WINDS INTERNATIONAL

2010



INTERIOR DECOR:

SEASCAPE II



CAPPUCCINO



PECAN SWIRL



A. MAIN PRINT FABRIC

B. ACCENT FABRIC



CABINETRY



STANDARD
CINNAMON MAPLE



OPTIONAL
CHERRY

EXTERIOR DECOR:



STANDARD GRAPHICS



FROSTED MINK FULL BODY PAINT



PARTIAL PAINT WITH VINYL GRAPHICS



TIGER EYE FULL BODY PAINT

CITATION STANDARD B+

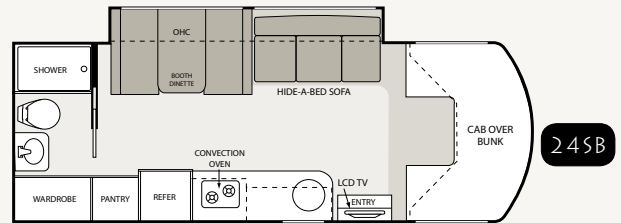
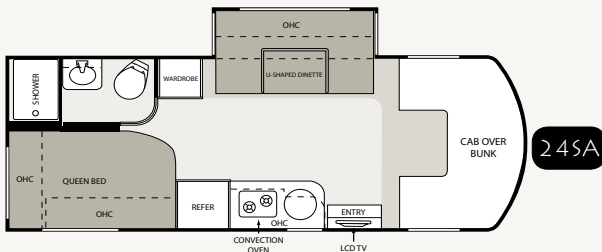
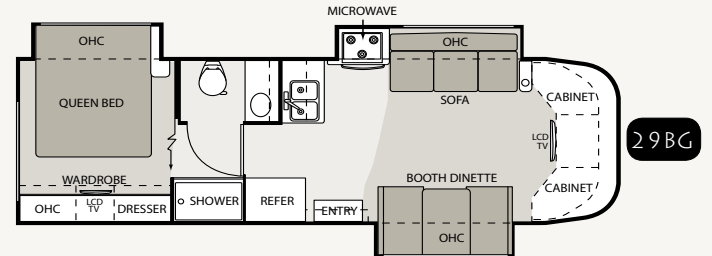
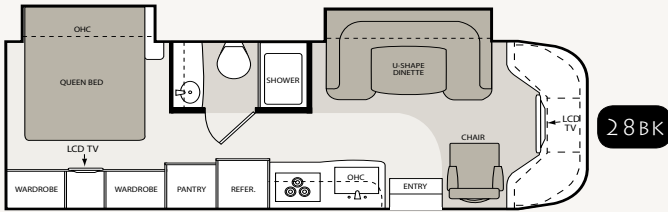
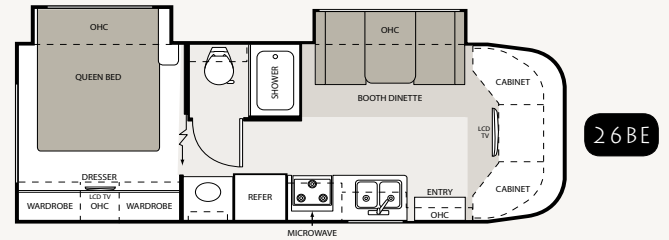
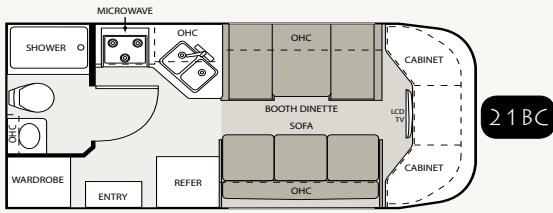

CITATION SPRINTER

SPECIFICATIONS

		Standard B+ models				Sprinter B+ models	
Model:		21BC	26BE	28BK	29BG	24SA	24SB
WEIGHT RATING (LBS.)	Ford Chassis - Triton Engine	5.4L/V-8	6.8L/V-10	6.8L/V-10	6.8L/V-10	N/A	N/A
	Gross Vehicle (GVWR)	11,500	14,500	14,500	14,500	N/A	N/A
	Gross Combined (GCWR)	13,000	20,000	20,000	20,000	N/A	N/A
	Chevy Chassis - Vortec Engine	6.0L/V-8	6.0L/V-8	6.0L/V-8	6.0L/V-8	N/A	N/A
	Gross Vehicle (GVWR)	12,300	14,200	14,200	14,200	N/A	N/A
	Gross Combined (GCWR)	16,000	17,600	17,600	17,600	N/A	N/A
	Sprinter Chassis - Turbo Diesel Engine	N/A	N/A	N/A	N/A	3.0L/V-6	3.0L/V-6
	Gross Vehicle (GVWR)	N/A	N/A	N/A	N/A	11,030	11,030
	Gross Combined (GCWR)	N/A	N/A	N/A	N/A	14,530	14,530
MEASUREMENTS	Wheel Base (Ford/Chevy)	138"/139"	181"/182"	181"/182"	213"/214"	170"	170"
	Exterior Length (w/out ladder) (Ford/Chevy)	22'8"/23'7"	27'4"/28'3"	27'4"/28'3"	30'11"/31'10"	24'6"	24'10"
	Exterior Height (w/ AC)	10'7"	10'7"	10'7"	10'7"	10'10"	10'10"
	Exterior Width (without mirrors)	94"	94"	94"	94"	90"	90"
	Interior Height	80"	80"	80"	80"	80"	80"
	Awning Size	11'6"	18'	18'	20'	14'6"	14'6"
CAPACITIES	Fuel (gallons) (Ford/Chevy)	40/35	55/57	55/57	55/57	26.4	26.4
	LPG (pounds)	40.9	40.9	40.9	40.9	68.2	68.2
	Fresh Water (gallons)	39	33	33	33	40	42
	Waste Water (gallons)	26	25	25	25	38	34
	Gray Water (gallons)	26	33	32	23	34	38
	Water Heater (gallons)	6	6	6	6	6	6
	Furnace (BTUs)	25,000	25,000	25,000	25,000	25,000	25,000
	Exterior Storage Capacity (cubic feet) (Ford/Chevy)	4/4	16/12	17/17	24/24	56	40

2019 CHATEAU CITATION STANDARD & OPTIONAL FEATURES

BODY CONSTRUCTION/ EXTERIOR		B+	SP	Power driver's seat (Ford chassis only)	O	N/A	Stainless steel power range hood	S	S	Smoke, LPG, carbon monoxide detectors	S	S		
Fully welded tubular steel floor system	S	N/A		Back-up monitor	S	S	Stainless steel convection microwave	S	S	Fire extinguisher	S	S		
				INTERIOR	B+	SP	Non-stainless steel convection oven (Canadian units only)	S	N/A	Slide-out battery tray	S	N/A		
Fully welded tubular aluminum floor system with Tek-Modo floor decking	N/A	S		80" interior ceiling height	S	S	Laminate countertops	S	S	Keyless entry for cab doors	N/A	S		
Curved sidewall design	S	N/A		Electric Euro-skylight	N/A	S	Solid surface countertop with sink covers	O	O	Convenience package: keyless entry and valve stem extenders (N/A on 24SA & 24SB)	O	N/A		
Fully welded tubular aluminum roof and sidewall cage construction	S	S		Residential linoleum (galley, bath and entry way)	S	S	Flip-up countertop extension (not available on 21BC)	S	N/A	ELECTRICAL & PLUMBING			B+	SP
Vacu-Bond laminated roof, walls and floors with high-density block foam insulation	S	S		Metal entry grab handle	S	S	Large stainless steel single bowl sink with goose neck faucet	N/A	S	Onan® RV MicroQuiet™ 4.0 (4000 watts) gas generator	O	N/A		
Slick fiberglass exterior sidewalls	S	S		Windshield privacy curtain	S	S	Large double bowl sink	S	N/A	Onan® 3.6 (3600 watts) LP generator	N/A	S		
Exterior graphics package	S	S		Cab-over bed ladder	N/A	S	Pantry (24SB & 28BK only)	S	S	Onan® RV QD 3200 (3200 watts) diesel generator	N/A	O		
Exterior graphics/partial paint packages	O	O		13,500 BTU low-profile A/C in front	S	S	Full extension drawer guides	S	S					
Full-body paint package with Gel-coat sidewalls	O	O		15,000 BTU low-profile A/C in front	O	N/A	ENTERTAINMENT & ACCESSORIES		B+	SP	Power Package: includes Automatic shoreline-to-generator transfer switch, Second auxiliary house battery, 6-gallon gas/electric water heater & Automatic electric entrance step		O	N/A
Premium one-piece TPO roof— Energy Star approved	S	S		Ceiling ducted A/C system	S	S	Front entertainment center with 32" LCD TV in cab-over	S	N/A	30-amp service with shore line power cord	S	S		
Crown roof	S	S		Fluorescent ceiling lighting	S	S	19" LCD TV over the door and coach stereo system with AM/FM tuner and DVD player (24SA and 24SB only)	N/A	S	Automatic shoreline-to-generator transfer switch	PP	S		
One-piece fiberglass front and rear caps	S	S		Directional reading lights	S	S	Front entertainment center with 26" LCD TV in cab-over (24SA and 24SB only)	N/A	O	Battery disconnect switch	S	S		
Manual patio awning	S	S		Cinnamon maple cabinetry	S	S	Portable 19" LCD TV in bedroom - can be removed and mounted to exterior hook-ups (N/A on 21BC & 24SB)	O	O	Emergency start switch	S	N/A		
Roof ladder	S	S		Cherry cabinetry	O	O	Home theater system with DVD player and radio tuner	O	N/A	Auxiliary house battery	PP	S		
Seamless roto-cast storage compartments	S	S		European style curved cabinetry with hidden hinges	S	S	Outside entertainment center includes 26" LCD TV with AM/ FM stereo, CD/DVD player with iPod ready jack and speakers (N/A on 21BC and 24SA)	O	O	Second auxiliary house battery	O	O		
Flush mount radius luggage doors	S	N/A		Hardware with brushed nickel finish	S	S	TV antenna and booster	S	S	6-gallon gas water heater	S	N/A		
Side hinged slab luggage doors	N/A	S		Day/Night shades throughout	S	S	Cable TV prep	S	S	6-gallon gas/electric water heater	PP	S		
Slide-out room awning	S	S		Soft touch vinyl ceiling	S	S	HD/DSS satellite prep	S	S	Black tank flush system	S	N/A		
Automatic electric entrance step	PP	S		Booth dinette (N/A on 28BK)	S	S	BEDROOM/BATHROOM		B+	SP	Water heater bypass system	S	S	
Clear acrylic, entry grab handle	S	S		Leatherette Euro-recliner with ottoman (Std. on 28BK)	O	N/A	Queen-size innerspring mattress (N/A on 21BC & 24SB)	S	S	Holding tanks with heat pads	O	O		
Outside Shower	O	S		Fabric jackknife sofa (21BC only)	S	N/A	Bedspread and pillow shams (N/A on 21BC and 24SB)	S	S	K E Y :				
AUTOMOTIVE/COCKPIT		B+	SP	Infiniss™ Leather U-shape dinette IPO booth dinette (24SA only)	N/A	O				*PP = Power Package Option				
AM/FM dash radio with large buttons, CD player and weather band tuner; iPod and Sirius® satellite ready	S	S		Fabric/Infiniss™ Leather U-shape dinette IPO booth dinette (24SA only)	N/A	O	BEDROOM/BATHROOM		B+	SP	B+ = 21BC, 26BE, 28BK & 29BG			
Power window and door locks	S	S		Infiniss™ leather hide-a- bed sofa with air mattress (Std. on 24SB & 29BG)	S	S	Power bath vent	S	S	SP = 24SA & 24SB				
3-Point driver and passenger seat belts	S	S		Infiniss™ leather hide-a-bed sofa with air mattress and pedestal table IPO booth dinette (24SA only)	N/A	O	China bowl toilet	S	S					
Driver and passenger air bags	S	S		Fantastic fan	O	O	Skylight in shower	S	S					
Upgrade dash insert with drink tray	S	N/A		GALLEY		B+	SP	Shower with glass door	S	S				
Fiberglass running boards	S	S		Double door refrigerator with stainless steel door inserts	S	S	SAFETY/CONVENIENCE		B+	SP				
Stainless steel wheel liners	S	S		3-burner high-output cooktop with cover	S	N/A	Entry door with deadbolt lock	S	S					
Heated, remote exterior mirrors	S	S		European 2-burner high-output gas range top with glass cover	N/A	S	Telephone jack	S	S					
Spare tire kit	O	S					System control center	S	S					
3,500-lb. trailer hitch	N/A	S												
5,000-lb. trailer hitch	S	N/A												
Infiniss leather driver and passenger captain's chairs	S	S												



VEHICLE LOADING: Every effort has been made to provide the greatest number of options for the recreation vehicle owner. Along with these choices comes the responsibility to manage the loads that are imposed by the choices so that they remain within the manufacturer's specified chassis weight limits. Do not overload the recreation vehicle.

IMPORTANT: Towing capacity may vary by chassis model, floorplan, options and loading of the vehicle. This may result in a towing capacity which is less than the maximum capacity of the hitch. Do not exceed the vehicle's Gross

Combined Weight Rating (GCWR), or the hitch rating. A separate functioning brake system is required for any towed vehicle or trailer weighing more than 1,000 lbs. (450 KG) when fully loaded. Liquid capacities and weights are approximations only.

WARNING: This information is intended as a guide only. Weights of individual vehicles may vary. Consult your owner's manual and weight sticker affixed to each vehicle for complete loading, weighing, and towing instructions.

WARRANTY: This vehicle is provided with a one-year, 15,000-mile limited warranty and a three-year, 45,000-mile limited structural warranty. Chassis, component part and appliance manufacturers issue limited warranties covering those portions of the vehicle not covered by the limited warranties issued by Four Winds International. To learn what portions of the vehicle are excluded from coverage under the limited warranties issued by Four Winds International, please contact your selling dealership or Four Winds International directly, or review the warranty packet inside the vehicle.

Product information, specifications, and photography in this brochure were as accurate as possible at time of printing. Photographs may contain some features that are optional on your vehicle. Since we continually strive to improve our products, actual products may differ. The manufacturer reserves the right, at any time, to make changes in product design, materials, component specifications and pricing, without notice. All capacities are approximate and dimensions are nominal. Some features or options may be different or unavailable in Canada.

FW Four Winds
INTERNATIONAL



© 2009 Four Winds International
Litho USA 1109 - 10M