

MOUNTAIN AIRE

NEWMAR

2012 | MOUNTAIN AIRE
A LEGEND, REDEFINED.



A WINNING LOOK.

Mountain Aire's new exterior graphics and paint schemes will get you noticed on the road. Its signature Newmar Full-Paint Masterpiece™ Finish and Super Clear Coat make the impression a lasting one.

2012 MOUNTAIN AIRE LUXURY MOTOR COACH

DID WE MAGICALLY EXPAND ITS INTERIOR? OR IS IT YOUR IMAGINATION?

The 2012 Mountain Aire coach seems to open up before you seamlessly. Its unique new floor plan, with entry side dinette and facing streamlined Eurostyle lounges, creates the perfect space for entertaining or relaxing. The kitchen, with its large picture window, pushes back toward the rear of the main coach to give the chef some breathing room. Flush floor slides create a smooth, seamless look. And its Cummins® 450 HP diesel power opens up the road, too.



**FOR A PARTY OF TWO
OR A REUNION, YOUR
DELUXE COACH AWAITS.**

Mountain Aire's newly designed polished tile floor creates the impression of an area rug. Yet its flush floor slides create a smooth look that makes the main coach seem larger. Paneled hardwood fascia with built-in lighting add a soft mood to the space. And each roomy hardwood cabinet is handcrafted by Amish artisans who meet Newmar's exquisite fit and finish standards.

COMFORT
The new Mountain Aire interior gives you bountiful comforts and a wide range of rich decor schemes. Including even more plush UltraLux leather furniture with designer cording trim and stainless appliances like the microwave convection oven and optional residential refrigerator.

EYE-CATCHING DESIGN
Mountain Aire's main coach area features an 'area rug' design in tile, flush floor slides and comfy furniture. Polished Corian® countertops with a checkerboard tile backsplash create a dramatic effect in the kitchen. A 40" Sony® LCD TV with Surround Sound Dolby Digital and DVD player tucks neatly in the front overhead area.

THE KITCHEN THAT IS ALSO A ROOM WITH A VIEW.

Some kitchens are strictly utilitarian; others are inspiring. Mountain Aire's is both. Fine handmade hardwood cabinets surround its L-shaped design, complete with a designer backsplash and polished Corian® countertops. The chef will be smiling.



TOP

Metallic flower and leaf backsplash tile accents bring a touch of nature to Mountain Aire's kitchen.

RIGHT

A streamlined Flexsteel™ dinette lets you enjoy breakfast, lunch or dinner in comfort. Or just relax and watch the sun set through the spacious kitchen and dinette windows.





SLEEP NUMBER BED*



QUILTED LEATHER AND HARDWOOD SCROLLED HEADBOARD

BEDROOM

The Mountain Aire bedroom shines. Literally. With two softly lit hardwood panels on each side of its king size Sleep Number® Bed*. Its quilted leather and hardwood scrolled headboard will encompass you. Its 40" Sony flatscreen TV with Bose Wave® surround sound and Blu Ray will absorb you completely.

BATHROOM

The designer checkerboard tile pattern over a Corian® countertop surrounded sink creates a focal point in this well appointed Mountain Aire bathroom. And the radius shower with optional teak shower seat afford you some well deserved pampering.

*optional



BATHROOM

YOUR NEW COACH AWAITS.

Mountain Aire for 2012. Its sleek new exterior graphics come in an array of paint color schemes that coordinate perfectly with its tasteful interior decor. To add to your comfort, Polar Pak R-19 roof insulation is now a standard feature.



NEW FRONT GRILL



NEW HEADLIGHT ASSEMBLY



COMFORT DRIVE™ EQUIPPED



ULTRALUX LEATHER CHAIR

TAKE CONTROL

Mountain Aire's Comfort Drive™ Steering with adjustable control and optional TripTek™ electronic travel information gives you the easiest possible driving experience.

SINK IN

An even more comfortable, cushy captain's chair in UltraLux leather awaits your next journey, including corded designer trim.



FREIGHTLINER

DRIVE WITH A LIGHT TOUCH. THE ROAD IS YOURS.

Comfort Drive™, another exclusive Newmar innovation, means less effort turning the wheel when you back up or turn. The steering wheel returns to center automatically, even after hard turns. And with Comfort Drive™, you steer with a light grip, making long trips less tiring.

Mountain Aire's 43' Freightliner chassis comes prewired for an optional Eaton Vorad Smart Cruise System. When approaching slower moving traffic with the system active, it adapts your coach's cruise speed to that of the closest vehicle ahead, allowing your coach to maintain a specific following distance while in cruise control. Together, these systems offer you the ultimate in driver safety and confidence.



Comfort Drive
by Newmar

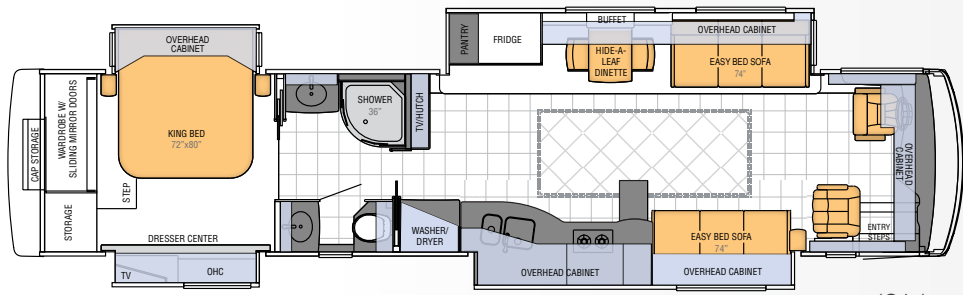

4314

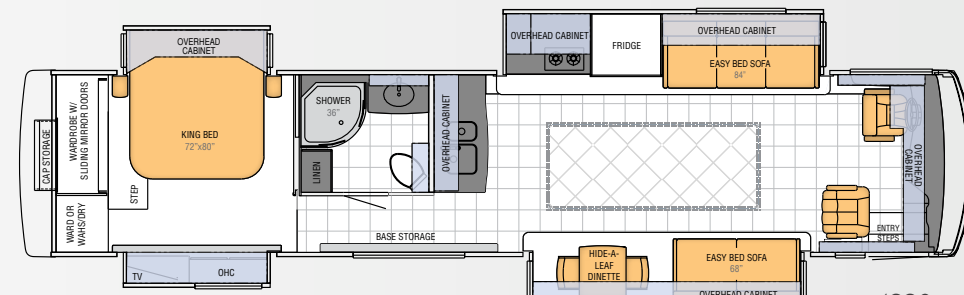

4330

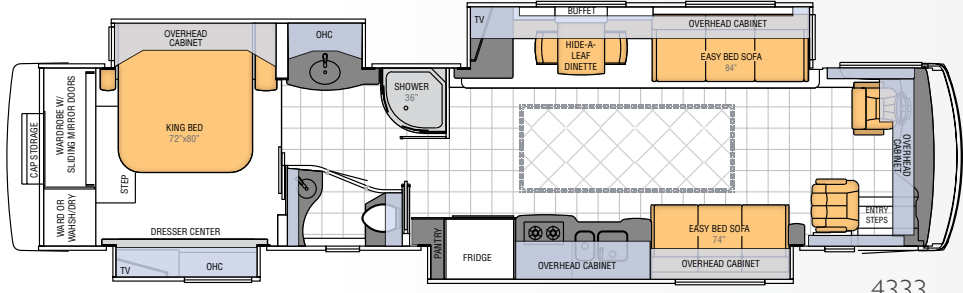

4333

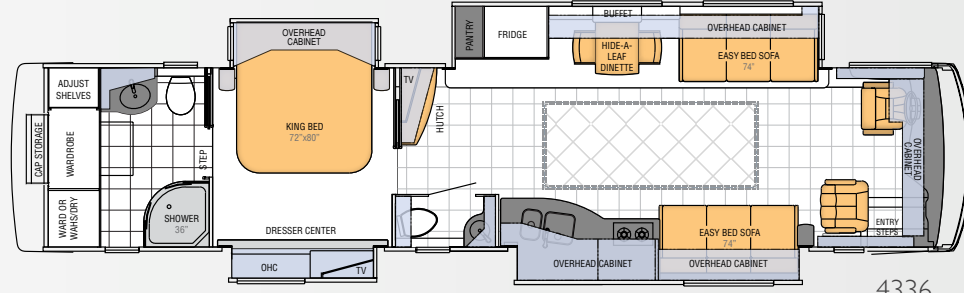

4336

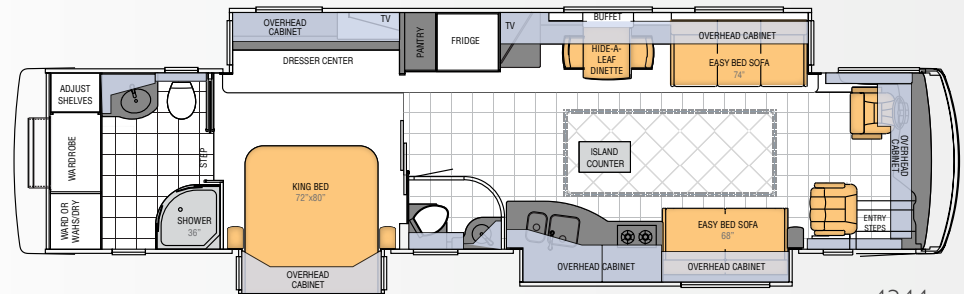

4344

FLOOR PLAN SPECIFICATIONS

Floor Plan	App. Overall Length	Width	App. Overall Height	Interior Width	Interior Height	Grey	Sewage	Water	Propane	Furnace
4314	42' 9"	101.5"	12' 9"	95.5"	84"	65 gal.	45 gal.	105 gal.	32 gal.	50,000 btu
4330	42' 9"	101.5"	12' 9"	95.5"	84"	65 gal.	45 gal.	105 gal.	32 gal.	50,000 btu
4333	42' 9"	101.5"	12' 9"	95.5"	84"	65 gal.	45 gal.	105 gal.	32 gal.	50,000 btu
4336	42' 9"	101.5"	12' 9"	95.5"	84"	65 gal.	45 gal.	105 gal.	32 gal.	50,000 btu
4344	42' 9"	101.5"	12' 9"	95.5"	84"	65 gal.	45 gal.	105 gal.	32 gal.	50,000 btu



Woodcrest



Bayside



Sahara



Sangria



Mondavi Maple Hardwood



Manhattan Glazed Maple Hardwood



Carmel Glazed Cherry Hardwood



Wicker Glazed Maple Hardwood



CHASSIS SPECIFICATIONS

Floor Plan	Engine HP	Axle Ratio	Fuel Cap.	Wheel-base	Front GAWR*	Rear GAWR*	Tag GAWR*	GVWR*	GCWR*	App. UVW	App. NCC
4314	450	4.63	150 gal.	296+TAG	17,000 lb.	20,000 lb.	10,000 lb.	47,000 lb.	62,000 lb.	35,550 lb.	11,450 lb.
4330	450	4.63	150 gal.	296+TAG	17,000 lb.	20,000 lb.	10,000 lb.	47,000 lb.	62,000 lb.	35,550 lb.	11,500 lb.
4333	450	4.63	150 gal.	296+TAG	17,000 lb.	20,000 lb.	10,000 lb.	47,000 lb.	62,000 lb.	35,600 lb.	11,400 lb.
4336	450	4.63	150 gal.	296+TAG	17,000 lb.	20,000 lb.	10,000 lb.	47,000 lb.	62,000 lb.	35,650 lb.	11,350 lb.
4344	450	4.63	150 gal.	296+TAG	17,000 lb.	20,000 lb.	10,000 lb.	47,000 lb.	62,000 lb.	36,150 lb.	10,850 lb.

Lengths, heights, widths and dry weights are approximate. Weight will vary based on optional equipment added to the above base weight.

GAWR: Gross Axle Weight Rating is the maximum permissible weight for an axle.

GVWR: Gross Vehicle Weight Rating is the maximum permissible weight for a fully loaded motor coach.

GCWR: Gross Combination Weight Rating is the value specified by the manufacturer of the vehicle as the maximum allowable loaded weight of this motor coach and any towed trailer or towed vehicle.

UVW: Unloaded Vehicle Weight is the weight of this motorcoach as built at the factory with full fuel, engine oil and coolants. The UVW does not include cargo, fresh water, propane gas or dealer-installed accessories.

NCC: Net Carrying Capacity is the maximum weight of all occupants, including the driver, personal belongings, food, fresh water, waste water, propane gas, tools, tongue weight of towed vehicle, dealer-installed accessories, etc., that can be carried by the motorcoach.

*Specifications supplied by the chassis manufacturer.

ROOF R-VALUE = 19

- a. Fiberglass Roof
- b. Fiberglass Batten Insulation
- c. A/C Ducting
- d. Aluminum Rafter Framing
- e. Kraft Paper Vapor Barrier
- f. 5/8" Bead Foam
- g. 3/16" Panel
- h. Padded Vinyl Overlay

FLOOR R-VALUE = 16

- o. Carpet/Tile
- p. Carpet Padding
- q. 5/8" Floor Decking
- r. Fiberglass Batten Insulation
- s. 2"x 3" Wood Framing
- t. Polyethylene Moisture Barrier

SIDEWALL R-VALUE = 11

- i. 3/16" Plywood Interior Wall
- j. 5/8" Bead Foam
- k. Kraft Paper Vapor Barrier
- l. Fiberglass Batten Insulation
- m. Composite One-Piece Gelcoat Exterior Sidewall
- n. Aluminum Framing with 3 1/2" Header Above

BASEMENT R-VALUE = 4

- u. Cargo Liner
- v. 3/8" Floor Decking
- w. 3/16" Luan Panel
- x. 1 1/2" Bead Foam
- y. Aluminum Sheeting with Steel Support Rails to Prevent Bowing and Flexing

1. 15M Penguin™ Heat Pump Central Air Conditioners
2. One-Piece Bonded Windshield
3. Coated Aluminum Wheels
4. Frameless, Double-Pane, Tinted Safety-Glass Windows
5. Side-Hinged Baggage Doors with Optional Storage Tray

INCOMPARABLE MOUNTAIN AIRE CONSTRUCTION

The Freightliner® XCR's strong chassis with 50,000 PSI frame rail provides Mountain Aire with a solid, confident foundation. This – and Mountain Aire's GVWR of 47,000 pounds, with a 10,000 pound tag axle, allows Mountain Aire to expand beyond its chassis footprint, creating extra living space. Its Cummins® ISL 450 HP engine gives you incredible maneuverability and power, even on steep inclines. And if you should ever need it, Newmar's roadside assistance program is in place for the entire warranty period.

CHASSIS FEATURES

- Freightliner® Chassis with 450hp Cummins ISL
- Two-Stage Engine Compression Brake
- Adjustable Pedals
- Tag Axle
- Accuride® ACCU-SHIELD™ Aluminum Wheels
- Anti-Lock Braking System
- Cruise Control
- Electronic Chassis Information in Display in Dash
- Anti-Lock Braking System
- Hydraulic Leveling Jacks with Single Touch Control
- Comfort Drive™ Steering With Adjustable Control
- Recessed Fuel Fills with Crossover to Fill from Either Side

AIR CONDITIONING & HEATING

- Two 15M Penguin™ Heat Pump Central Air Conditioners
- Hydronic Zone Heating System
- Propane Gas Leak Detector
- Roof Air Conditioning Condensation Drainage System

APPLIANCES & ACCESSORIES

- Polished Corian® Range Cover
- Norcold® 12 Cu. Ft. Refrigerator with Icemaker and Water Dispenser
- One-Piece Washer/Dryer Prep*
- Sony® LCD TV and DVD Player in Living and Bedroom Areas*
- AM/FM Dash Radio with CD Player and Auxiliary Jack for MP3 Player
- Rearview Color Monitor System
- Microwave 30" Convection with Two Burner Recessed Gas Cooktop
- Sony® Surround Sound System
- Roof Mounted Digital TV Antenna with Power Booster
- High Definition Component Wiring
- Air Horns

CABINETS & FURNITURE

- Mondavi Maple Hardwood Cabinets with Concealed Hinges and Full Overlay Double Cathedral Cabinet Doors

- Pullout Pantry Shelves*
- Residential Style Full Extension Ball Bearing Drawer Guides
- Hidden-Leaf Dinette Table with Four Chairs (Two Fixed, Two Folding)
- Polished Corian® Countertop in Kitchen, Bath, and Bedroom Areas
- Pullout Mobile Island Kitchen Base Cabinet with Polished Corian® Countertop*
- Flexsteel® Furniture
- Ultralux Leather Driver/Passenger Seats with Six-Way Power and Lumbar Support with Footrest on Oversized Passenger Seat
- Cedar Paneling in Bedroom Wardrobe
- King-Sized Bed with Radius Cornered Mattress with Quilted Bedsprad and Accent Pillows

ELECTRICAL FEATURES

- 8.0 kW Cummins Onan® Quiet Series Diesel Generator on Slideout Tray
- 50 Amp Electrical Service with Flexible Cord
- Energy Management System
- NewPlex™ Wiring System
- 2800 Watt Inverter
- Midship Side Turn Signals
- Recessed Docking Lights
- Halogen Lights Recessed in Ceiling and Overhead Cabinets
- Lighted Wardrobe
- ICC Light Flasher Switch
- Battery Disconnect Switch
- Mood Lighting Recessed in Window Treatments, Kitchen Toe Kick, Bed Base, and Fascia.
- Solar Prep
- Power Cord Rewind Reel
- Pre-Wire for Freezer

EXTERIOR FEATURES

- Full-Paint Masterpiece™ Finish With Super Clear Coat and DigiShield™ Front Protective Film
- Chrome Convex Exterior Mirrors with Remote Control, Defrost, Turn Signal Indicators, and Sideview Cameras
- Power Flush Stepwell Cover
- Power Locking Baggage Doors

- Keyless Entry with Door Bell and Touch Pad
- 15,000 lb. Towing Hitch with Two Extra 14 Gauge Wires*
- Lighted Acrylic Assist Handle at Entrance Door
- Rear Protective Tow Guard with Stainless Steel Newmar Name Cutout
- Exterior Storage Compartments Finished with Cargo Liner
- Mud Flaps
- Chrome Trim Package

INTERIOR FEATURES

- Power-Activated Sun Visors
- Hardwood Fascia on Living Area Slideouts and Window Sills
- Polished Porcelain Floor Tile in Kitchen, Bathroom, and Living Areas
- Polished Corian® Backsplash with Tile Accents in Kitchen and Bath
- Carpeting with High-Density Padding in Living and Bedroom Areas
- Hardwood Raised-Panel Interior Passage Doors
- Lined Day/Night Pleated Window Shades and Lambrequins
- Padded Vinyl Ceiling with Feature Panels

PLUMBING & BATH FEATURES

- Fiberglass Shower with Glass Door
- Water Filter for Entire Unit
- Monoplex Water Pump Switches Located in Bathroom, Kitchen and Exterior Near Gate Valves
- Thetford™ Aria Sculptures China Stool
- (Thetford Vacuum flush Stool in Rear Bath)

CONSTRUCTION FEATURES

- Power Lock Arms on All Slideout Rooms

WINDOWS, AWNINGS, & VENTS

- Frameless Double-Pane Tinted Safety-Glass Windows
- Fan-Tastic® Vent with Rain Sensor in Kitchen Area and Bathroom
- Girard® Power Awning on Windows, Entrance Door, and Slideout Covers
- Girard® Power Side Awning with Wind Sensor and Remote Control Recessed into Sidewall

OPTIONS

CHASSIS FEATURES

- TripTek™ Electronic Travel Information (Displayed on Rearview Monitor)

AIR CONDITIONING & HEATING

- Extra 15M Penguin™ Heat Pump Central Air Conditioner with 10.0 kW Onan® Generator*
- Electric Heat under Floor Tile in Kitchen, Bath, and Living Areas
- Hydronic Zone Diesel Heating System

APPLIANCES & ACCESSORIES

- Chest Freezer on Pullout Tray
- Whirlpool® Front Load Two-Piece Washer/Dryer
- Residential Refrigerator with Icemaker and Water Dispenser
- Fisher Paykel Dishdrawer®
- Sony® 40" LCD TV in Front Overhead Cabinet*

- Sirius Satellite Radio Capability (Does not include monthly subscription)
- Dash Radio with Portable TomTom® Navigation System
- Universal Remote Control
- Exterior Entertainment Center Located in Sidewall with Sony® 40" LCD TV and Sony® AM/FM Radio and CD Player

- Exterior Entertainment Center Located in Storage Compartment with 32" Sony® LCD TV and Sony® AM/FM Radio and CD Player*
- Satellite Dish with High Definition Converter
- Central Vacuum with Deluxe Tool Kit
- CB Radio with Antenna

CABINETS & FURNITURE

- Carmel Glazed Cherry Hardwood Cabinets
- Manhattan Glazed Maple Hardwood Cabinets

- Wicker Glazed Maple Hardwood Cabinets
- Ultralux Leather Sofa/Dinette Ensemble*
- Ultralux Leather Euro Dinette *
- Ultralux Leather Recliners with Lamp Stand*
- Hide-A-Bed Sofa with Air Mattress*
- Combination Desk/Dinette Table with Two Fixed and Two Folding Chairs
- Sleep Number® Air Mattress for Main Bed
- Heated Driver/Passenger Seats

EXTERIOR FEATURES

- Large Storage Tray with Access from One Side or Either Side*
- Large Storage Tray*
- Small Storage Tray*
- Power Sliding Storage Tray*

INTERIOR FEATURES

- Polished Porcelain Floor Tile Extended Into Bedroom Area
- Power Duo Day/Night Window Shades (Windshield and Driver/ Passenger Side Windows)
- Power Silhouette Window Shades
- Safe

PLUMBING & BATH FEATURES

- Corian® Shower Walls with tile inserts
- Fold-Down Shower Seat
- Assist Handle in Tub/Shower
- Bathtub*

WINDOWS, AWNINGS, & VENTS

- Additional Girard® Power Side Awning with Wind Sensor and Remote Control
- Driver's-Side Power Window

*Check with dealership on floor plan availability and complete listing of features.



Mahlon Miller, Newmar founder, and his wife, Irene
Matthew Miller, Newmar president, and his wife, Pam

The quiet, energetic farm town of Nappanee, Indiana is home to Newmar's owners, the Miller family. They are actively engaged in its operations, embracing employees, suppliers, dealers and customers as part of the Newmar family. The family has grown since 1968 but continues to strive for faithfulness to the tenets of its founders, including a strong community, bearing burdens for others, forgiveness, fairness, honesty, integrity, and peace with one's neighbors.



WHEN YOU KNOW THE DIFFERENCE™

NEWMAR CORPORATION
355 N DELAWARE ST
PO BOX 30
NAPPANEE IN 46550-0030
574-773-7791 Fax 574-773-2895

www.newmarcorp.com

THE NEWMAR KOUNTRY KLUB is an exclusive club for owners of fine Newmar products that offers many advantages and benefits to its members. Learn more at: www.newmarkountryklub.com.

ESTABLISHED OVER 40 YEARS AGO, Newmar is an innovator and leader in the RV manufacturing industry. Its quality craftsmanship is recognized nationally. The Newmar dealer network spans across the United States and Canada.

Call 1-800-860-0086 to be our guest for a factory tour.

(Please affix dealer stamp in this area.)

NEWMAR EXPRESS LIMITED WARRANTY

Every Mountain Aire Diesel Pusher is backed by Newmar's one-year limited warranty/unlimited miles. Ask your Newmar dealer for details.

LIMITED FIVE-YEAR STRUCTURAL WARRANTY

If any part of your Newmar recreational vehicle superstructure (which is the steel/aluminum structure of the sidewall, roof or frame) fails to perform properly within five years from the date of purchase because of faulty workmanship or material supplied by Newmar, it will be repaired without charge for either parts or labor by Newmar. This structural warranty is available only to the original purchaser and is non-transferable.

Some features in our literature are optional. Colors and finishes are photographic representations. The actual materials may look different. Prices, specifications and floorplans are subject to change at Newmar's discretion, without prior notice or obligation. Please see your dealer for actual samples and specifications.