

2013 Autumn Ridge®

TRAVEL TRAILERS BY STARCRAFT®

# Autumn Ridge



STARCRRAFT



- ✓ HARDWOOD SCREWED-STILE CONSTRUCTION
- ✓ 38" DEEP DINETTE DRAWERS
- ✓ OUTSIDE TV PREP UNDER PATIO AWNING
- ✓ PORCELAIN TOILET
- ✓ 6 GAL. GAS/ELECTRIC DSI WATER HEATER
- ✓ AMISH CRAFTSMANSHIP

2013

# AUTUMN RIDGE



- ✓ INTERIOR COMMAND CENTER
- ✓ GALVANIZED-STEEL WHEEL WELLS
- ✓ 68-GAL. FRESH WATER CAPACITY
- ✓ 30" x 72" MAIN ENTRY DOOR





Autumn Ridge 289BHS | Safari



#### DOUBLE-DOUBLE BUNKS

Autumn Ridge's unique family friendly double double bunks, with a 600 lb. rating, offer a family friendly space for relaxation (select models).



#### OUTDOOR KITCHEN

Be part of the action with our outdoor kitchen (select models) featuring a sink, Coleman grill, refrigerator and storage.



#### STARMAXX PASS-THRU STORAGE

Starmaxx pass thru, lighted storage, complete with tool hooks, allows convenient access to your gear from both sides of your unit.

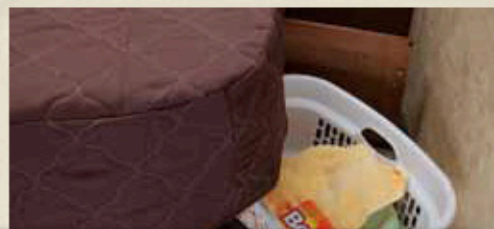

#### PULL-OUT LAUNDRY BASKET

Innovative storage solutions, like a pull out laundry basket, save space while providing more storage.



#### INTEGRATED SPICE RACK

A spice rack, integrated into the kitchen valance, creates space saving convenience.

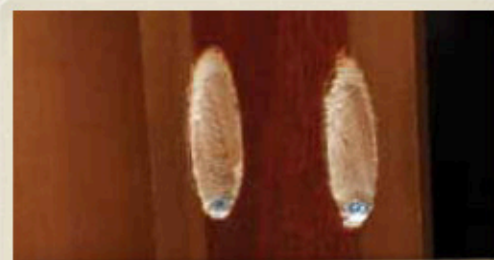

#### DURABLE CONSTRUCTION

Our cabinets are hand made with hardwood stiles and screwed construction for increased durability and longer cabinet life.

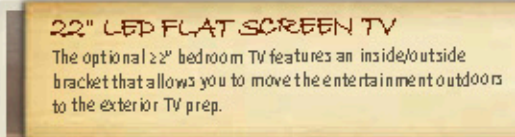

#### 22" LED FLAT SCREEN TV

The optional 22" bedroom TV features an inside/outside bracket that allows you to move the entertainment outdoors to the exterior TV prep.

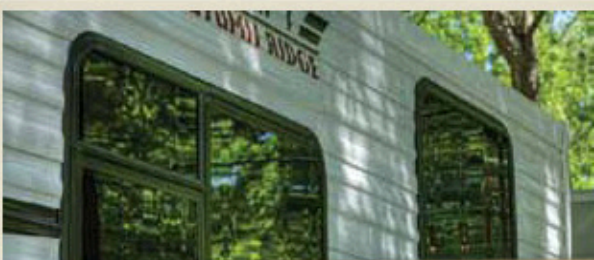

#### DARK-TINTED WINDOWS

Enjoy your privacy with dark tinted, safety glass windows (standard), while thermal pane windows (optional) help efficiently maintain inside temperatures.

Autumn Ridge 289BHS | Safari

AUTUMN RIDGE

# TRAVEL TRAILER



- ✓ DUCTED, DIRECTIONAL HEAT AND A/C
- ✓ STARMAXX PASS-THRU COMPARTMENT
- ✓ BLACK TANK FLUSH
- ✓ STRUCTURAL-STEEL I-BEAM FRAME
- ✓ UPGRADED EVERGREEN MATTRESS



Autumn Ridge 329BHU | Sandstone



**FREE-STANDING TABLE**  
Expand your table space with the free standing table's extension leaf.



Autumn Ridge 289BHS | Safari

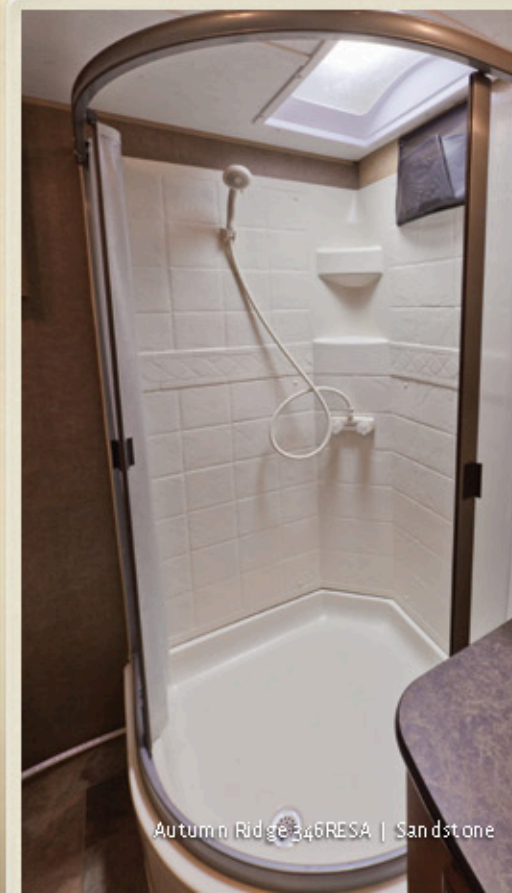

Autumn Ridge 346RESA | Sandstone

# FLOORPLANS

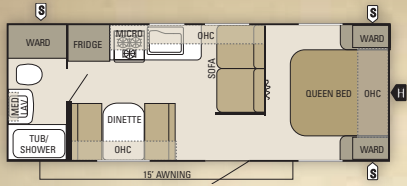

Autumn Ridge 235FB

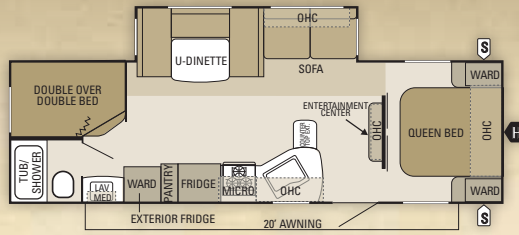

Autumn Ridge 289BHS **OPTION: B**

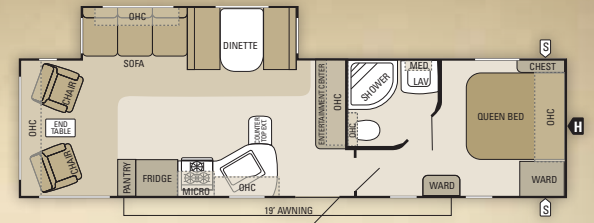

Autumn Ridge 315RLSA **OPTION: A, B, E**

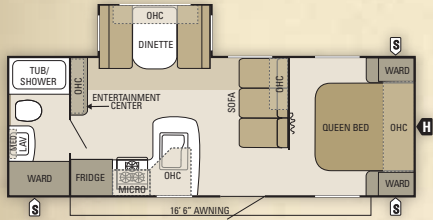

Autumn Ridge 245DS **OPTION: A**

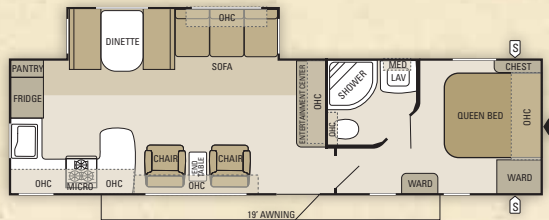

Autumn Ridge 305RKS **OPTION: A, B, E**

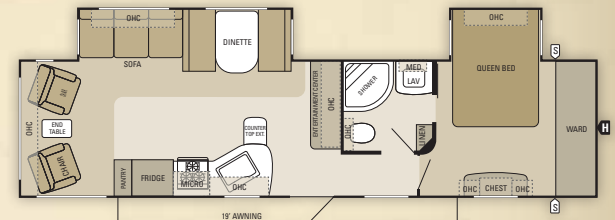

Autumn Ridge 325RLSA **OPTION: A, B, E**

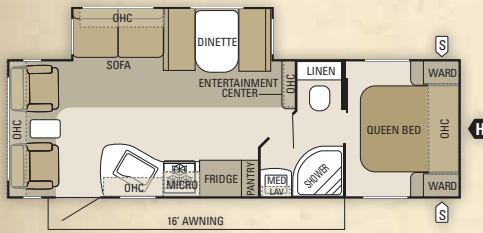

Autumn Ridge 265RLS **OPTION: A, B**

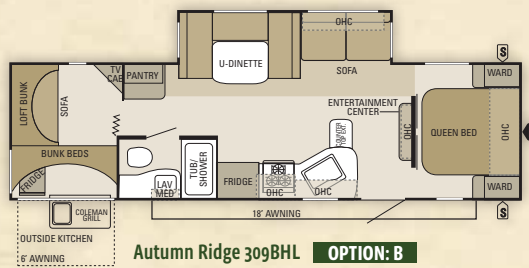

Autumn Ridge 309BHL **OPTION: B**

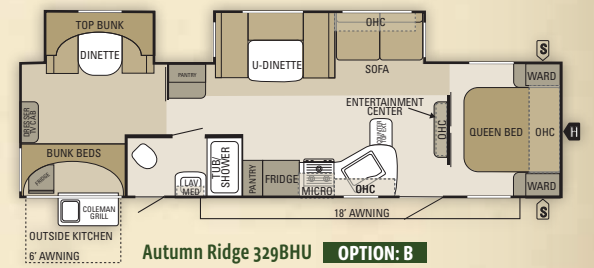

Autumn Ridge 329BHU **OPTION: B**



Autumn Ridge 266RKS **OPTION: A, B**

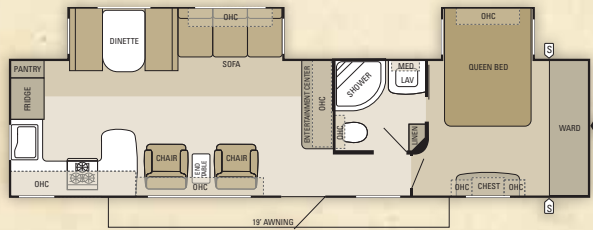

Autumn Ridge 315RKS **OPTION: A, B, E**

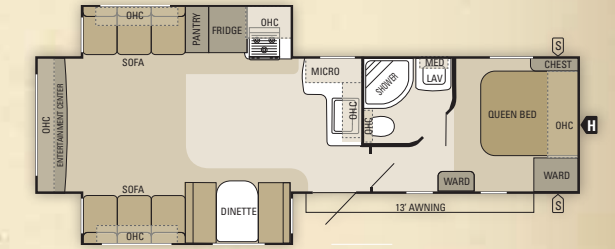

Autumn Ridge 336RESA **OPTION: A, B, C, D**

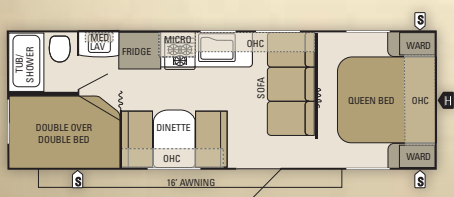

Autumn Ridge 278BH

- S OUTSIDE STORAGE
- H TRAILER HITCH
- LAV BATHROOM SINK
- MICRO MICROWAVE
- OHC OVERHEAD CABINETS
- FRIDGE REFRIGERATOR
- WARD WARDROBE

- OPTION A**  
  
FREE-STANDING TABLE WITH EXTENDABLE LEAF OPTION
- OPTION B**  
  
HIDE-A-BED OPTION
- OPTION C**  
  
CHAIR OPTION
- OPTION D**  
  
LEDGESTONE FIREPLACE OPTION
- OPTION E**  
  
STONE LEDGE FIREPLACE OPTION

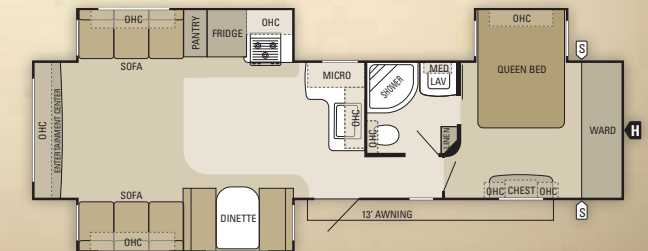

Autumn Ridge 346RESA **OPTION: A, B, C, D**

# CUSTOMER CONVENIENCE PACKAGE

The amenities you want at a price you can afford.

- ✓ Outside shower
- ✓ 6 gal. gas/electric DSI water heater
- ✓ 13,500 or 15,000-BTU A/C with wall thermostat
- ✓ Microwave
- ✓ Water heater bypass
- ✓ Bathroom skylight
- ✓ 30-lb. propane bottles (2)
- ✓ Front diamond plate
- ✓ Outside speakers (2)
- ✓ Power vent in bathroom
- ✓ Tub surround



**DOUBLE 30-LB. PROPANE**  
Camp in comfort thanks to two 30-lb. propane bottles with custom molded ABS cover and auto changeover.



**BATHROOM SKYLIGHT**  
A bathroom skylight brightens Autumn Ridge's full-featured bathroom with natural light.



**OUTDOOR SPEAKERS**  
Take your music outdoors with two exterior marine-grade speakers.

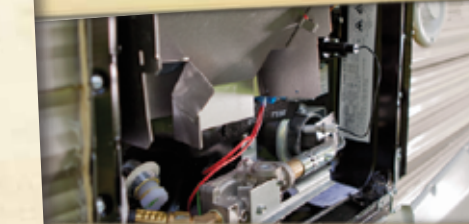

**6-GAL WATER HEATER**  
There's plenty of hot water to go around thanks to a 6-gal. gas/electric DSI water heater and quick recover system.

## STANDARDS AND OPTIONS

### STANDARD CONSTRUCTION EQUIPMENT

- 3/8" decking on roof
- 5/8" tongue-and-groove plywood main floor decking
- 2" x 3" longitudinal floor joists on 16"-18" centers
- 8' living room ceiling height
- Hardwood cabinetry stile with screwed construction
- I-Class cambered structural-steel I-beam frame
- In-floor ducted heat
- One-piece seamless rubber roof material
- Roof rafters constructed of residential-style tapered 4-1/2" trusses

### STANDARD EXTERIOR EQUIPMENT

- 15" radial tires
- 30" x 72" radius-cornered main entry door with screen door
- 120V G.F.C.I. protected exterior receptacle
- Black tank flush
- Bumper with drain hose carrier and end caps
- Cable and satellite TV prep
- Crank-up HDTV antenna with signal booster
- E-Z Lube axles
- Galvanized steel wheel wells (insulated on non-slide models)
- Nev-R-Adjust electric brakes
- Outside kitchen with Coleman grill, refrigerator and sink (309BHL and 329BHU)
- Outside TV prep
- Patio awning
- Prep for outside grill
- Propane bottle cover made of molded ABS
- Roof-mounted antenna for radio
- Security lights (2)
- Spare tire with carrier
- Stabilizer jacks (4)
- Starmaxx pass-through storage with tool hooks and courtesy light
- Step light at entry door
- Tinted safety-glass windows

### STANDARD INTERIOR EQUIPMENT

- A/C Chillgrille
- Auto-ignition furnace with wall thermostat
- Ball bearing drawer guides, 50-lb. capacity with full-drawer extension
- Bourbon Glaze beech wood doors and drawers throughout
- Decorative lighting package
- Double-over-double bunk bed with 600-lb. bunk capacities (278BH and 289BHS)
- Command center with centrally located switches
- Evergreen mattress with upgraded radius corners
- Hinged storage lids in bedroom
- Marine-grade table leg and pedestal base
- Multi-Media Sound System AM/FM/CD stereo with MP3 input jack
- Overhead cabinetry in slideout room above sofa
- Pleated shades
- Porcelain toilet with foot flush
- Quilted bunk mats
- Radius shower (select models)

### STANDARD KITCHEN EQUIPMENT

- 3-burner range with 9,000-BTU SuperBurner and piezo igniter
- 6 cu. ft. flush-mount refrigerator
- 8 cu. ft. flush-mount refrigerator (bedslide models)
- Deep storage drawers under booth dinette seat (2)

- Double drawer with integrated silverware dividers
- Extra large picture window at dinette
- Kitchen backsplash
- Oversized 21" oven
- Range hood with light and exhaust fan
- Residential faucet with pull-out sprayer
- Sink covers with integrated drying rack
- Spice rack storage integrated into valance
- Storable cutting board

### CUSTOMER CONVENIENCE PACKAGE

- 6-gal. gas/electric DSI auto-ignition water heater
- 30-lb. propane bottles with auto changeover (2)
- 13,500 or 15,000-BTU A/C with wall thermostat and louvered directional ceiling vents
- ABS tub surround
- Bathroom power vent
- Exterior speakers, high-output marine-grade (2)
- Front diamond plate
- Microwave oven with carousel
- Outside shower
- Tub/shower skylight
- Water heater bypass system

### OPTIONS

- 22" LED TV in bedroom with inside/outside bracket
- 50-amp service with 2nd A/C prep (select models)
- Aluminum rims (standard with Premier Package)
- Arctic Package: Insulated, heated and enclosed underbelly; foil insulation in roof
- Arctic Package with full foil wrap
- Electric awning (standard with Power Package)
- Free-standing table with extendable leaf and 4 chairs (select models)
- Hide-a-bed sofa (select models)
- Ledgestone fireplace
- Mini Power Package: Electric awning and electric tongue jack
- Outside Coleman grill with table (n/a 329BHU and 309BHL)
- Power Package: Electric awning, electric tongue jack and front and rear power stabilizer jacks
- Roof ladder
- Second hide-a-bed door side (select models)
- Swivel glider chairs (2) in lieu of door-side sofa (select models)
- Thermal-pane windows

### PREMIER PACKAGE

- 26" (235FB, 245DS, 278BH) or 32" LED TV and CD/DVD player with MP3 input jack
- Aluminum rims
- Large folding grab handle
- Solid-surface kitchen countertops with undermounted sink
- Sink covers
- Raised-panel overhead kitchen cabinetry and hardwood refrigerator door inserts



SCAN for a complete list of standards and options, OR VISIT [starcraftcamping.com](http://starcraftcamping.com)

## DÉCOR



### SANDSTONE

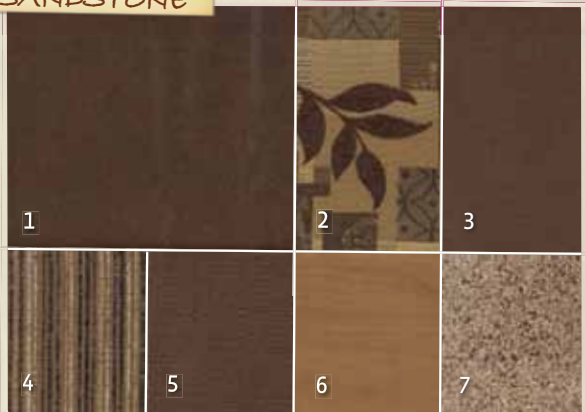

### PRISM

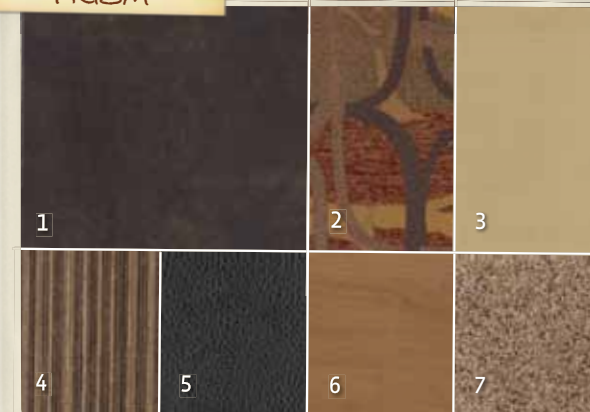

### SAFARI



1 Sofa 2 Accent fabric 3 Bedspread 4 Bedroom accent 5 Drapery 6 Wood 7 Carpet

## SPECIFICATIONS

Floorplan	Exterior Length	Exterior Height with A/C	Interior Height	Unloaded Vehicle Weight (lbs.)	Dry Hitch Weight (lbs.)	Gross Vehicle Weight Rating (lbs.)	Cargo Carrying Capacity (lbs.)	Fresh Water Capacity (gal.) (includes water heater)	Gray Waste Water Capacity (gal.)	Black Waste Water Capacity (gal.)
235FB	26' 9"	127"	81"	4,280	525	6,500	2,220	68.6	32.5	32.5
245DS	27' 6"	135"	81"	5,100	515	7,500	2,400	68.6	32.5	32.5
265RLS	30' 3"	136"	81"	6,050	645	8,250	2,200	68.6	32.5	32.5
266RKS	TBD	TBD	TBD	TBD	TBD	TBD	TBD	TBD	TBD	TBD
278BH	29' 4"	127"	81"	4,690	445	7,500	2,810	68.6	32.5	32.5
289BHS	31' 7"	138"	81"	6,305	710	8,500	2,195	68.6	32.5	32.5
305RKS	35' 8"	134"	81"	6,655	805	9,400	2,745	68.6	65	32.5
309BHL	33' 11"	134"	81"	6,595	750	9,250	2,655	68.6	32.5	32.5
315RKS	37' 9"	134"	81"	7,795	1,075	9,975	2,180	68.6	65	32.5
315RLSA	35' 8"	134"	81"	6,730	735	9,250	2,520	68.6	65	32.5
325RLSA	37' 9"	134"	81"	7,690	1,055	9,975	2,285	68.6	65	32.5
329BHU	35' 2"	134"	81"	7,680	770	9,950	2,270	68.6	32.5	32.5
336RESA	36' 2"	134"	81"	7,485	900	9,950	2,465	68.6	32.5	32.5
346RESA	38' 3"	134"	81"	8,255	1,255	10,500	2,245	68.6	32.5	32.5

**UNLOADED VEHICLE WEIGHT (UVW):** Sometimes referred to as "Dry Weight," UVW means the typical weight of this trailer as built at the factory. The UVW, as used in product literature and other promotional materials, does not include cargo, fresh water, propane, options or dealer-installed accessories. The weights of certain options and/or option packages are not included in the UVW listed above. **GROSS VEHICLE WEIGHT RATING (GVWR):** GVWR means the maximum permissible weight of the trailer, including the UVW plus passengers, personal items, all cargo, fluids, options, and dealer-installed accessories. The GVWR is equal to or greater than the sum of the UVW and the CCC. **CARGO CARRYING CAPACITY (CCC):** CCC

means the maximum weight of all passengers, personal items, food, fresh water, propane, tools, other cargo and dealer-installed accessories that can be carried by the trailer. CCC is equal to or less than GVWR minus UVW. The addition of options will decrease the CCC. **HITCH WEIGHT (HW):** The hitch weight, as used in product literature and other promotional materials, does not include cargo, fresh water, propane gas, options or dealer-installed accessories. The addition of these types of items will either add to or subtract from the stated hitch weight. It is important for your safety and enjoyment that your tow vehicle be adequately sized and equipped to tow and handle the GVWR of the RV you select. Review weights and rating

of your tow vehicle and consult a competent advisor for questions or advice. Whether you are new to RVing or a veteran, get a feel for the performance of your tow vehicle and the RV together before heading out on the roadways. When you tow an RV, you must drive differently than you do when driving a single vehicle. Practice hooking up, driving, backing up and braking in a safe environment or seek out professional instruction. Starcraft affixes a weight label to each RV which lists weight information for that vehicle. See specification chart above.



## SIMPLY THE BEST CONSTRUCTION

At Starcraft, we've built a strong reputation for making reliable, durable campers for almost 50 years. We use only the highest-quality materials and state-of-the-art production techniques. **It's this devotion to durability that has helped our company become a recognized manufacturer with a full lineup of affordable towables.**

In short, the last thing you have to worry about when you're camping is your camper.



### eco advantage™

The Starcraft EcoAdvantage is our company's commitment to protecting the environment. Scan this QR code with your smartphone to watch a video about our efforts and the impact we're making on our planet.



### DURABLE CONSTRUCTION

Autumn Ridge's firm foundation is built on 2" x 3" floor joists with 5/8" tongue-and-groove plywood with R-7 fiberglass insulation. The walls provide a long-lasting structure with 2" x 2" wooden studs on 16" centers, .024 aluminum exterior siding and R-7 fiberglass insulation. A one-piece seamless rubber roof membrane covers 4 1/2" arched trusses, 3/8" decking and R-7 fiberglass insulation, providing protection from the elements.



### EXTENDED CAMPING

Our optional Arctic Package extends your camping season and provides protection against frigid temperatures with its insulated, heated and enclosed underbelly. For additional protection, the optional full-foil wrap boosts your R-values to R-24 in the floor, R-19 in the walls and R-22 in the roof.



### Warranty

Each Starcraft is warranted to the original purchaser for twelve (12) months from the original date of purchase against defects in materials and workmanship. For a copy of the limited warranty with full terms and conditions, ask your local Starcraft dealer.



### Roadside Assistance

Travel worry-free with the complimentary Good Sam Roadside Assistance program, which gives you immediate access to dependable roadside assistance with a simple phone call.



### The Value of Your Local Starcraft Dealer

Establishing a solid relationship with your local Starcraft dealer is a key component in the enjoyment of your new Starcraft. By purchasing from a local dealer, you will have a convenient location for sales, parts and service support.

FOLLOW US ON



© Starcraft RV • 536 Michigan St., Topeka, IN 46571   
www.starcraftcamping.com

See dealer for further information and prices. All information in this brochure is the latest available at the time of publication approval. Starcraft reserves the right to make changes and to discontinue models without notice or obligation. Photos in this brochure may show optional equipment and props for photography purposes. RV's built for sale in Canada may differ to conform to Canadian codes.



CAMPING | pure and simple. STARCRAFT



[www.starcraftcamping.com](http://www.starcraftcamping.com)

VISIT OUR WEBSITE FOR MORE INFORMATION OR TO FIND A DEALER NEAR YOU.