

in Luxury and Fun

Relax in comfort in your private get-away. (Maple cabinets shown)

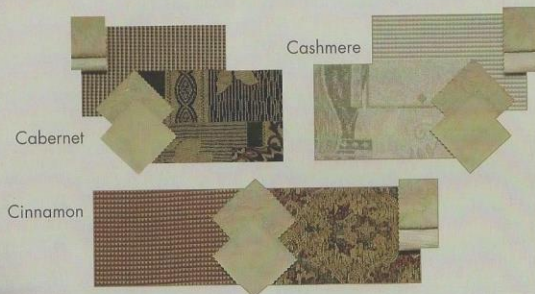

Décor



Exterior Features



Easy access to control center for quick hook-ups.



(3) 7,000 lb. axles with MOR/ryde ensure safe towing and good payload capacity.



The finished basement provides a large pass-through storage area.



The fuel station lets you gas up your toys, eliminating the need to haul bulky gas cans.

Standard Equipment

Interior

- Solid Wood Cabinets, Cathedral Style Doors (All Cabinets Pre-drilled and Screwed)
- Wood Choices: Maple or Cherry
- Corian® Countertops
- Day-Night Shades
- 12 Cu. Ft. Side-by-side Refrigerator with Stainless Steel Front
- Residential Stainless Steel Microwave
- Soft Touch Padded Ceiling
- Water Filter
- Concealed Residential Style Hinges
- Mirrored Entry Closet with Grandfather Clock
- Wired for Automatic Satellite System
- Overhead Ceiling Fan
- Skylight in Shower
- 27" Sony® TV
- Sony® Stackable Stereo with Full Surround Sound
- Sony® DVD Player
- Hide-a-bed Sofa
- Window Treatment with Swag Curtains
- Solid Wood Interior Assist Handle
- Waste Basket
- 22" Broiler Oven with Stainless Steel Front
- Electrical Command Center
- Speakers in Cargo Area
- Large Corner Shower with Sliding Glass Door
- 20" Flat Screen TV in Bedroom
- Large Closets with Dressing Mirrors
- 80" Pillow Top Mattress
- Plush Bedspread with Pillow Shams
- Fluorescent and Residential Lighting
- Free Standing Table with Leaf and 4 Chairs
- Porcelain Toilet with Sprayer
- Dirt Devil® Central Vac with Built-in Dust Pan
- Prep for A/C in Bedroom
- 42,000 BTU Furnace

Exterior

- All Aluminum Double Welded Cage Frame
- Gel Coat Fiberglass Exterior Walls
- Hi-Quality Painted Exterior Graphics
- Heavy Duty Aluminum Wheels
- Roof Ladder
- 18" Main Frame
- 4 Security Lights
- Power Eclipse Awning
- (2) 40 lb. LP Gas Bottles
- 88 Gal. Grey Tank
- 50 Gal. Black Tank
- 110 Gal. Fresh Water Tank
- Independent Power Front Jacks with Snap Pins
- (3) 7,000 lb. Axles
- MOR/ryde Suspension
- 12 Gal. Gas/Elec. DSI Water Heater
- 50 Amp Service (65 Amp Converter)
- Fold-out Entry Grab Handle
- 30" Entry Door
- Satellite Prep
- 5/8" Tongue and Groove Plywood Floor
- Black Tank Flush System
- Enclosed Underbelly
- Heated Holding Tanks
- Tinted Windows with Safety Glass
- Exterior Shower
- Exterior Water Hook-up Center
- Convenient ODS Light and Porch Light
- Low Profile Ducted 15K Air Conditioner
- Spare Tire and Hoist
- Rear Power Stabilizer Jacks
- Entry Step Light
- Extended Pin Box

Mandatory Sportster Package

- Fuel Cell with Pump Station
- Generator Prep
- 2nd Entrance Door in Cargo Area
- Tuff-Ply on Cargo Floor
- 2" Diamond Plate on Sidewalls
- Ramp Extension
- Threshold Ramp
- 3 Tie Down Rails
- Pull Down Screen Wall
- Battery Charger/Power Pack/Air Compressor

Additional Options

- Fireplace N/A in 37CKS)
- 2nd 13.5 A/C in Bedroom
- 3rd 13.5 A/C in Cargo Area
- Heat Pump Upgrade
- Convection Microwave
- Ice Maker with Water Dispenser in Door
- King Size Bed
- Bedroom Loft
- Infinity Ceiling Light
- CSA
- Onan 5.5 Generator
- Disc Brakes with Neo-R Lube Hubs
- Thermopane Windows
- Automatic Satellite
- 5th Airborne Hitch
- Slide Out Covers
- Wind Sensor
- Roll Out Tray
- 2nd Battery



Floor Plans & Specifications

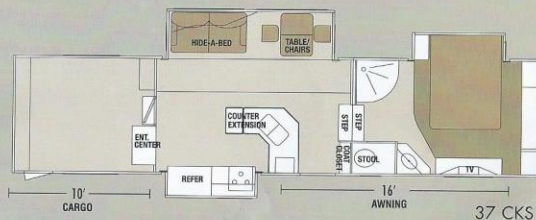

Escalade Sportster	37 CKS	41 CKS	41 SKS
UVW (Unloaded Vehicle Weight)	14175	14720	14960
Dry Hitch Weight	3200	3100	3695
Dry Axle Weight	10975	11600	11265
NCC (Net Carrier Capacity)	5825	5280	5040
GVWR	20000	20000	20000
Interior Height	96"	96"	96"
Exterior Width	102"	102"	102"
Exterior Length	39'	42'	42' 8"
Exterior Height	155"	155"	155"
Fresh Water Capacity (gal)	110	110	110
Waste Water Capacity (gal)	50	50	50
Grey Water Capacity (gal)	88	88	88
Water Heater Capacity (gal - G/E w/DSI)	12	12	12
LP Gas Capacity (lbs.)	80	80	80
Furnace BTUs	42000	42000	42000
Tire Size (G-Rated)	LT235-85R16	LT235-85R16	LT235-85R16
Axle Rating	3 (7000)	3 (7000)	3 (7000)

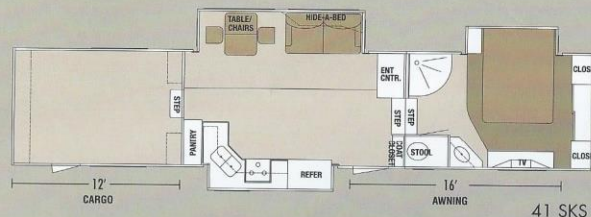
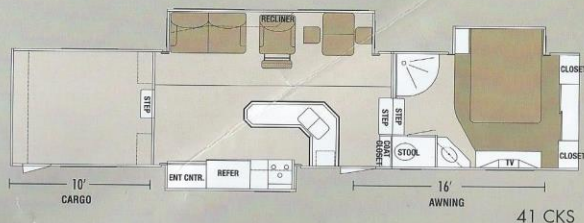

9270 West U.S. 20 | Shipshewana, IN | 46565
Ph: 260-768-4016 | www.kz-rv.com

Mid-State Campers
Dealer
10400 Recreational Dr.
Black Hawk, SD 57718
605-787-7453



Due to continual research and advances, manufacturer reserves the right to change specifications, design, price and equipment without notice, and assumes no responsibility for any error in this literature. Some items shown are not included as standard or optional equipment. 2006 K-Z

K-100-276