

For Sale 2008 Itasca Navion 24H \$65K

Diesel, Dodge Sprinter engine, great condition, only 12k miles, \$96k new list price

Mercedes 3.0L 6Cyl 154HP Diesel Engine, Dodge Sprinter Chassis, 5-Speed Automatic Trans w/TIP Shift, 3500LB Trailer Hitch, 26.4 Gal Fuel Capacity, Cab AM/FM/CD Stereo, Coach AM/FM Stereo, Dinette w/interior & exterior access to storage, Pantry, Microwave/Convection Oven, 3 Burner Range w/Hood, Lg. Dbl Door Fridge/Freezer, Stainless Sink w/wood sink cover, 13,500BTU A/C, 25,000BTU Furnace, 30 AMP Pwr Cord, Holding Tank Monitor Sys, 34 Gal Fresh Water w/Heater, 33/27 Black/Gray water, 18 Gal LP Tank, Much More!

See invoice and flyer for more info





THIS LABEL IS NOT REQUIRED BY LAW, HOWEVER, WINNEBAGO INDUSTRIES INC. AND LICHTSINN MOTORS, INC.

BELIEVE YOU HAVE A RIGHT TO BE INFORMED OF FAIR PRICING LEVELS TO HELP YOU READILY COMPARE THE RELATIVE VALUE OF RECREATIONAL VEHICLES YOU MAY BE CONSIDERING

VEHICLE DESCRIPTION	DIMENSIONS	CAPACITIES
MAKE: ITASCA NAVION MODEL: 2008 ID524H SERIAL NUMBER: 70537J238498 CHASSIS VIN: WDXPF445879343535	EXTERIOR LENGTH: 24'6" EXTERIOR WIDTH: 90" EXTERIOR HEIGHT: 10'11" <small>Note: Exterior height of vehicle is measured to the highest standard feature on the roof and will vary due to chassis variance, option selection, fluids, and other loading factors.</small>	FUEL: 26 GAL FRESHWATER: 34 GAL HOLDING TANK - BLACK: 33 GAL HOLDING TANK - GRAY: 27 GAL LPG (FILLABLE TO 80%): 18 GAL <small>Note: Capacities are estimates based on calculations and represent approximate numbers. Capacities may vary based on fabrication and installation of tanks and compartments.</small>

STANDARD EQUIPMENT AT NO EXTRA CHARGE
(Unless Replaced By Optional Equipment)

AUTOMOTIVE	
FOG & DAYTIME RUNNING LIGHTS	NC
MUD FLAPS - FRONT & REAR	NC
SPARE TIRE & TIRE TOOLS	NC
TRAILER HITCH W/3,500 LB. DRAW BAR	NC
WHEEL COVERS	NC
CAB	
AUTOMOTIVE HEATER & AIR CONDITIONER	NC
AUXILIARY START CIRCUIT	NC
CAB CARPET - REMOVABLE	NC
CRUISE CONTROL	NC
POWER ASSIST STEERING	NC
SEATS-ADJUSTABLE SLIDE/RECLINE	NC
SEAT BELTS-3 POINT SHOULDER & LAP	NC
EXTERIOR	
AWNING RAILS RH SIDE	NC
LADDER	NC
MIRRORS-ELECTRIC REMOTE W/DEFROST	NC
ROOF-CURVED W/FIBERGLASS SKIN	NC
INTERIOR	
SLIDEOUT ROOM - SOFA/BED	NC
CEILING MATERIAL-TEXTURED FABRIC	NC
DINETTE W/STORAGE BELOW	NC
MICROWAVE/CONVECTION TOUCH CONTROL	NC
RANGETOP-3 BURNER W/STORAGE DRAWER	NC
RANGE HOOD-LIGHT/FAN-STAINLESS STEE	NC
REFRIGERATOR/FREEZER DOUBLE DOOR	NC
SILVERWARE TRAY	NC
SINK-GALLEY, SINGLE-STAINLESS STEEL	NC
SHOWER W/ABS SURROUND & SKYLIGHT	NC
SOFA/BED	NC
TOILET W/FOOT PEDAL & SPRAYER	NC
VINYL FLOOR IN GALLEY, BATH & ENTRY	NC
WARDROBE CABINET W/WOOD DOOR	NC
SYSTEMS	
A/C ROOF-MOUNT, 13,500 BTU DUCTED	NC
BATTERIES(2)-DEEP CYCLE,MARINE/RV	NC
BATTERY DISCONNECT SYSTEM, COACH	NC
CITY WATER HOOK-UP	NC
ELECTRICAL SYSTEM-30 AMP	NC
CONVERTER/CHARGER-45 AMP	
FURNACE-25K BTU DUCTED, LOW PROFILE	NC
GENERATOR PREP	NC
LP TANK-PERMANENT MOUNT W/GAUGE	NC
ROOF VENT-POWER IN BATH	NC
SEWER HOSE	NC
TV ANTENNA W/CABLE INPUT	NC
TV SATELLITE SYSTEM PREP IN ROOF	NC
WATER HEATER-6 GAL. ELEC. IGNITION	NC
WATER PUMP-DEMAND	NC
WATER SYSTEM WINTERIZATION PACKAGE	NC
SAFETY	
APPLIANCE TIE DOWNS	NC
CARBON MONOXIDE/LPG DETECTOR/ALARM	NC
FIRE EXTINGUISHER - 10BC	NC
GFI	NC
SMOKE DETECTOR/ALARM	NC

MANUFACTURER'S SUGGESTED RETAIL BASE PRICE	\$ 88,893
*** OTHER FEATURES INCLUDE ***	NO CHARGE

DODGE SPRINTER CHASSIS	NC
AIRBAGS, DRIVER & PASSENGER	NC
POWER WINDOWS & DOOR LOCKS (CAB)	NC
RADIO-AM/FM STEREO/CD	NC
UNIQUE EXTERIOR STYLING	NC
CONTOURED STYLE CABINetry	NC
SKYLIGHT-LOUNGE W/SCREEN & SHADE	NC
STEREO SYS-AM/FM RADIO,CD/DVD PLAYE	NC
TV-12VOLT LCD	NC

OPTIONS INSTALLED BY MANUFACTURER	RETAIL
W11 RHUBARB/RASPBERRY/W MAPLE	NC
091 CAB SEATS-ULTRALEATHER	490
23T DRAINAGE SYSTEM-HEATED	259
29B WATER PURIFIER	91
29P AC HEAT PUMP-HI EFF. LOW PFL	273
48E POWER VENTILATOR-BATH	98
52F AWNING-PATIO	665
52G GEN-3.6KW ONAN LP MICROQUIET	3,073
53B WTR HTR-6GAL ELECTRIC/LP GAS	154
64R EXTERIOR WASH STATION	91
70C RADIO - SATELLITE	280
74J REARVIEW MONITOR SYS W/AUDIO	875
92K PEWTER W/WINE/DKRED/ELEC RED	NC

TOTAL OPTIONS	\$ 6,349
DELIVERY & HANDLING CHARGE	860
TOTAL BASE, OPTIONS, & DELIVERY CHARGE	\$ 96,102

Manufacturer's Suggested Retail Price Does Not Include State and Local Taxes, Dealer Prep and/or Options Installed by the Dealer. Winnebago Industries, Inc. Reserves the Right to Change Prices and Specifications Without Notice.

NOTES:
CSA SPECS MAY VARY

08 NAVION SPECIFICATIONS

WEIGHTS & MEASURES	24B	24H	24J
Length	24'6"	24'6"	24'6"
Exterior Height ¹	10'11"	10'11"	10'11"
Exterior Width	7'6"	7'6"	7'6"
Exterior Storage ² (cu. ft.)	37.9	17.8	25.3
Awning Length	10'	12'6"	10'
Interior Height	6'8"	6'8"	6'8"
Interior Width	7'3"	7'3"	7'3"
Freshwater Capacity w/Heater ³ (gal.)	33	34	34
Holding Tank Capacity - Black/Gray ³ (gal.)	30 / 27	33 / 27	31 / 38
LP Capacity ⁴ (gal.)	18	18	18
Fuel Capacity (gal.)	26.4	26.4	26.4
GCWR ⁵ (lbs.)	14,530	14,530	14,530
GVWR (lbs.)	11,030	11,030	11,030
GAWR - Front (lbs.)	4,410	4,410	4,410
GAWR - Rear (lbs.)	7,720	7,720	7,720
Wheelbase	170"	170"	170"

AUTOMOTIVE/CHASSIS	24B	24H	24J
Dodge® Sprinter Chassis, Turbo-Diesel – w/Adaptive ESP® technology 3.0L CDI 6-cylinder, 154-hp, automatic 5-speed transmission w/tip shift, 4-wheel ABS, independent front suspension, 180-amp. alternator, Trailer Hitch ³ 3,500-lb. drawbar/350 lbs. maximum vertical tongue weight & 6-pin wiring connector, Wheelcovers 16" (4)	\$	\$	\$
Dodge Sprinter Chassis, Gas – w/Adaptive ESP technology 3.5L V6, 254-hp, automatic 5-speed transmission w/tip shift, 4-wheel ABS, independent front suspension, 180-amp. alternator, Trailer Hitch ³ 3,500-lb. drawbar/350 lbs. maximum vertical tongue weight & 6-pin wiring connector, Wheelcovers 16" (4)	0	0	0

CAB AREA & DRIVER CONVENIENCES	24B	24H	24J
Beverage Holders, Cab Seats (Fabric) armrest, adjustable lumbar support, adjustable headrest, multiadjustable slide/recline, Cruise Control, Curtain cab divider, Document Clip, Glove Box ventilated, Power Cab Windows, Power Door Locks w/remote control, driver/passenger/main entry, Powerpoint 12-volt DC/cigarette lighter, Powerpoint 12-volt DC, Steering Wheel tilt & telescoping, Sunvisors, Trim Panels driver & passenger doors, Windshield Wipers intermittent	\$	\$	\$
Cab Seats UltraLeather™ Monitor System rearview w/single camera, 1-way audio	0	0	0

ENTERTAINMENT	24B	24H	24J
Radio (Cab) AM/FM stereo, CD player, MP3 interface & iPod dock, remote, speakers (2) cab & (2) coach, subwoofer, Sony® Radio Power Switch main/auxiliary battery, Satellite System Ready, TV Antenna (Amplified) interior jack, coax wiring, cable input	\$	\$	\$
Stereo System (Coach) AM/FM stereo radio, alarm clock, CD/DVD player, input jack, TV 19" LCD stereo w/remote	\$	\$	\$
Satellite Radio Receiver includes 6-month paid Sirius® subscription	0	0	0

INTERIOR	24B	24H	24J
Bunk front overhead w/hinged mattress, gas struts, bunk ladder, privacy curtain, windows, light, Ceiling fabric, Countertops laminate, Lights halogen, Lights ceiling, incandescent w/wall switches, Light stepwell, Mini Blinds bath, Skylight w/bar handle, sliding screen, sliding pleated shade, Shades day/night pleated (lounge, dinette & galley)	\$	\$	\$
Cabinet front overhead storage w/accent lights	0	0	0

FURNITURE	24B	24H	24J
Dinette w/interior & exterior access to storage below front seat	\$		
Dinette w/interior access to storage below both seats		\$	
Dinette	0		
Sofa w/access to storage below (NA 24B), throw pillow	\$	\$	
Sofa w/table & access to storage below, throw pillow			0

GALLEY	24B	24H	24J
Faucet dual-control, Microwave/Convection Oven, Range Top 3-burner, Range Hood vented w/light & fan, Receptacle AC duplex, Refrigerator/Freezer large double-door (single-door on 24B), Norcold®, Sink round, single-bowl, stainless steel, w/wood sink cover	\$	\$	\$
Countertop Extension pullout		\$	
Pantry		\$	
Water Filtration System	0	0	0

BATH	24B	24H	24J
Cabinet lavatory, Cabinet medicine, Faucet (Lavatory) dual-control, Faucet (Shower) dual-control w/flexible showerhead, Light shower, Roof Vent powered, Shower Door retractable, Sink round, stainless steel, Skylight	\$	\$	\$
Roof Vent powered ventilator fan	0	0	0

BEDROOM	24B	24H	24J
Bed angle-split mattress, pillows, pillow shams, interior & exterior access to storage below			\$
Bunk Beds (2) w/mattresses, privacy curtains, storage pockets	\$		

EXTERIOR	24B	24H	24J
Awning Rail w/rain gutter, Bumpers front & rear, Door entrance w/ separate screen door, deadbolt lock, remote keyless entry, Entrance Door Steps double, electric w/doorjamb switch, Ladder, Light porch w/interior switch, Mirrors electric remote w/defrost, convex, surface-mounted turn signals, extended arms, Mudflaps front & rear, Pullout Storage Drawer w/sealed lid, Receptacle AC duplex, Sidewall Skin 1-piece, smooth, Steps cab, Storage Compartments w/bottom trunk liner, Windows tinted	\$	\$	\$
Awning patio, manual	0	0	0

SYSTEMS	24B	24H	24J
HEATING & A/C - Automotive Heater/Air Conditioner single climate control, Air Conditioner (Roof) 13,500 BTU, ceiling-ducted w/wall thermostat, Furnace 25,000 BTU (24H & 24J ducted in floor, 24B ducted above floor)	\$	\$	\$
A/C Heat Pump	0	0	0
ELECTRICAL - Auxiliary Start Circuit, Batteries (Coach) (2) Group 24 deep-cycle, Battery (Coach) Disconnect System, Dual Battery charge control (automatic), Electrical Distribution System AC breaker panel, DC automotive-style fuses, 45-amp. converter/charger, Generator Prep Kit, Monitor Panel battery condition gauge, generator hourmeter gauge, generator start/stop switch, holding tank levels, LP tank level, water heater lights, water heater switch, water pump switch, water tank level, Power Cord 30-amp., Service Center (Electrical) cable TV input, power cord, portable satellite dish hookup, QuickPort® service connection hatch (NA 24J)	\$	\$	\$
Generator 3,200-watt Cummins Onan® Quiet Diesel™ (NA gas chassis, NA gas & LP generators), Generator 3,600-watt Cummins Onan MicroQuiet™, LP (requires diesel engine), Generator 4,000-watt Cummins Onan MicroQuiet, gas (requires gas engine)	0	0	0
PLUMBING - Drain water tank, 1", Service Compartment (Drainage/Water) w/colored labels, city water hookup/tank diverter fill, drainage valve, 10' sewer hose, Tank LP , permanent mount w/gauge, TrueLevel™ Holding Tank Monitoring System, Water Heater 6-gallon electronic ignition, LP gas, Water System Winterization Package water heater bypass valve & siphon tube, Water Pump demand	\$	\$	\$
Drainage System heated, electric, Exterior Wash Station w/lighted pump switch, Water Heater 6-gallon electronic ignition, 120 VAC/LP Gas	0	0	0

SAFETY	24B	24H	24J
Airbags driver & passenger, Assist Bar interior, Detectors/Alarms LP leak, smoke, carbon monoxide, Fire Extinguisher 10 BC, Ground Fault Interrupter, Lamps daytime running, fog, Lights rear, high-mount brakelamps, Seat Belts cab, 3-point, Seat Belts lap (in selected areas), Window escape	\$	\$	\$
Child Seat Tether Anchor dinette			\$

WARRANTY ⁶	24B	24H	24J
12-month/15,000-mile basic warranty; 36-month/36,000-mile limited warranty on structure; 10-year limited parts & labor warranty on roof skin⁷	\$	\$	\$

- The height of each model is measured to the top of the tallest standard feature and is based on the curb weight of a typically equipped unit. The actual height of your vehicle may vary by several inches depending on chassis or equipment variations. Please contact your dealer for further information.
 - The load capacity of your motor home is designated by weight, not by volume, so you cannot necessarily use all available space when loading your motor home.
 - Capacities are based on measurements prior to tank installation. Slight capacity variations can result due to installation applications.
 - Capacities shown are tank manufacturer's listed water capacity (W.C.). Actual filled LP capacity is 80% of listing due to overfilling prevention device on tank.
 - Actual towing capacity is dependent on your particular loading and towing circumstances which includes the GVWR, GAWR, and GCWR as well as adequate trailer brakes. Please refer to the Operator's Manual of your vehicle for further towing information.
 - See separate chassis warranty.
 - See your dealer for complete warranty information.
- NA Not Available
 \$ Standard
 0 Optional
- Not all items available in combination. See dealer for details.
- Winnebago Industries® continuing program of product improvement makes specifications, equipment, model availability, and prices subject to change without notice. Comparisons to other motor homes are based on the most recent information available at printing.

08 NAVION FLOORPLANS

Carpet
 Vinyl Floorcovering
 Seat Belts

 Note: Dimensions shown are for sleeping space only and may vary due to styling differences. Dashed lines denote overhead storage areas.

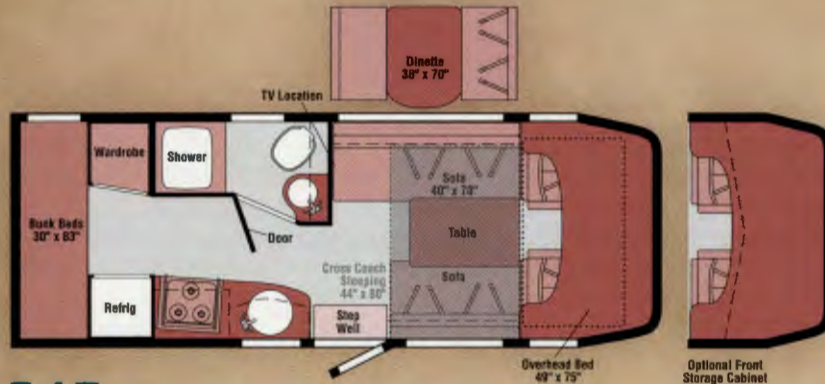

24B

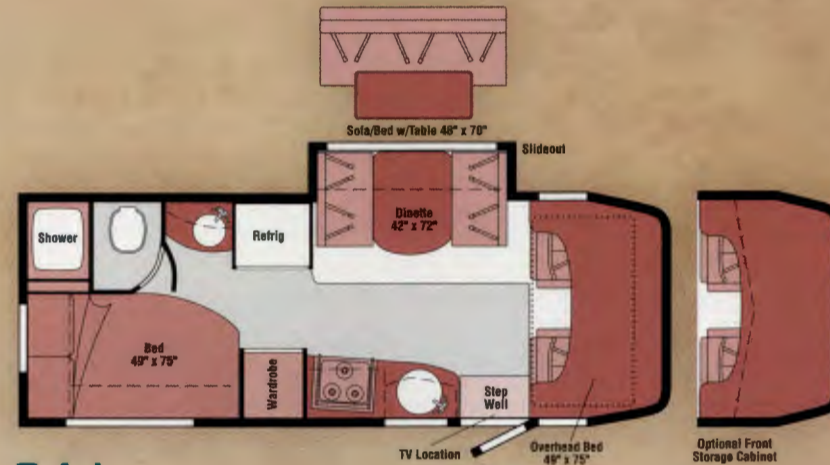

24J

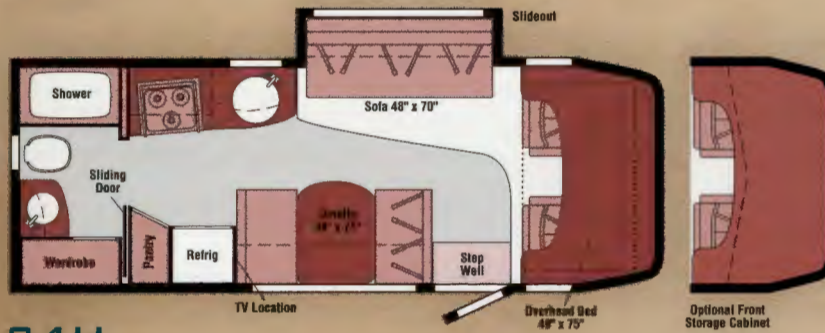

24H



RUNNING BOARDS Stylish steps make entering the cab easy and help keep your Navion clean.



WEB TRUELEVEL Eliminate tank-level guesswork with our exclusive TrueLevel™ holding tank monitoring system. It incorporates detector cells that determine liquid levels from outside the tank. No probes means no more corrosion, just accurate readings, time after time.



EXTERIOR SERVICE CENTERS
The exterior service centers house water, drainage facilities and the available exterior wash station. Electrical hookups can also be found here, including a power cord with the QuickPort™ service connection hatch (Not available on 24J shown here). This hatch allows you to close the compartment door even when connected to hookups at the campground.